



3 YEW TREE PLACE,
BRENTY, BS10 6FH

GOODMAN
& LILLEY



A SUPERBLY APPOINTED THREE BEDROOM HOME BUILT ONLY 7 YEARS OLD LOCATED CLOSE TO LOCAL SHOPS, BUS ROUTES WITH GREAT ACCESS TO M4/M5 MOTORWAYS AND CRIBBS CAUSEWAY JUST 1.2 MILES AWAY ALSO MAKING IT IDEAL FOR COMMUTING IN AND OUT OF BRISTOL. .

Accommodation

Please see the floorplan for room measurements.

Ground Floor

The ground floor offers an entrance hallway with stairs to the first floor has doors to a downstairs cloakroom/WC, a generous kitchen with fitted quality AEG appliance and a dining area. From the kitchen / dining room there are doors into the sitting room to the rear of the property with further bi - folding doors out to the attractive rear garden. The large doors make you feel that you are truly connected to the outside.

First Floor

On the first floor you have 3 bedrooms and a family bathroom with the main bedroom having an en-suite shower room.

Outside

Gardens

The wonderful rear garden comprises of lawn, patio and decked areas, ideal for outside dining and there is a patio to the side as well, that providing access to a generous sized shed.

Allocated Parking

The house comes with allocated parking to the front of the property

-
- Wonderfully Appointed Modern Home
 - En Suite to Master Bedroom
 - Downstairs WC
- Three Bedrooms
 - Modern Fitted Kitchen
 - Gardens and Parking



ASKING PRICE £400,000



Ground Floor

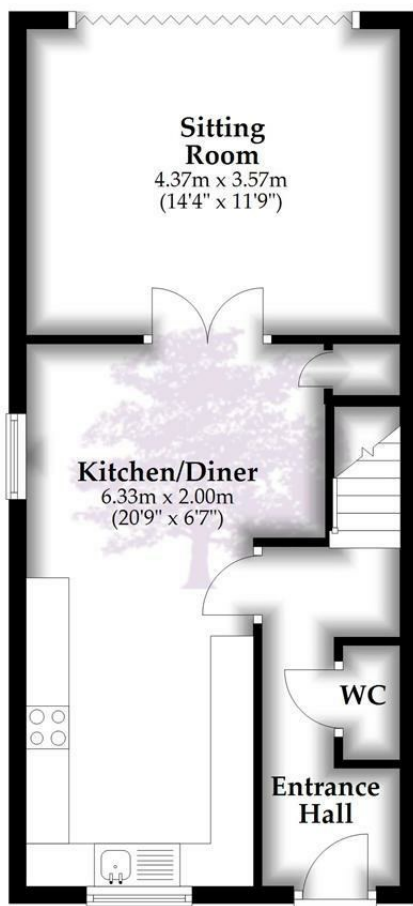

First Floor

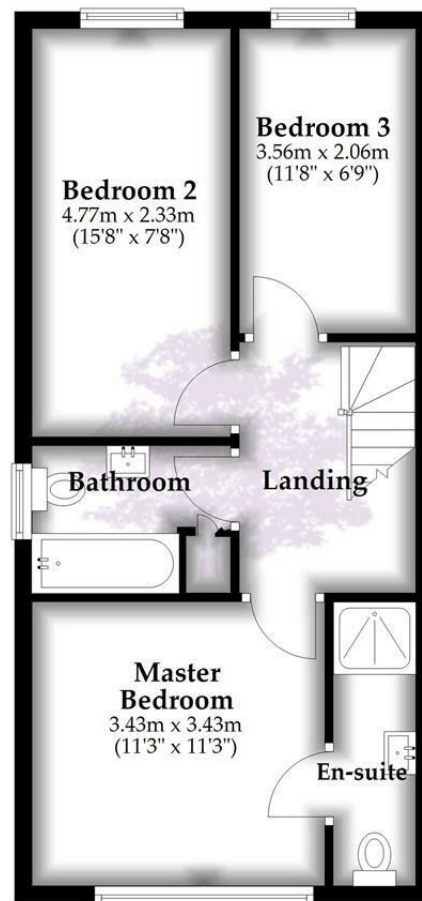

Total area: approx. 83.3 sq. metres (896.9 sq. feet)

Whilst every attempt has been made to ensure accuracy of the floor plan all measurements are approximate and no responsibility is taken for any error, omission or measurement.

Plan produced using PlanUp.

HENLEAZE - 0117 2130777
henleaze@goodmanlilley.co.uk

PORTISHEAD - 01275 430440
sales@goodmanlilley.co.uk

SHIREHAMPTON - 0117 2130333
shire@goodmanlilley.co.uk

Zoopa.co.uk

rightmove



WWW.GOODMANLILLEY.CO.UK

These particulars are for general guidance only. They do not form or constitute any part of an offer or contract. Goodman & Lilley has not carried out structural surveys of the property. The services, appliances or specific fittings mentioned in these details have not been tested. Every attempt is made to ensure accuracy, however all photographs, measurements, floor plans and distances are for illustrative purposes only. They must not be relied upon when purchasing carpets and or other fixtures & fittings. Lease details, service charges and ground rents are given as a guide only. They should be checked and confirmed by a licensed solicitor prior to exchange of contracts. The copyright of all details, photographs and floor plans remain exclusive to Goodman & Lilley.