



HOWECROFT COURT EASTMEAD LANE,  
STOKE BISHOP, BS9 1HJ

---

GOODMAN  
& LILLEY



LOCATED IN A SOUGHT AFTER STOKE BISHOP POSITION AND BENEFITTING FROM WONDERFUL WESTERLY FACING VIEWS, A GARAGE, COMMUNAL GARDENS AND PARKING IS THIS WONDERFUL PURPOSE BUILT TWO DOUBLE BEDROOMED APARTMENT.

### Location

Located in the tranquil and leafy suburb of Stoke Bishop, in close distance of the renowned Durdham Downs and within a short walk of Stoke Hill shops and to Whiteladies Road and Bristol City Centre beyond.

### Accommodation

Please see the floorplan for room measurements.

### Communal Entrance

Via a communal entrance door to a communal hallway with stairs to the entrance door.

### Entrance Lobby

With access to the main hallway.

### Entrance Hall

With doors to:

### Living / Dining Room

A good size room with double glazed windows to the rear aspect with wonderful views over Stoke Bishop towards Blaise Castle, door to the kitchen.

### Kitchen

A well appointed kitchen with wall and base units, work surfacing over, sink unit, integrated cooking appliances, spaces and plumbing for white goods, built in airing/storage cupboard and double glazed windows again with wonderful roof top rear views across Stoke Bishop.

### Bedroom One

Double glazed windows to the front aspect and built in wardrobes.

### Bedroom Two

Double glazed windows to the front aspect.

### Bathroom

Fitted three piece white suite with shower fitted over the bath and built in mirrored storage.

### Outside

### Communal Gardens

Well tended communal gardens to the front and rear of the property.

### Garage / Parking

There is a single garage situated in a block to the rear of the property and visitor parking.

### Further Information

- \*No chain
- \*Roof replaced 18 months ago by management company
- \*Hillcrest Estate Management
- \*Management Fee is £2100 per annum
- \*999 Year Lease from June 1981
- \*Rental valuation for two professional sharers £1500 per month

- 
- Well Appointed Two Bedroom Apartment
  - Popular Bristol Location
  - Garage and Parking
  - No Chain
  - Communal Gardens
  - Superb Views



GUIDE PRICE £275,000



## Floor Plan

Approx. 57.2 sq. metres (616.2 sq. feet)

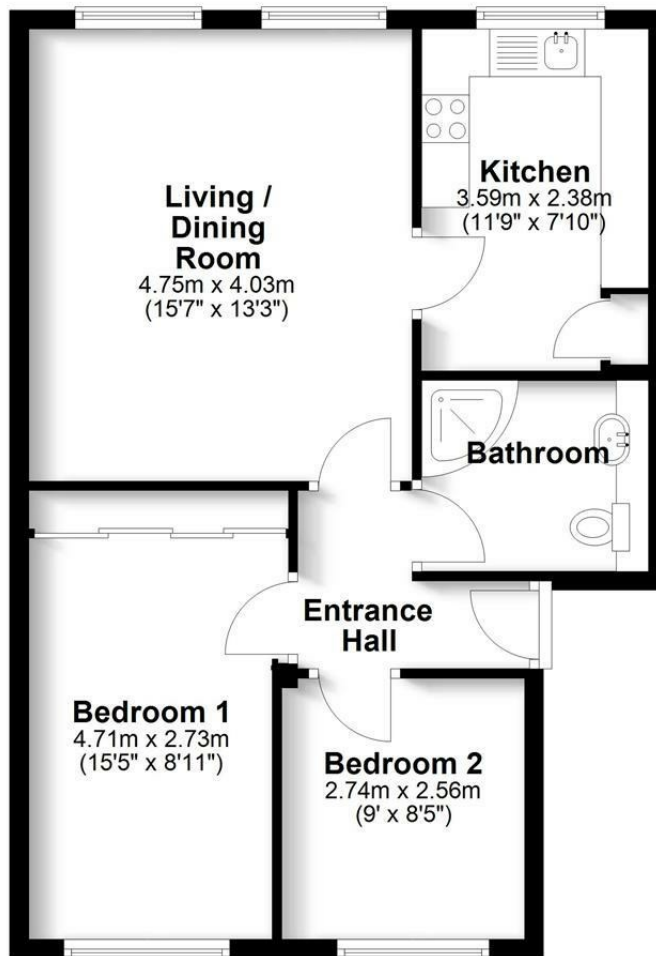

Total area: approx. 57.2 sq. metres (616.2 sq. feet)

**HENLEAZE** - 0117 2130777  
henleaze@goodmanlilley.co.uk

**PORTISHEAD** - 01275 430440  
sales@goodmanlilley.co.uk

**SHIREHAMPTON** - 0117 2130333  
shire@goodmanlilley.co.uk

Zoopla.co.uk

rightmove



[WWW.GOODMANLILLEY.CO.UK](http://WWW.GOODMANLILLEY.CO.UK)

These particulars are for general guidance only. They do not form or constitute any part of an offer or contract. Goodman & Lilley has not carried out structural surveys of the property. The services, appliances or specific fittings mentioned in these details have not been tested. Every attempt is made to ensure accuracy, however all photographs, measurements, floor plans and distances are for illustrative purposes only. They must not be relied upon when purchasing carpets and or other fixtures & fittings. Lease details, service charges and ground rents are given as a guide only. They should be checked and confirmed by a licensed solicitor prior to exchange of contracts. The copyright of all details, photographs and floor plans remain exclusive to Goodman & Lilley.