

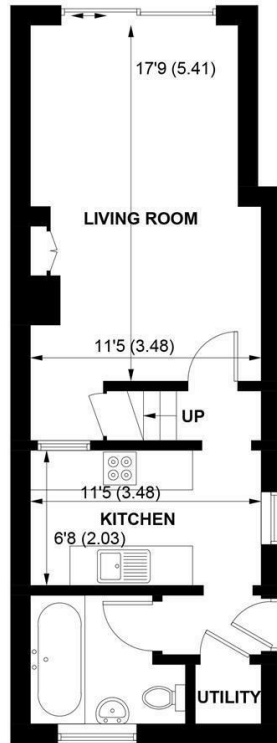

3 KNIGHTS COTTAGES, DOWN STREET, WEST ASHLING, CHICHESTER, WEST SUSSEX, PO18 8DS

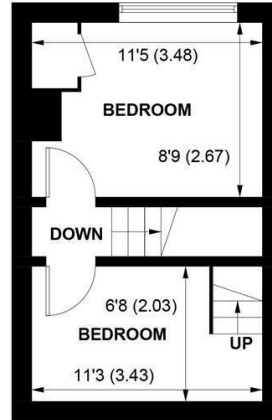

GROUND FLOOR



FIRST FLOOR

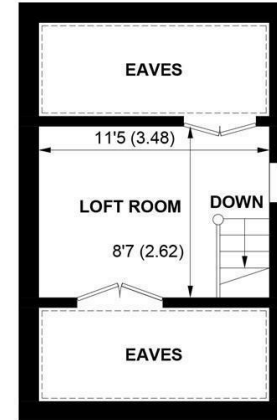

SECOND FLOOR

APPROXIMATE GROSS INTERNAL AREA = 708 SQ FT / 65.8 SQ M

NOT TO SCALE (For illustrative purposes only as defined by RICS Code of Measuring Practice) 2022 ©
Produced for Sims Williams

£395,000 Freehold

3 KNIGHTS COTTAGES, DOWN STREET,
WEST ASHLING CHICHESTER,
WEST SUSSEX, PO18 8DS

- No Onward Chain
- Charming Cottage
- Semi-Rural Village Location
- Stylish Fitted Kitchen
- Spacious Sitting/Dining Room
- Downstairs Cloakroom
- 2 Bedrooms & Loft Space
- Modern Bathroom Suite
- Garden & Parking

EPC RATING

Current = D
Potential = B

COUNCIL TAX BAND

Band = B

A charming cottage located in a secluded position within the picturesque semi-rural village of West Ashling.

The property is offered for sale with no onward chain and the well-appointed accommodation briefly comprises entrance lobby with doors to a utility cupboard and the downstairs bathroom, which is fitted with a modern white suite consisting of bath with shower over, wash basin and WC.

The galley kitchen is fitted with a range of stylish units with work surfaces and integrated appliances. The good-sized sitting/dining room has a fireplace with log burner and patio doors open onto the rear garden.

To the first floor there are 2 bedrooms, both with storage. A further staircase leads to a handy loft space with window and eaves storage.

Outside there is an off-road parking space to the front. The secluded rear garden is mainly to lawn with established planting.

Disclaimer...

As the seller's agent we are not surveyors or conveyancing experts and as such we cannot and do not comment on the condition of the property or issues that may affect this property, unless we have been made aware of such matters. Interested parties should employ their own professionals to make such enquiries before making any transactional decisions.

Directions...

From Chichester take the Funtington Road (B2146). Proceed through the village of East Ashling and when you have left the village, take the first left into Southbrook Road. At the junction with Down Street, bear right and then left into Heather Close. Continue round towards the end and you will see the no through lane to the cottage on the right hand side.

