



297 Uppingham Road, Humberstone, Leicester
LE5 4DG | info@kingsestateuk.com

0116 352 7012

 **3**
Bedrooms

 **1**
Bathroom



Kings are pleased to market this 3 Bed Mid-Terrace in the highly desirable area of Humberstone, LE5. Call Kings on 0116 352 7012 to

view.

297 Uppingham Road, Humberstone, Leicester
LE5 4DG | info@kingsestateuk.com

0116 352 7012

Kings are pleased to market this 3 Bed Mid-Terrace in the highly desirable area of Humberstone, LE5. The property has 2 Reception Rooms, Fitted Kitchen, 3 Bedrooms, Bathroom, Garden to the Rear. Close to places of Worships including Darul Arqam Educational Trust, Schools including Humberstone Infant Academy/Falcons Primary School/Northfield House Primary Academy/Keyham Lodge School. Local amenities including small convenient stores and nearby Tesco Superstore. Must be viewed to fully appreciate, call Kings on 0116 352 7012 to view.

Ground Floor

Approx. 43.8 sq. metres (471.3 sq. feet)

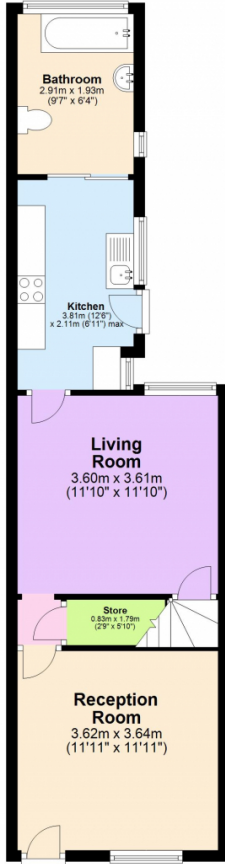

First Floor

Approx. 38.6 sq. metres (415.6 sq. feet)

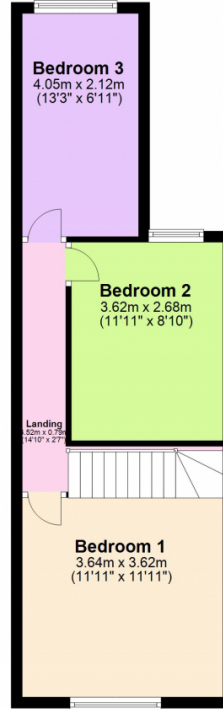

Total area: approx. 82.4 sq. metres (886.9 sq. feet)



Coming soon



