



Monterey Court, Humberstone, Leicester

Monterey Court, Humberstone, LE5

Offers over £485,000

Stunning five bedroom detached home on Monterey Court in Humberstone, Leicester. Accommodation is presented immaculately over three floors offering two reception rooms, kitchen, utility, five bedrooms and three bathrooms, making for the perfect family home. Monterey Court is located nearby amenities, schools and road links.



Property Features

1. Off-road Parking
2. Garden

Full Description

Kings are delighted to offer for sale this excellent five bedroom detached family home on Monterey Court in Humberstone, Leicester. Enter the private gated area of Monterey Court to find the property located at the end of the cul-de-sac and set back from the road with off-street parking to the front and a single garage, and you can enter the home to be greeted by an entrance hall leading to a bay-fronted living room to the front, contemporary fitted kitchen with integrated appliances, a dining room to the rear with patio doors leading out to a rear garden with patio and turf. Downstairs also offers a utility room and a WC. Make your way up to the first floor and you will find four double bedrooms with dressing area and en-suite to bedroom one, then on the second floor is another bedroom with dressing area and en-suite. Monterey Court is conveniently located off Pine Tree Avenue close to local amenities, schools and road and transport links. Call Kings to arrange a viewing.









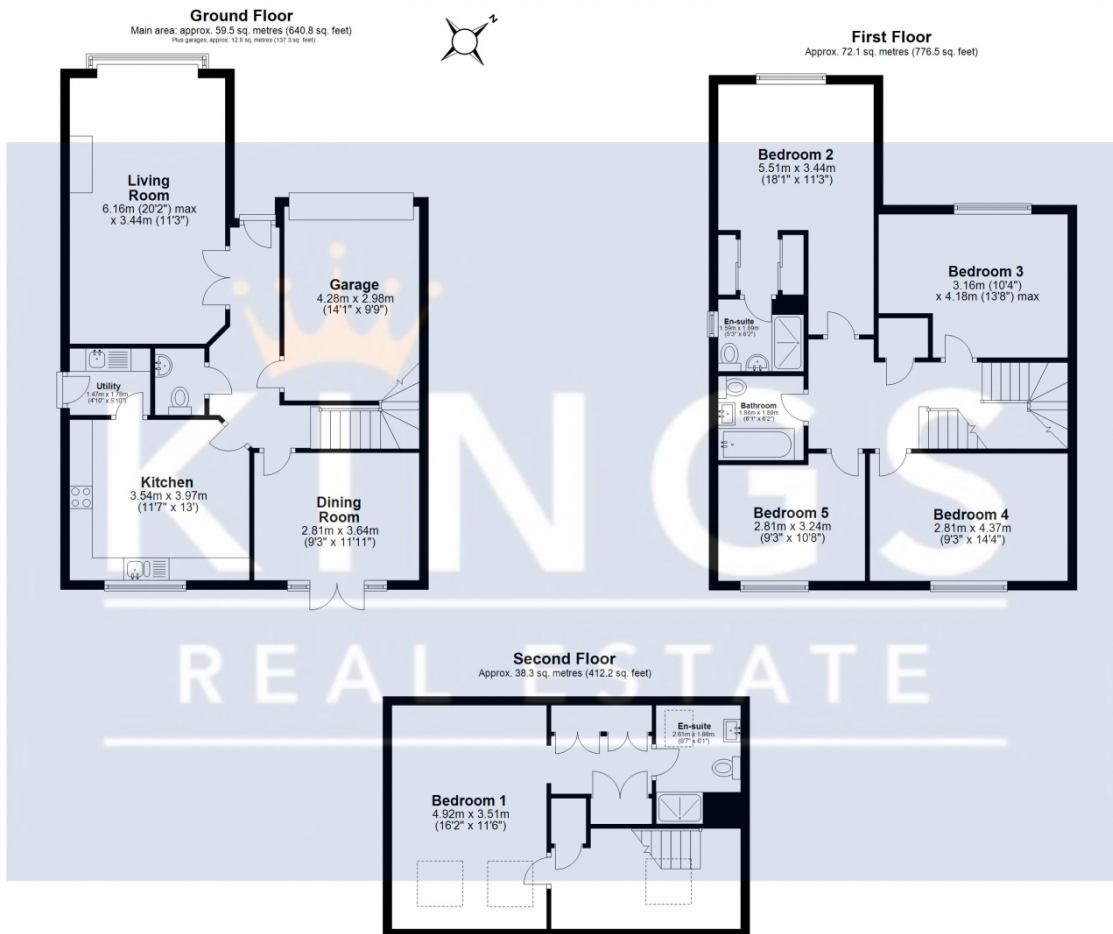

Floor Plan measurements are approximate and are for illustrative purposes only. While we do not doubt the floor plans accuracy, we make no guarantee, warranty or representation as to the accuracy and completeness of the floor plan.
Plan produced using PlanUp.



297 Uppingham
Road, Humberstone, Leicester
LE5 4DG

<https://kings.globalnoticeboard.com>
info@kingsestateuk.com
0116 352 7012

Agents Note: Whilst every care has been taken to prepare these sales particulars, they are for guidance purposes only. All measurements are approximate and are for general guidance purposes only and whilst every care has been taken to ensure their accuracy, they should not be relied upon and potential buyers are advised to recheck the measurements

