



**Coldharbour Lane, Brixton, SW9**

3 bedroom flat to let

**£650 Per Week**

Furnished

## Property Details

Living here offers the best of both worlds: a stunning modern interior combined with an unbeatable location just moments from Brixton Market and a short walk to Brixton Station, providing an easy commute into central London.

The flat comprises three spacious double bedrooms, a stylish yet comfortable living area with an open-plan kitchen, and a sleek, modern family-sized bathroom. Situated within Clifton Mansions, the property benefits from being directly opposite Brixton Market, with Brixton Station just a two-minute walk away. A vibrant selection of restaurants, nightlife, and excellent shopping options are all right on your doorstep.

## Features

- Conversion Flat
- Three double bedrooms
- A few minutes walk to Brixton station
- Moments away from Brixton markets
- Bright And Airy
- Close To Transport Links

Council tax band B      EPC rating C (79)





Coldharbour Lane, Brixton, SW9



3 Bed flat

Approx internal area:

**638 sqft 59 sqm**

While we do try our very best, floor plans are produced as a guide only and we take no responsibility for the precise accuracy with which any property is represented

## Coldharbour Lane

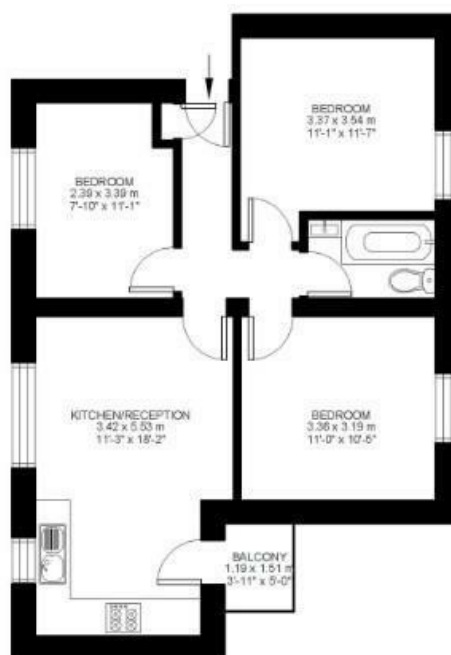

First Floor





Coldharbour Lane, Brixton, SW9

