



Plato Road, Brixton, SW2

4 bedroom house to let

£1,026 Per Week

Furnished

Property Details

A beautiful four double bedroom house located on Plato Road, popular for its close proximity to both Clapham and Brixton. The property comprises of a substantial double aspect lounge and dining room, a large eat-in kitchen diner with a door that opens out onto a lovely private garden which allows heaps of natural light to enter the property. On the upper floors sit four good sized double bedrooms and two modern bathrooms. Living here you'll get the best of both worlds being in walking distance of both Brixton and Clapham, you'll also be around a thirteen minute walk from Brixton underground and around a fifteen minute walk to Clapham Common station. Clapham Common is also around a fifteen minute walk away which is ideal for walks in the coming spring/summer months.

Features

- Four double bedrooms
- Two modern bathrooms
- Double aspect reception and dining room
- Separate eat-in kitchen
- Large private garden
- Around a 13 minute walk to Brixton underground
- Around a 15 minute walk to Clapham Common

Council tax band E EPC rating E (44)

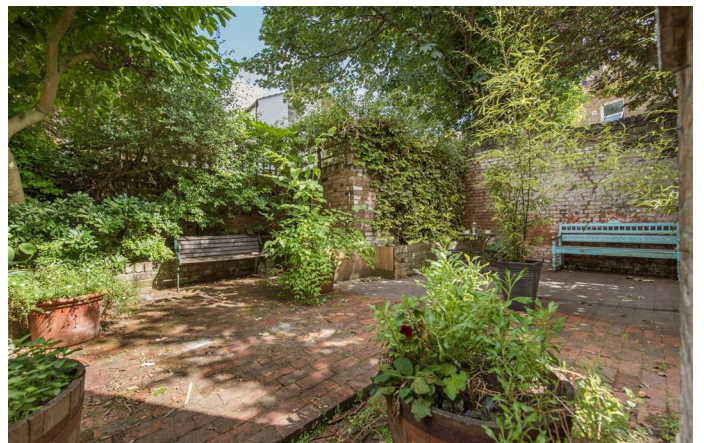

Plato Road, Brixton, SW2



4 Bed House
Approx internal area:
1560 sqft 145 sqm

While we do try our very best, floor plans are produced as a guide only and we take no responsibility for the precise accuracy with which any property is represented

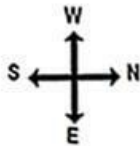

Plato Road

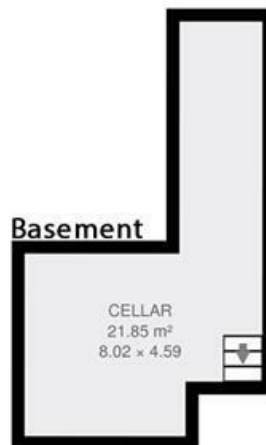

Plato Road, Brixton, SW2

