



PHILLIPS & STILL

LANSDOWNE PLACE, HOVE  
ASKING PRICE OF £120,000





This property is a second floor studio flat, making it an ideal investment opportunity for first-time buyers. It is located in a sought-after area, close to Hove seafront. The flat is being sold with no onward chain, which means there are no complications or delays in the sale process.

The studio layout typically includes a combined living and sleeping area, a kitchenette, and a separate bathroom.

The location of the property near Hove seafront is highly desirable as it provides easy access to the beach and various recreational activities. Living close to the seafront offers the potential for beautiful views, refreshing walks, and a vibrant coastal atmosphere.

## SECOND FLOOR

### STUDIO ROOM

10' 10" x 10' 4" (3.3m x 3.15m)

### SHOWER ROOM

### Lansdowne Place, Hove BN3 1FJ

Approximate Gross Internal Area = 15.5 sq m / 167 sq ft

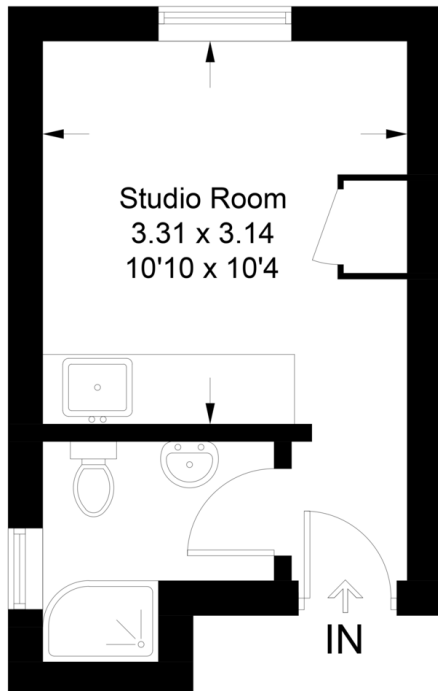

## Second Floor

Illustration for identification purposes only, measurements are approximate, not to scale. Imageplansurveys © 2024

Score	Energy rating	Current	Potential
92+	A		
81-91	B		85 B
69-80	C		
55-68	D		
39-54	E	53 E	
21-38	F		
1-20	G		

Agents Note: Whilst every care has been taken to prepare these sales particulars, they are for guidance purposes only. All measurements are approximate and for general guidance purposes only and whilst every care has been taken to ensure their accuracy, they should not be relied upon and potential buyers are advised to recheck the measurements

