



## Gatliff Road, SW1W

£576 Per week

A fantastically well presented one double bedroom flat on the sixth floor with lift. In a secure development with 24 hour porter on the borders of Chelsea and Pimlico. The flat has an open plan reception with ample storage

Grosvenor Waterside is a secure luxury riverside development near Sloane Square and Pimlico, the shopping and restaurant options on the Kings Road are within walking distance. You are also opposite Battersea Park.

### Features

- Modern Development
- 24 Hour Porter
- Ample Storage
- Lift
- Large Bedroom
- Open Plan Reception Room
- Excellent Condition

Gatliff Road,  
London, SW1W

### Sixth Floor

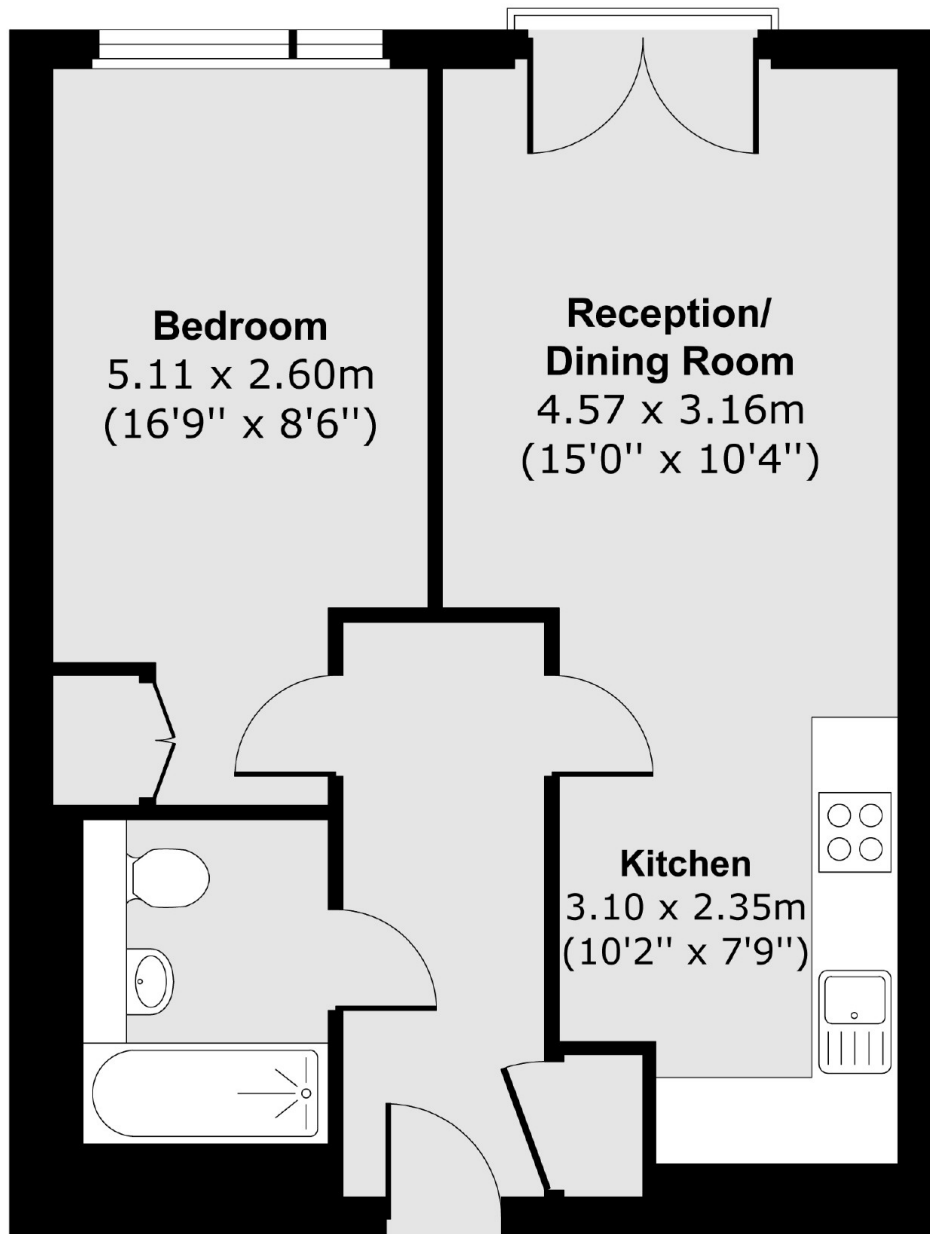

Total area (approx.) 44.36 sq. m (477 sq. ft)