



Claverton Street, SW1V

£550 Per week

A modern two bedroom two bathroom flat to rent on the ground floor of a period conversion. The flat has wood floors and is spacious, perfect for professional sharers or a couple looking for extra space.

Claverton Street is well located in Pimlico, close to the river, a short distance to the cafes, shops and restaurants of the Grid and the daily farmers market at TachbrookTriangle.

Features

Two Bedrooms
Two Bathrooms
Modern
Wood Floors
Ground Floor
Furnished

Claverton Street, London, SW1V

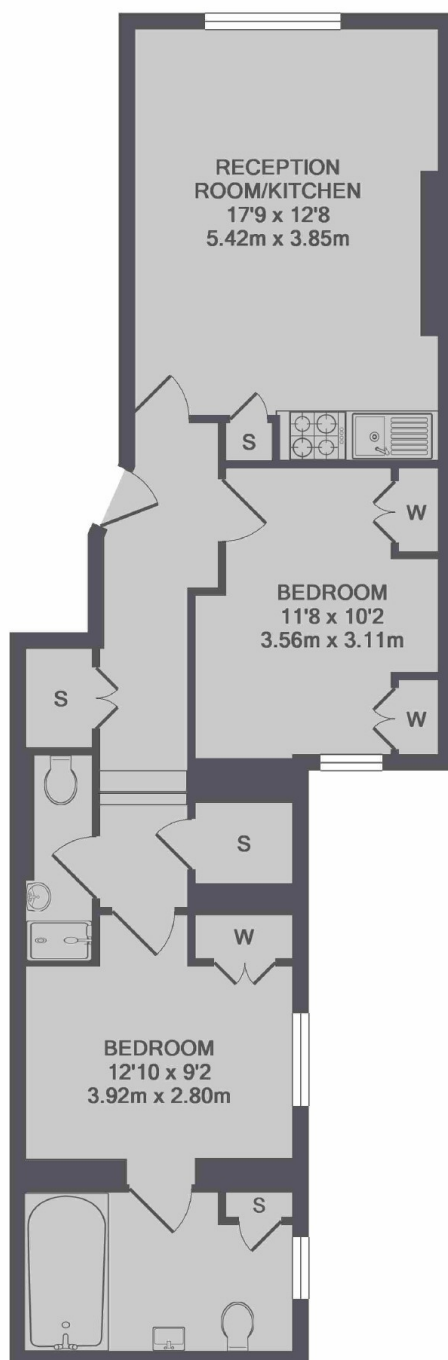

TOTAL APPROX. FLOOR AREA 667 SQ.FT. (62.0 SQ.M.)

Dexters

Pimlico
50 Churton Street
London
SW1V 2LP
Lettings
020 7976 5200

Energy Rating: B. We aim to make our particulars both accurate and reliable. However they are not guaranteed; nor do they form part of an offer or contract. If you require clarification on any points then please contact us, especially if you're traveling some distance to view. Please note that appliances and heating systems have not been tested and therefore no warranties can be given as to their good working order.

 **RICS** | Regulated
Estate Agent
and Letting Agent

[dexters.co.uk](https://www.dexters.co.uk)