

Lupus Street, SW1V

£550 Per week

A great one bedroom flat to rent on the top floor of Robin Court. The flat has a large balcony, wood floors, open plan kitchen reception and a modern finish throughout.

Robin Court is well located at the bottom of St George's Drive, close to Pimlico Station and the many boutique restaurants and cafés of the Moreton Triangle.

Features

- One Bedroom
- Wood Floors
- Balcony
- Modern
- Purpose-Built
- Top Floor

Lupus Street,
London, SW1V

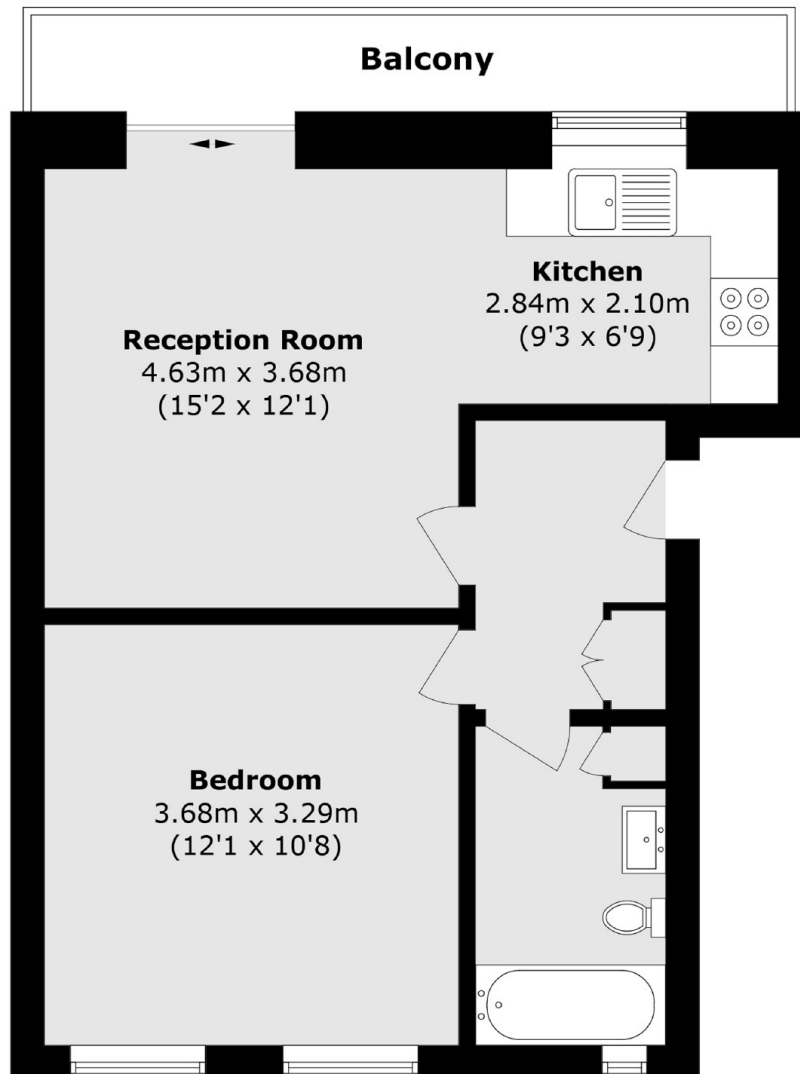

Total area (approx.): 46.5 sq. m (500.5 sq. ft)

Balcony area (approx.): 5.8 sq. m (62.4 sq. ft)

Dexters

Pimlico
42 Denbigh Street
London
SW1V 2ER
Lettings
020 7976 5200

Energy Rating: D. We aim to make our particulars both accurate and reliable. However they are not guaranteed; nor do they form part of an offer or contract. If you require clarification on any points then please contact us, especially if you're traveling some distance to view. Please note that appliances and heating systems have not been tested and therefore no warranties can be given as to their good working order.

 **RICS** | Regulated
Estate Agent
and Letting Agent

[dexters.co.uk](https://www.dexters.co.uk)