



Churchill Gardens, SW1V

£576 Per week

A bright and spacious two double bedroom flat arranged over the 7th floor of a purpose built building with lift access with wood floors and a separate kitchen.

Churchill Gardens is a conservation area and Sullivan House a listed building and is kept in very good condition. It is only a short walk to the shopping areas in Pimlico, Sloane Square and Victoria, as well as being in a great position by the river.

Features

- Two double bedrooms
- Lift
- Centrally Located
- Separate Kitchen
- Wooden Floors
- One Bathroom

Churchill Gardens,
London, SW1V

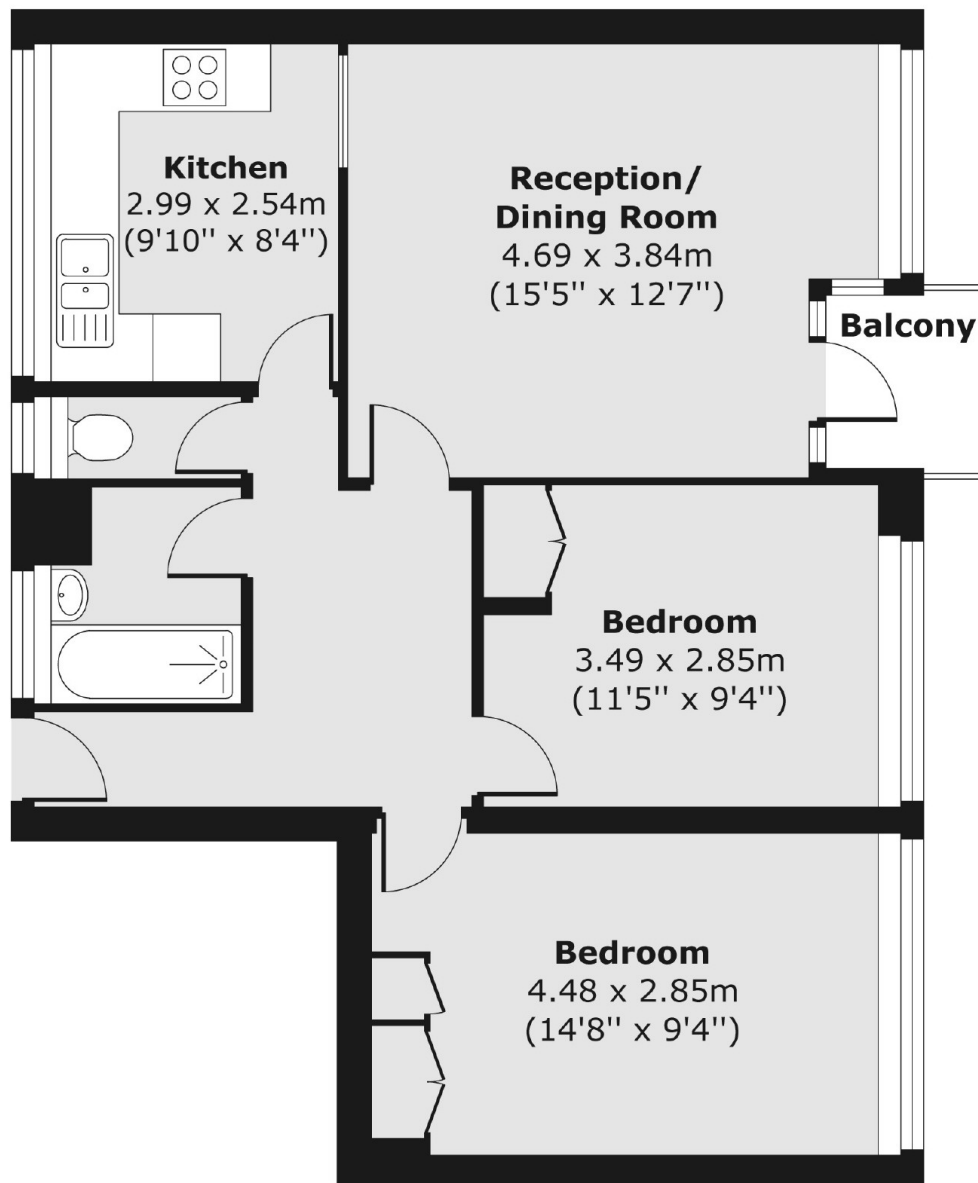

Total area (approx.) 62.16 sq. m (669 sq. ft)

Balcony area (approx.) 2.18 sq. m (23 sq. ft)