



Rochester Row, SW1P

£420 Per week

A large studio apartment based on the sought after Rochester Row with fantastic natural light. The apartment is newly refurbished, with lift access in the building.

Emanuel House is located on Rochester Row, close to the junction with Greycoat Place and is therefore well positioned for access to the local shopping facilities of Victoria Street and the transport services of Victoria.

Features

Newly Refurbished
Wood Floors Throughout
Lift Access
Integrated Appliances
Close to Transport
Ample Storage

Rochester Row,
London, SW1P

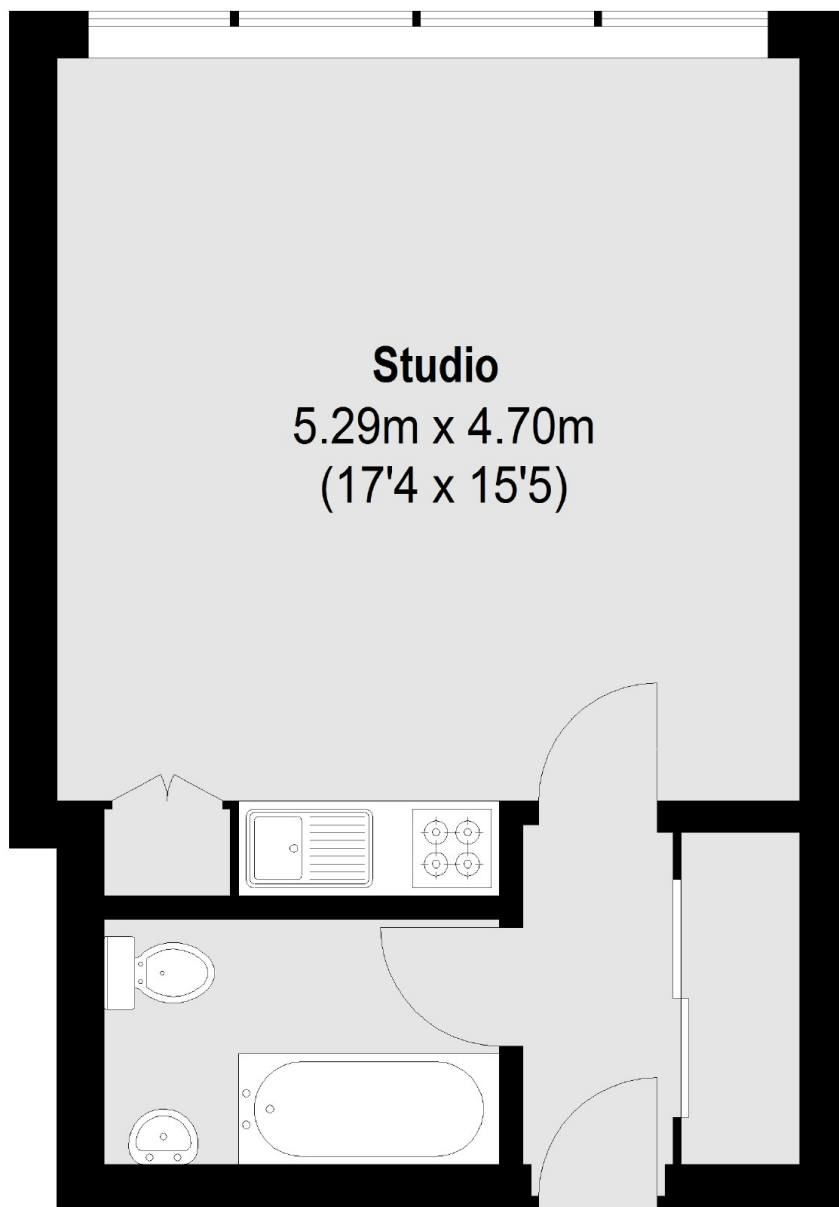

Second Floor

Total area (approx.): 32.4 sq. m (349 Sq. ft)