



Claverton Street, SW1V

£425 Per week

Designed to include a reception/bedroom room with high ceilings and access to a small balcony, separate eat-in kitchen and a bathroom. The property also benefits from a shared roof terrace.

Claverton Street is popular in Pimlico, close to the river and it's a short distance to the cafes, shops and restaurants of Warwick Way in the Grid and the weekend farmers market at Tachbrook Triangle. Pimlico Underground or Victoria provides quick links in or out of the city.

Features

- Private Balcony
- Shared Roof Terrace
- Large And Bright
- Excellent Location
- Bright & Spacious
- Wooden Floors Throughout

Claverton Street,
London, SW1V

First Floor

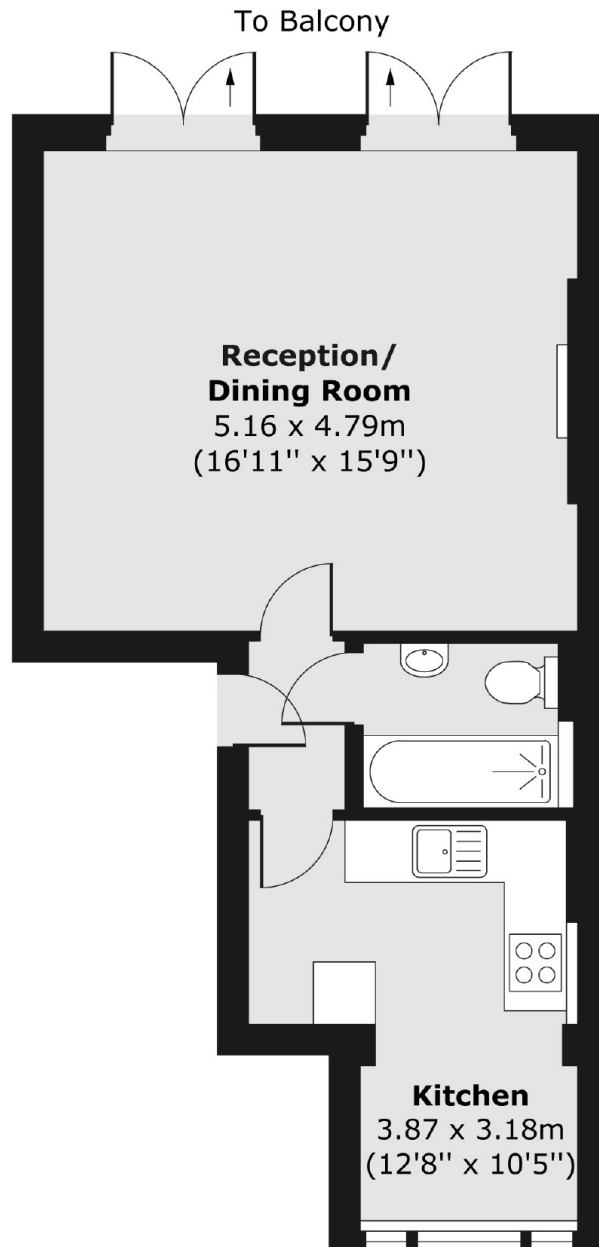

Total area (approx.) 40.47 sq. m (436 sq. ft)

Dexters

Pimlico
50 Churton Street
London
SW1V 2LP
Lettings
020 7976 5200

Energy Rating: . We aim to make our particulars both accurate and reliable. However they are not guaranteed; nor do they form part of an offer or contract. If you require clarification on any points then please contact us, especially if you're traveling some distance to view. Please note that appliances and heating systems have not been tested and therefore no warranties can be given as to their good working order.

 **RICS** | Regulated
Estate Agent
and Letting Agent

[dexters.co.uk](https://www.dexters.co.uk)