



Gloucester Street, SW1V

£500 Per week

A well proportioned one double bedroom apartment to let in the Pimlico Grid. The property has a bright reception room, separate kitchen, double bedroom with built in storage and bathroom with shower over bath. An ideal home for a single professional or a couple.

Gloucester Street is located a short distance to local shops and restaurants on both Wilton place and Warwick Way including Waitrose supermarket, Café Nero and several boutique restaurants. The two closest underground stations are Victoria and Pimlico.

Features

- One Double Bedroom
- Third Floor Apartment
- Good Natural Light
- Separate Kitchen
- In Built Storage
- Pimlico Grid

Gloucester Street,
London, SW1V

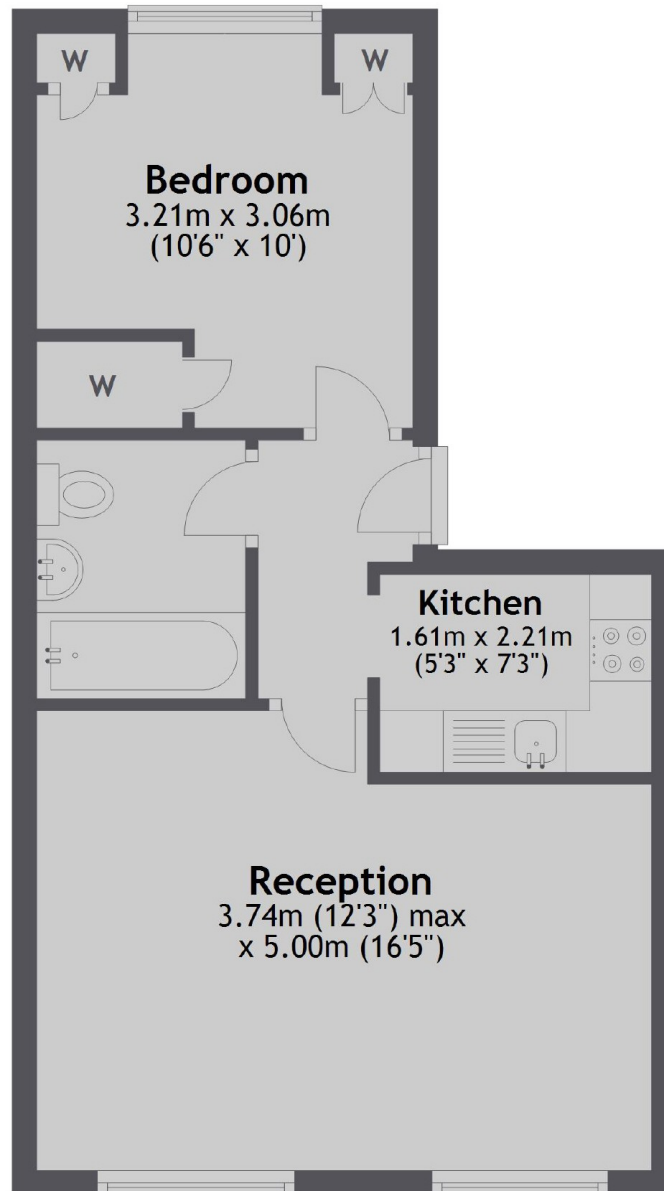

Total area: approx. 37.7 sq. metres (405.8 sq. feet)

Dexters

Pimlico
42 Denbigh Street
London
SW1V 2ER
Lettings
020 7976 5200

Energy Rating: C. We aim to make our particulars both accurate and reliable. However they are not guaranteed; nor do they form part of an offer or contract. If you require clarification on any points then please contact us, especially if you're traveling some distance to view. Please note that appliances and heating systems have not been tested and therefore no warranties can be given as to their good working order.

 **RICS** | Regulated
Estate Agent
and Letting Agent

dexters.co.uk