

Rochester Row, SW1P

£657 Per week

A modern two double bedroom apartment on the first floor of this purpose built block in Westminster with a lift and on-site caretaker. Bright reception room with wood floors, semi open plan refurbished kitchen, two equal size double bedrooms and bathroom with shower over bath. The property is perfect for sharers or a couple wanting space and a fantastic Westminster location.

Emanuel House is located on Rochester Row, close to the junction with Greycoat Place and is therefore well positioned for access to the local shopping facilities of Victoria Street and the transport services of Victoria.

Features

- Two Double Bedrooms
- One Bathroom
- First Floor Apartment
- Modern Open Plan Kitchen
- Lift
- On-site Caretaker

Rochester Row,
London, SW1P

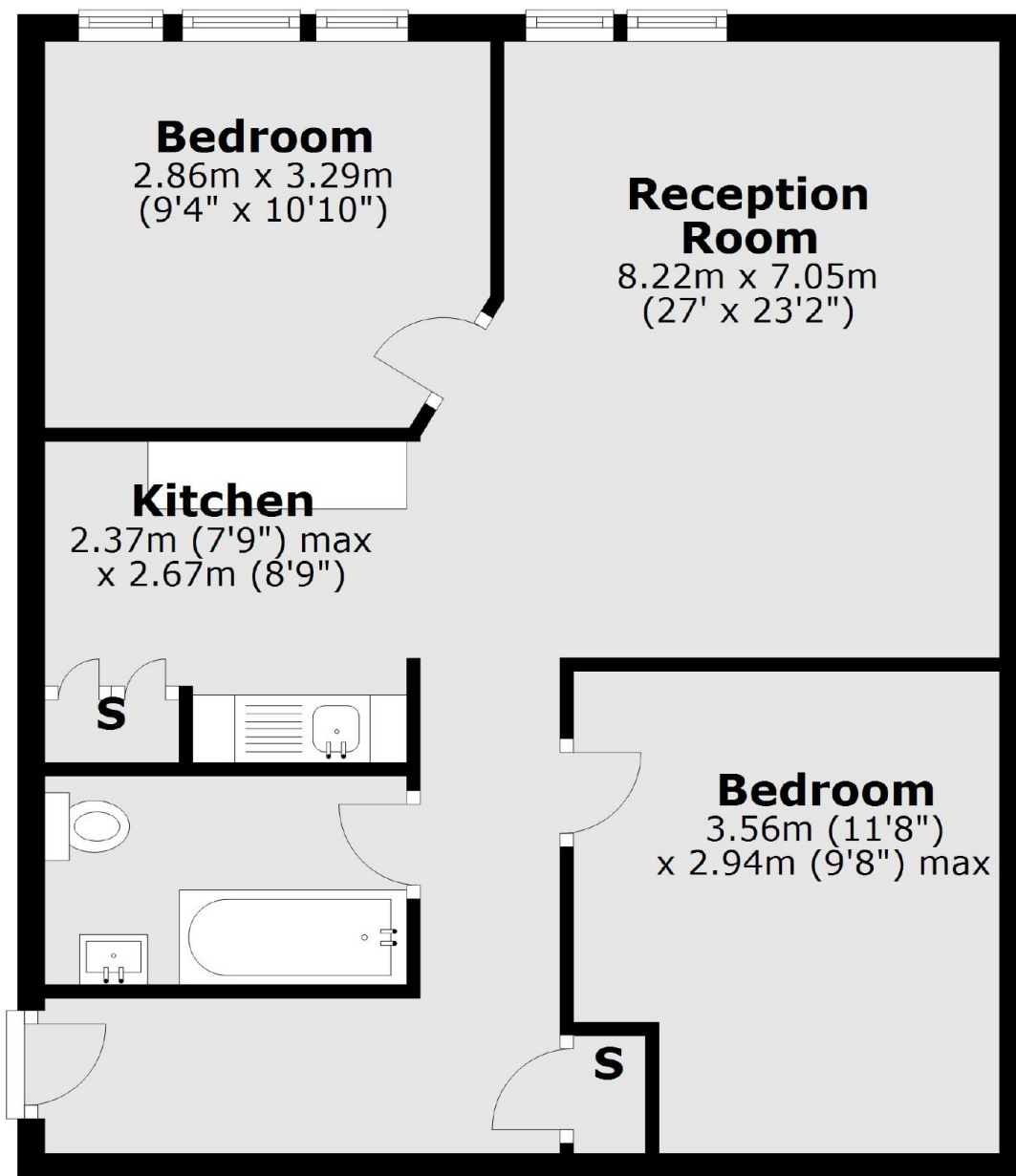

First Floor

Total area: approx. 57.2 sq. metres (616.1 sq. feet)