



Montaigne Close, SW1P

£1,038 Per week

A spacious three bedroom, two bathroom first floor flat in a secure gated development with gym and porter. Large reception room with balcony, separate eat in kitchen, master bedroom with en suite bathroom, two further good size double bedrooms and family bathroom. An ideal home for a family or three professional sharers.

Montaigne Close is perfectly located, a short walk from the river as well as both Pimlico and Victoria stations. With a number of supermarkets and cafés across the road, you have everything you need nearby.

Features

- Three Large Bedrooms
- Two Bathrooms
- Private Balcony
- Gated Development
- 24 Hour Porter Service
- Gym Access

Montaigne Close, London, SW1P

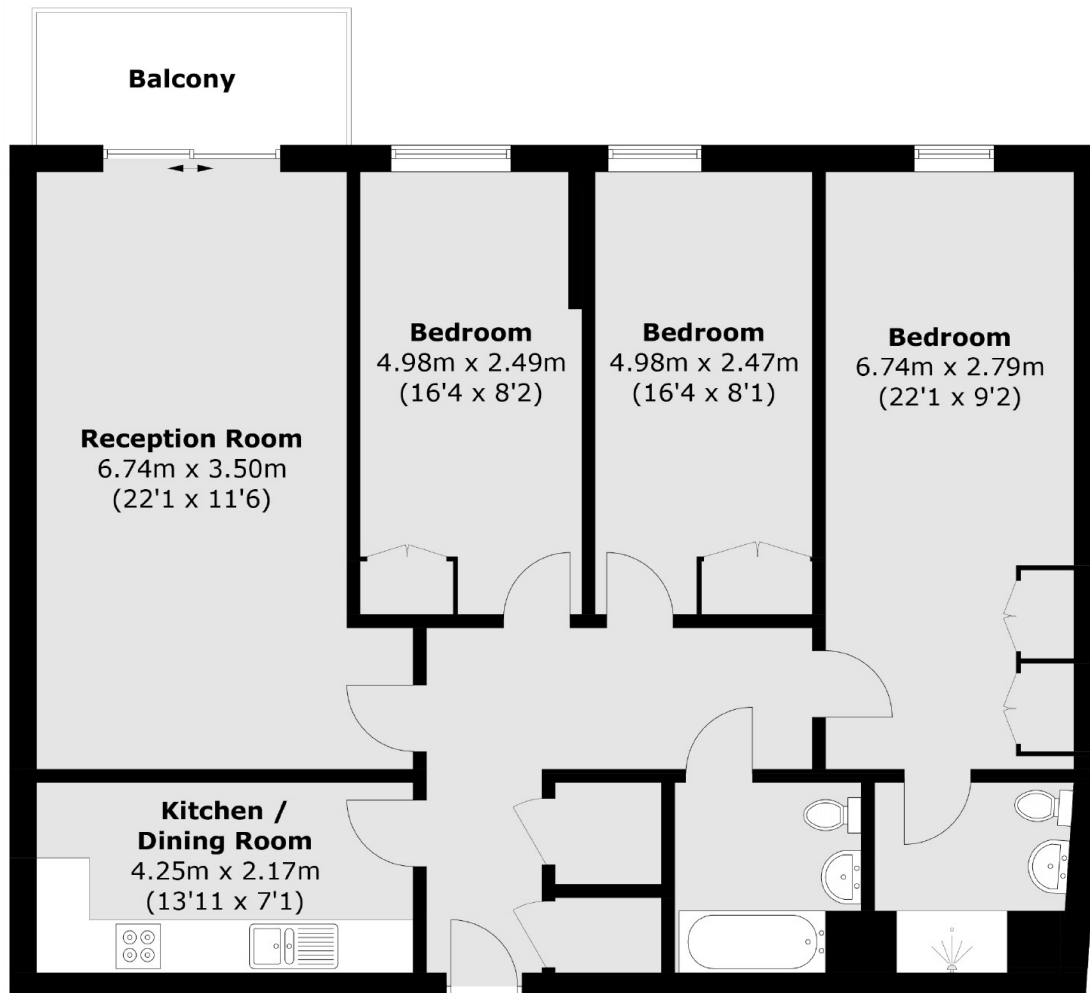

Total area (approx.): 106.1 sq. m (1,142.1 sq. ft)
Balcony: 5.2 sq. m (56.0 sq. ft)