



Moreton Terrace, SW1V

£600 Per week

Located in the 'Moreton Triangle' this two bedroom garden flat comprises a well-sized reception room with wood floors and a feature fireplace, a separate fitted kitchen and private patio to the rear.

Moreton Street is part of the "Moreton Triangle" and lies in the heart of Pimlico. The public gardens of St. George's Square are only moments away, as is Pimlico tube station. Victoria station provides further superb transport links (Gatwick Express, British Rail, District, Circle and Victoria lines) as well as an abundance of shops.

Features

- Garden Flat
- Two Bedroom
- Well-sized Reception Room
- Fitted Kitchen
- Separate Bathroom & W.C
- Private Patio Garden
- Unfurnished

Moreton Terrace, London, SW1V

Lower Ground Floor

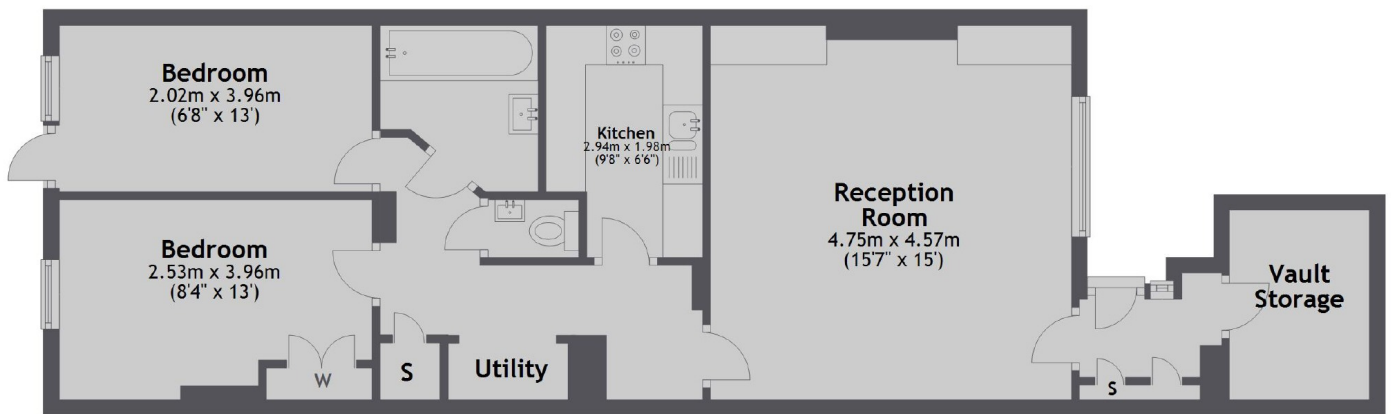

Total area: approx. 67.2 sq. metres (722.8 sq. feet)