



Medway Street, SW1P

£525 Per week

This modern one double bedroom apartment on the ground floor of a portered building in the centre of Westminster. Spacious reception room, open plan kitchen, double bedroom with built in storage and bathroom with shower over bath. There is an allocated parking space included in the rent.

Ormond House is excellently located in the centre of Westminster behind the Channel Four building. With four stations, Victoria, Pimlico, Westminster and St James's Park all within walking distance you will never have far to walk!

Features

- One Double Bedroom
- Modern Kitchen
- Porter Service
- Ground Floor Apartment
- Good Storage
- Allocated Parking Space Included

Medway Street, London, SW1P

Ground Floor

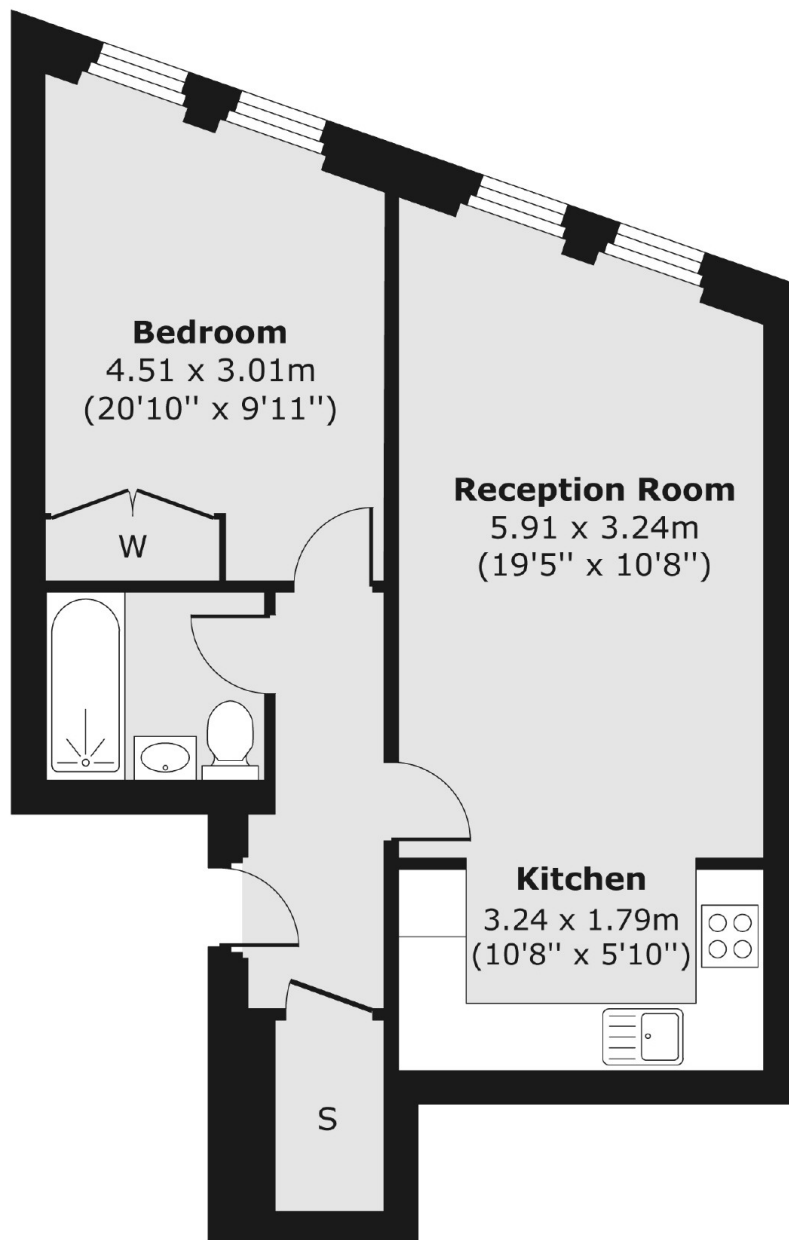

Total area (approx.) 46.39 sq. m (499 sq. ft)