



Regency Street, SW1P

£750 Per week

A spacious two double bedroom apartment on the second floor of a purpose built block in Westminster. A bright reception room with bay window, separate modern kitchen, master bedroom with en suite shower room, second good size double bedroom and family bathroom. Excellent storage throughout. The block also has a day porter, well-equipped gym and shared private gardens for residents.

Regency Street which is a short walk from the excellent transport links offered at Victoria, Pimlico and Westminster as well the attractions of The Tate Gallery, The Houses of Parliament and an abundance of local amenities.

Features

- Two Double Bedrooms
- Two Bathrooms
- Second Floor Apartment
- Separate Modern Kitchen
- Lift
- Day Porter

Regency Street, London, SW1P

Second Floor

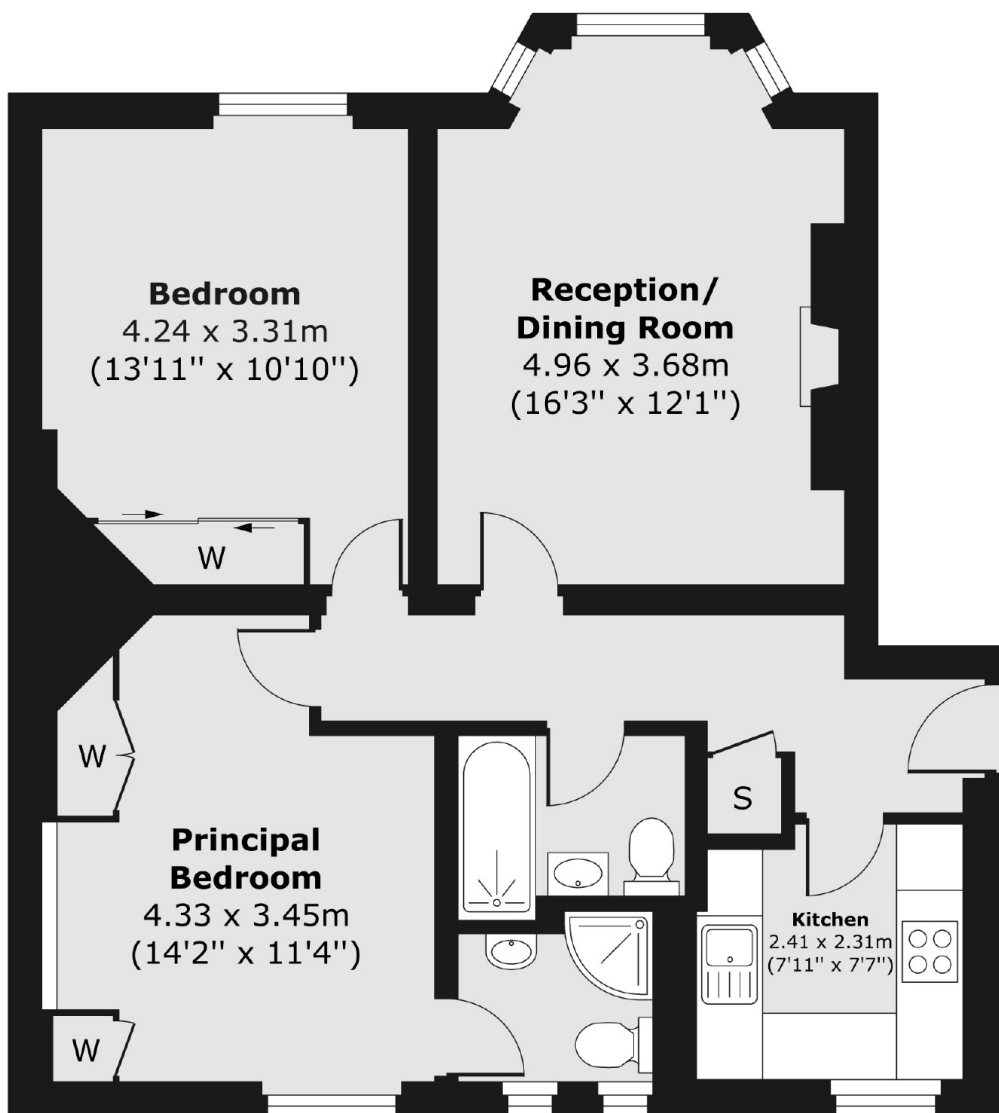

Total area (approx.) 67.66 sq. m (728 sq. ft)