

Millbank Quarter, SW1P

£807 Per week

A newly refurbished one double bedroom apartment in a 24 hour portered block in Westminster. Residents have access to the buildings luxury gym, swimming pool, sauna and steam room.

Millbank is a luxury development next to the River Thames and ideally located for transport from Westminster, Victoria and St James's Park. Waterloo and Charing Cross are also within easy reach.

Features

- Newly Refurbished
- One Double Bedrooms
- Wood Floors
- Open Plan Kitchen
- 24 Hour Porter Service
- Communal Swimming Pool
- Gym

Millbank Quarter, London, SW1P

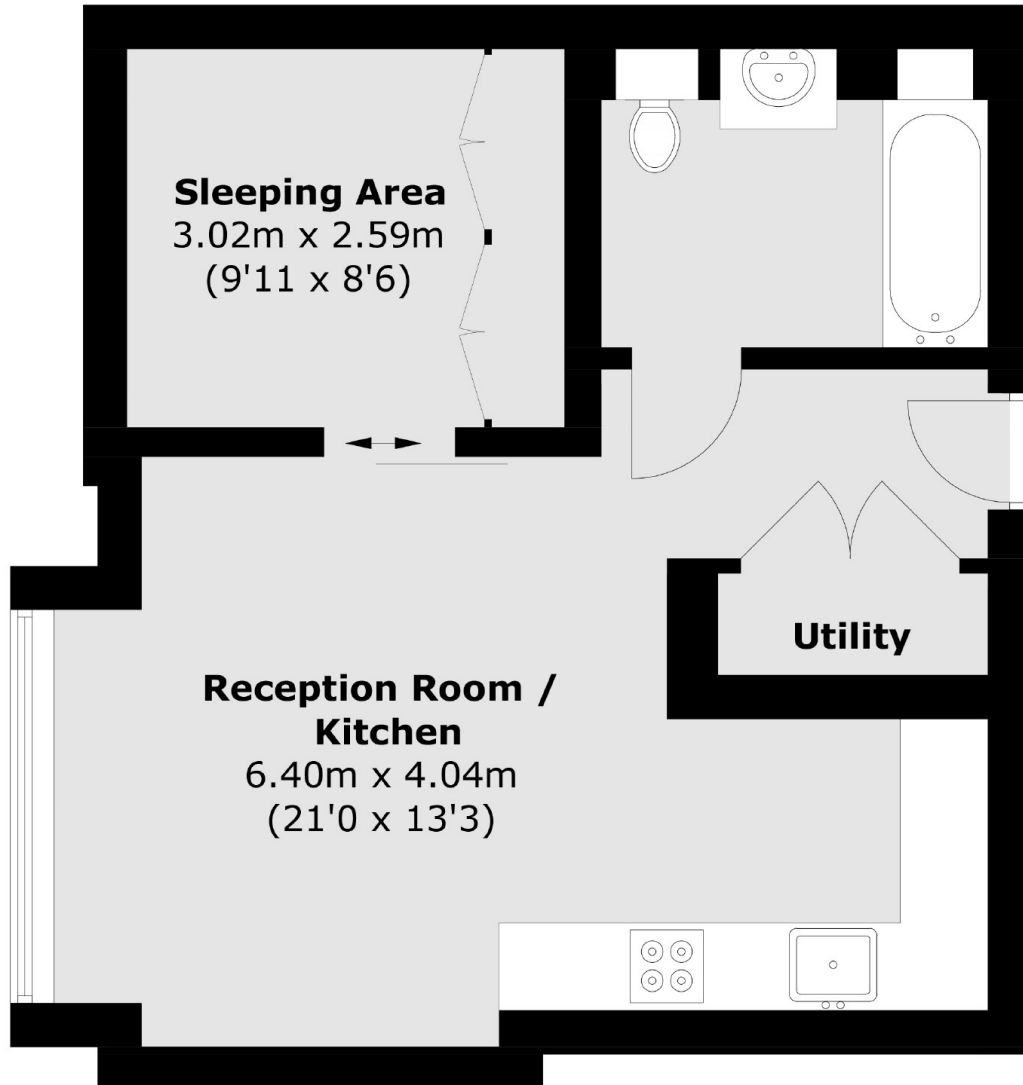

Total area (approx.): 40.9 sq. m (440.2 sq. ft)