



Gatliff Road, SW1W

£500 Per week

A one double bedroom flat on the seventh floor with lift in a secure development with 24 hour porter on the borders of Chelsea and Pimlico. Bright reception room with modern open plan kitchen, good size double bedroom with ample storage and bathroom with shower over bath.

Grosvenor Waterside is a secure luxury riverside development near Sloane Square and Pimlico, the shopping and restaurant options on the Kings Road are within walking distance. You are also opposite Battersea Park.

Features

- One Double Bedroom
- Modern Development
- 24 Hour Porter
- Seventh Floor With Lift
- Juliette Balcony
- Open Plan Reception

Gatliff Road, London, SW1W

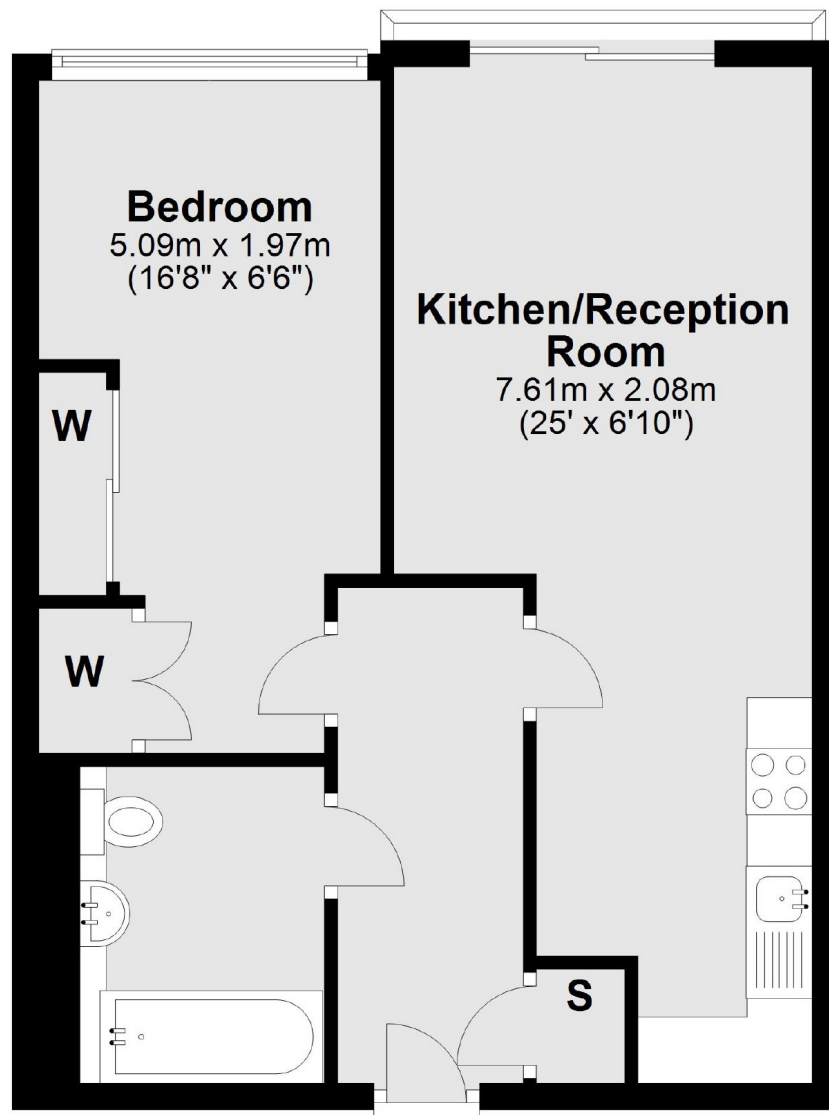

Seventh Floor

Total area: approx. 44.6 sq. metres (480.1 sq. feet)