

**Apartment 12 Rotary Court, 37 South Road  
Weston-Super-Mare, BS23 2LY**

**£127,500**

A delightfully quirky, two bedroom, third floor, leasehold apartment offering a privileged and elevated position overlooking Weston town. This super apartment is arranged over split levels creating interesting, characterful and versatile rooms throughout. Accommodation comprises; kitchen/dining room, living room, bathroom and two bedrooms. The property boasts impressive views of Weston town and the bay from the spacious living room and offers an allocated off street parking space. Benefiting from an elevated position and within reach of the Sea Front, Weston town centre where local shops, amenities with transport links via train, bus and the M5, junction 21 can be found viewing is recommended to appreciate this charming older property. EPC rating F22, Council Tax Band A.



- Two bedroom, leasehold third floor apartment
- Off street parking
- Privileged and elevated position on Weston's hillside
- Packed with quirky characterful features
- Located on the popular South Road, within reach of the sea front, town centre and local shops and amenities
- Views across Weston town and bay
- EPC rating F22, Council Tax Band A



## ACCOMMODATION

### Entrance

Communal entrance hallway with stairs rising to timber entrance door to apartment 12.

### Hallway

Carpeted flooring, doors to bedrooms, wall light.

### Bedroom Two 12' 2" x 10' 1" (3.71m x 3.07m)

Carpeted flooring, night storage heater, timber framed single glazed sash window, access to roof space, ceiling light.

### Stair flight rising to kitchen/dining room from hallway.

Carpeted stairs, internal window (to bathroom), timber handrail.

### Kitchen/Dining Room 24' 9" x 11' 3" (7.55m x 3.44m)(maximum)

Carpeted and vinyl flooring, range of floor units, integrated one and a half bowl sink and drainer with mixer tap over, space and plumbing for appliances, integrated four ring electric hob and oven, two timber framed double glazed skylight windows, timber framed single glazed fixed sky light window, space for dining table, night storage heater, door to eves storage, sloped ceiling, wall and ceiling lights, doors to rooms.

### Living Room 15' 9" x 13' 9" (4.81m x 4.19m)(maximum)

Carpeted flooring, decorative fireplace, two night storage heaters, two timber framed single glazed sash windows, stunning views over Weston town and bay, ceiling rose and ceiling light, door to bedroom one.

### Bedroom One 17' 2" x 15' 6" (5.23m x 4.72m)(ceiling narrowing to 0.91m)(maximum)

Exposed and painted timber wood flooring, night storage heater, sloped ceiling, timber beams, two single glazed windows, ceiling light.

### Bathroom 13' 11" x 7' 11" (4.25m x 2.42m)(maximum)

Timber flooring, low level W/C, wash hand basin, panelled bath, sloped ceilings, sky light window, door to usable storage cupboard housing hot water tank.







# Flat 12, Rotary Court, WsM

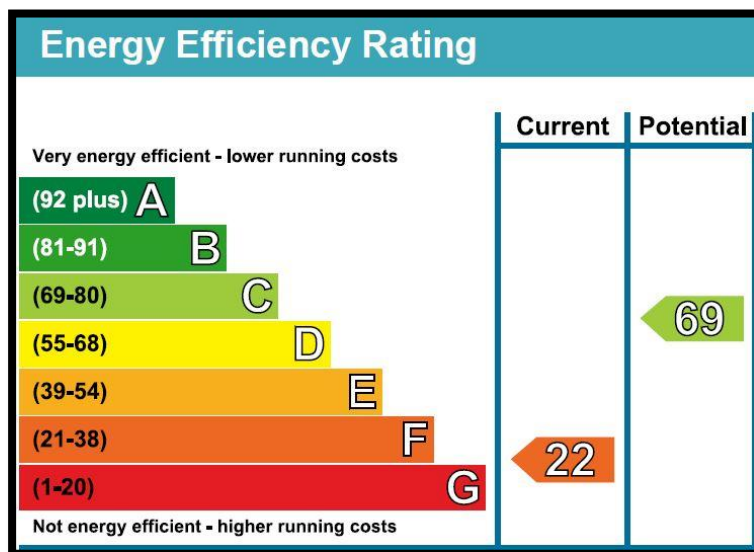
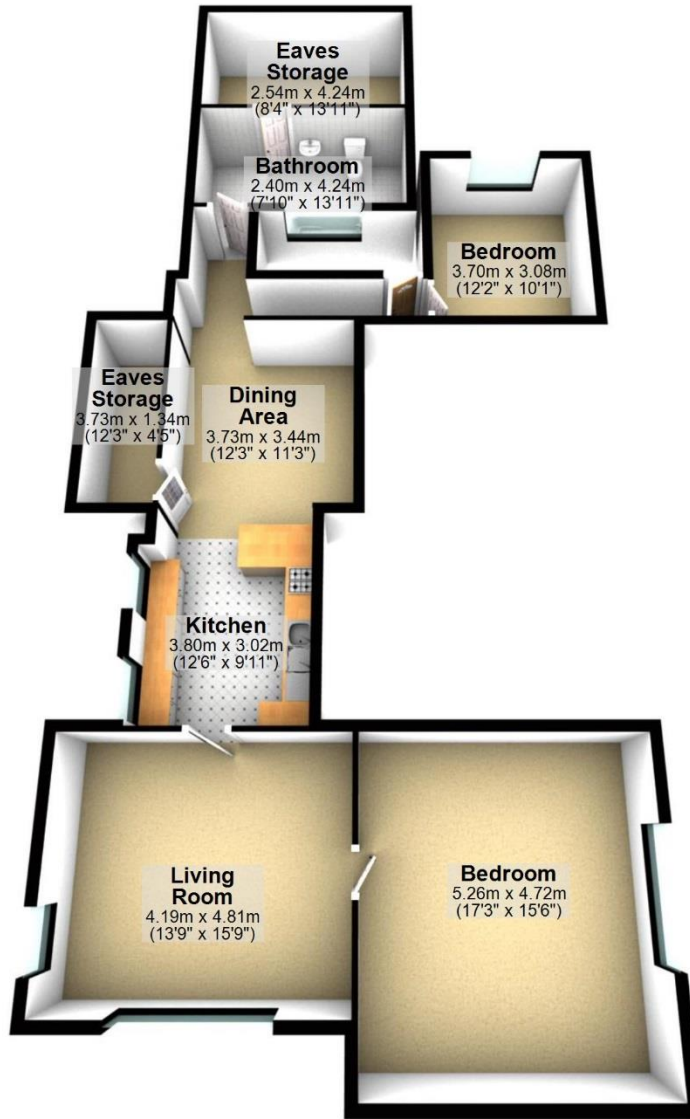

MONEY LAUNDERING REGULATIONS 2007 intending purchasers will be asked to produce identification and proof of financial status when an offer is received. We would ask for your co-operation in order that there will be no delay in agreeing the sale.

CONSUMER PROTECTION REGULATION 2013. The Agent has not tested any apparatus, equipment, fixtures and fittings or services and so cannot verify that they are in working order or fit for the purpose. A Buyer is advised to obtain verification from their Solicitor or Surveyor. References to the Tenure of a Property are based on information supplied by the Seller. The Agent has not had sight of the title documents. A Buyer is advised to obtain verification from their Solicitor. You are advised to check the availability of this property before travelling any distance to view. We have taken every precaution to ensure that these details are accurate and not misleading. If there is any point which is of particular importance to you, please contact us and we will provide any information you require. This is advisable, particularly if you intend to travel some distance to view the property. The mention of any appliances and services within these details does not imply that they are in full and efficient working order. These particulars are in draft form awaiting Vendors confirmation of their accuracy. These details must therefore be taken as a guide only and approved details should be requested from the agents.