

£1,375 Per Calendar Month

Island View Terrace, Portsmouth PO2
8EP

bernards
THE ESTATE AGENTS



HIGHLIGHTS

- ❖ THREE BEDROOM TERRACED HOUSE
- ❖ MODERN KITCHEN
- ❖ MODERN BATHROOM
- ❖ COUNCIL TAX BAND B
- ❖ GARDEN
- ❖ GAS CENTRAL HEATING
- ❖ VIEWS OVER WHALE ISLAND
- ❖ DOUBLE GLAZED THROUGHOUT
- ❖ AVAILABLE IMMEDIATELY
- VIEW NOW

A beautifully presented three-bedroom property, located in the highly sought-after area of Stamshaw, Portsmouth — perfect for families or professional tenants alike.

The ground floor features a cosy lounge, a spacious dining room/second reception that flows seamlessly into a modern rear kitchen, and a large contemporary bathroom.

Upstairs, the first floor offers three generously sized bedrooms, a separate W/C, and the property has been recently redecorated throughout, giving it a fresh and modern feel.

Positioned close to local amenities, schools, and transport links — this home is not to be missed.

Available now, call to enquire on 02392 728 090.

Call today to arrange a viewing
02392 728090
www.bernardsestates.co.uk





Call today to arrange a viewing
02392 728090
www.bernardsestates.co.uk



PROPERTY INFORMATION

Tenant Fees Act 2019

As well as paying the rent, you may also be required to make the following permitted payments.

For properties in England, the Tenant Fees Act 2019 means that in addition to rent, lettings agents can only charge tenants (or anyone acting on the tenant's behalf) the following permitted payments:

- Holding deposits (a maximum of 1 week's rent);
- Deposits (a maximum deposit of 5 weeks' rent for annual rent below £50,000, or 6 weeks' rent for annual rental of £50,000 and above);
- Payments to change a tenancy agreement eg. change of sharer (capped at £50 or, if higher, any reasonable costs);
- Payments associated with early termination of a tenancy (capped at the landlord's loss or the agent's reasonably incurred costs);
- Where required, utilities (electricity, gas or other fuel, water, sewerage), communication services (telephone, internet, cable/satellite television), TV licence;
- Council tax (payable to the billing authority);

- Interest payments for the late payment of rent (up to 3% above Bank of England's annual percentage rate);
- Reasonable costs for replacement of lost keys or other security devices;
- Contractual damages in the event of the tenant's default of a tenancy agreement; and
- Any other permitted payments under the Tenant Fees Act 2019 and regulations applicable at the relevant time.

Right to Rent

Each applicant will be subject to the right to rent checks. This is a government requirement since February 2016. We are required to check and take a copy of the original version of acceptable documentation in order to adhere to the Right to rent checks. This will be carried out at referencing stage. Please speak to a member of staff for acceptable Identification.

Council Tax Band B

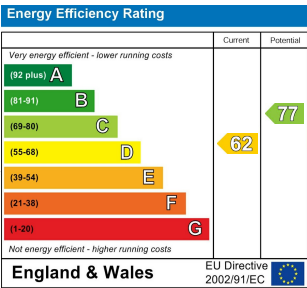

GROUND FLOOR
486 sq.ft. (45.2 sq.m.) approx.

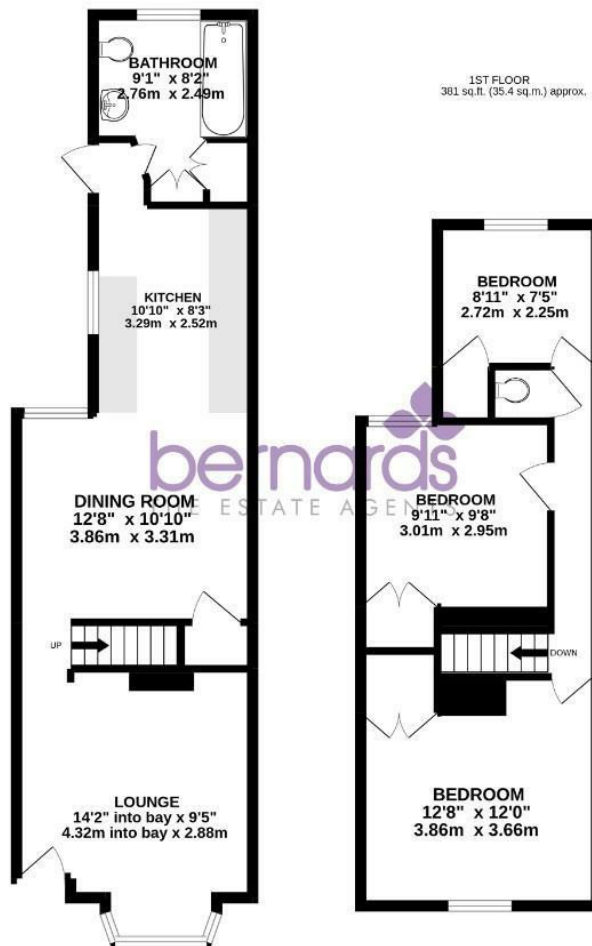

1ST FLOOR
381 sq.ft. (35.4 sq.m.) approx.

TOTAL FLOOR AREA: 867 sq.ft. (80.5 sq.m.) approx.

Whilst every attempt has been made to ensure the accuracy of the floorplan contained here, measurements of doors, windows, rooms and any other items are approximate and no responsibility is taken for any error, omission or mis-statement. This plan is for illustrative purposes only and should be used as such by any prospective purchaser. The services, systems and appliances shown have not been tested and no guarantee as to their operability or efficiency can be given.
Made with Metroplan ©2022

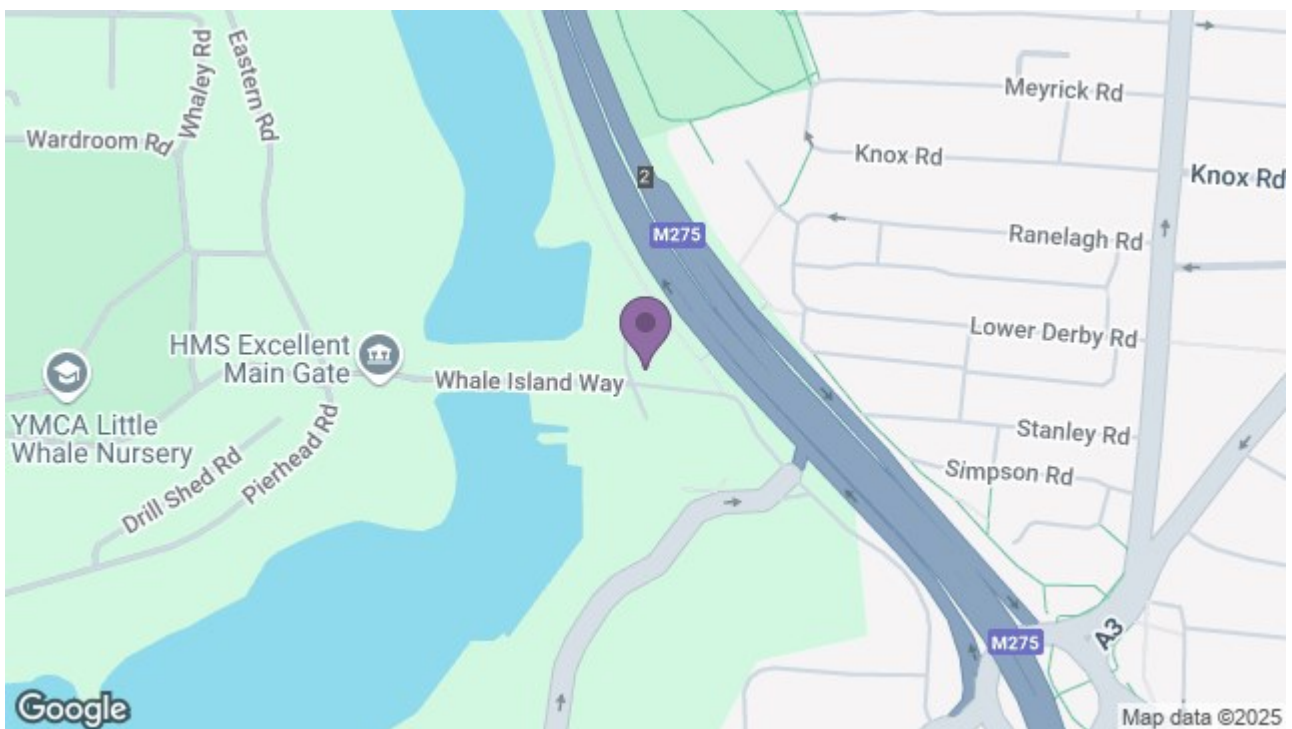

129 London Road, Portsmouth, Hampshire, PO2 9AA
t: 02392 728090

