



KAP
COUNTRY
HOMES
FOR SALE
01892 - 838 080

Blunden Lane

Yalding ME18 6JQ

Guide Price £395,000



COUNTRY HOMES

Yalding ME18 6JQ

Extended three bedroom semi-detached family home located in the picturesque village of Yalding.

This delightful property boasts a sitting room, dining room and conservatory offering a generous amount of space to relax with family or entertain guests. Additionally, there is a study and downstairs cloakroom and large kitchen.

Upstairs are three bedrooms, all with built-in cupboards and a family bathroom.

A large driveway with parking for several vehicles ensures plenty of space right on your doorstep and the rear garden provides a private space to enjoy the summer months.

Yalding is a picturesque Kent village at the heart of the village is a beautiful 11th-century church. Other amenities include primary school, two traditional pubs, a teasop, a shop, an award winning post office selling local produce, a library and a doctor's surgery. Yalding lies just North of the larger town of Paddock Wood, which offers a variety of shops, Waitrose supermarket and a mainline station with trains into central London.

Call now to arrange your viewing.

- Extended three bedroom semi detached home
- Sitting room
- Dining room
- Study
- Downstairs cloakroom
- Kitchen
- Conservatory
- Family bathroom
- Driveway
- Quiet residential area



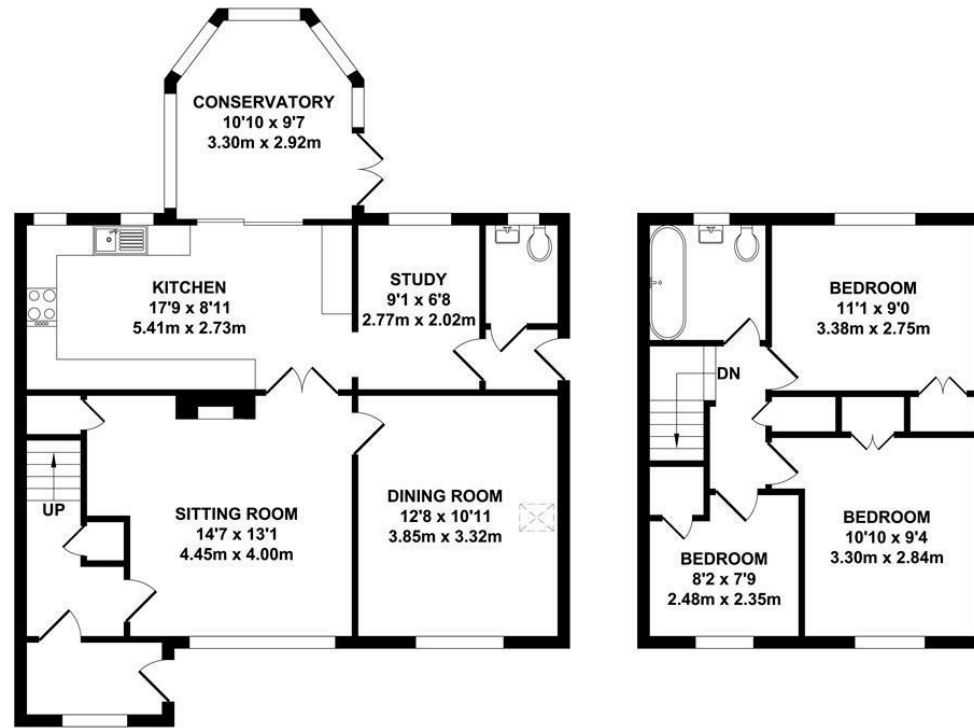

GROUND FLOOR
APPROX. FLOOR AREA
779 SQ.FT.
(72.35 SQ.M.)

FIRST FLOOR
APPROX. FLOOR AREA
398 SQ.FT.
(36.95 SQ.M.)

TOTAL APPROX. FLOOR AREA 1176 SQ.FT. (109.30 SQ.M.)

Whilst every attempt has been made to ensure the accuracy of the floor plan contained here, measurements of doors, windows, rooms and any other items are approximate and no responsibility is taken for any error, omission or mis-statement. This plan is for illustrative purposes only and should be used as such by any prospective purchaser. The services, systems and appliances shown have not been tested and no guarantee as to their operability or efficiency can be given.

Zome Media ©2024

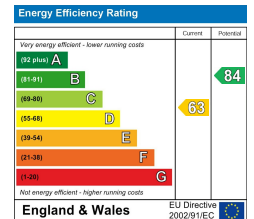





Location Map

Tenure: Freehold

Council tax band: D

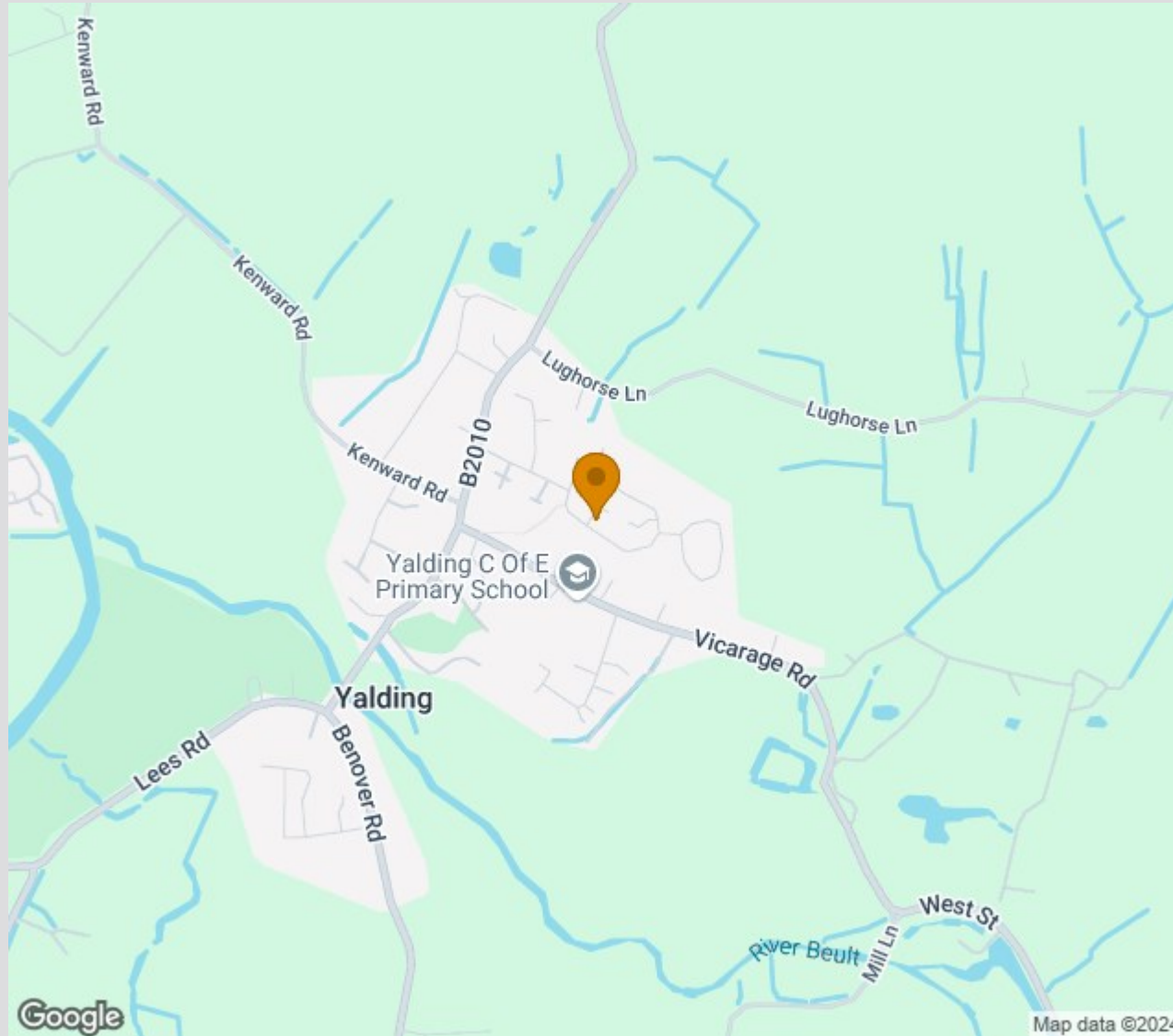

TO VIEW CONTACT:

01892 838 080

countryhomes@khp.me

www.khp.me

