



The Ridings

Paddock Wood TN12 6YA

Offers Over £210,000



COUNTRY HOMES

Paddock Wood TN12 6YA

IDEAL FIRST TIME PURCHASE OR DOWN SIZING
PROPERTY CLOSE TO STATION AND SHOPS.

A well presented ground maisonette, in the ever popular location of Paddock Wood, this property would suit those looking for the first time purchase, or downsizing for convenience.

As you can see from the photographs and floor plan the property offers a bright and spacious accommodation comprising of two double bedrooms, modern fitted kitchen, large reception room and bathroom. Allocated parking space.

Located in a popular residential area and set on this popular road, the property is within walking distance to the shops, train station and primary school at Paddock Wood, this home would suit those needing to be near to the amenities.

This property really is one that has far too much to list and the only way to fully appreciate all that is on offer is to view yourself.

Call now to arrange your appointment.

Notice to buyers the pictures were taken before the current tenancy.

- Cul de sac location
- Ground floor maisonette
- Two double bedrooms
- Reception room with French doors to communal garden
- Close to shops and main line station
- Allocated parking space
- NO CHAIN



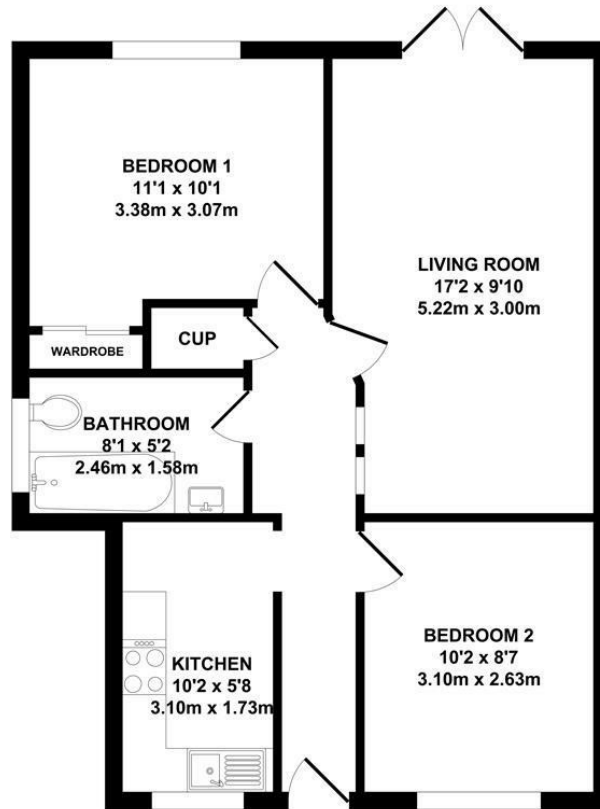

GROUND FLOOR
APPROX. FLOOR AREA
534 SQ.FT.
(49.60 SQ.M.)



TOTAL APPROX. FLOOR AREA 534 SQ.FT. (49.60 SQ.M.)

Whilst every attempt has been made to ensure the accuracy of the floor plan contained here, measurements of doors, windows, rooms and any other items are approximate and no responsibility is taken for any error, omission or mis-statement. This plan is for illustrative purposes only and should be used as such by any prospective purchaser. The services, systems and appliances shown have not been tested and no guarantee as to their operability or efficiency can be given.

Zome Media ©2024

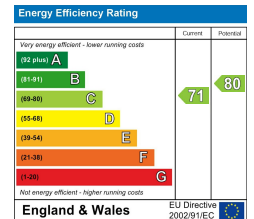

6 Commercial Road, Paddock Wood, Kent, TN12 6EL
01892 838 080
countryhomes@khp.me



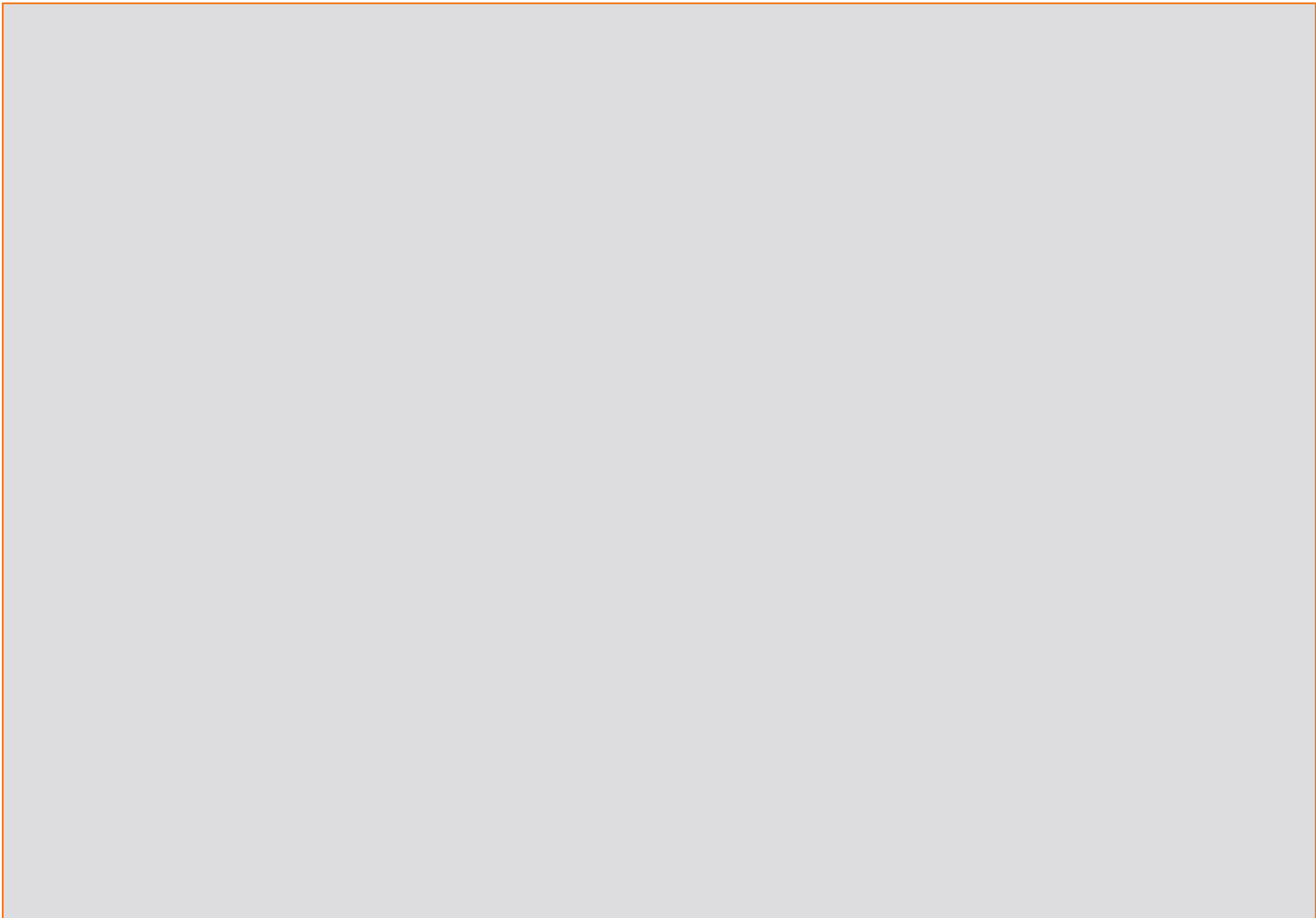

Location Map

Tenure: Leasehold

Council tax band: C



TO VIEW CONTACT:

01892 838 080

countryhomes@khp.me

www.khp.me

