



Wolseley Gardens, W4 3LY
Asking Price £1,450,000

coopers
OF LONDON EST. 1986

Wolseley Gardens, W4

- Stunning four bedroom Victorian home
- Spacious open reception room
- Four large double bedrooms including two en-suite
- Fully fitted kitchen
- Large wine cellar and storage
- Large Rear Garden
- Close to Transport Links
- Nearly 2000 SQFT
- Chain free

Coopers of London are delighted to present this stunning four-bedroom Victorian family home, ideally situated in the highly sought-after Grove Park area.

This well maintained property offers a generous and versatile layout, featuring:

A spacious lounge ideal for family living and entertaining

Four well-proportioned double bedrooms, including two with en-suite shower rooms

A modern family bathroom

A bright, fully fitted kitchen/dining area with direct access to a well-presented enclosed garden

A useful cellar providing additional storage space

Located close to excellent transport links and within the catchment area of several highly rated local schools, this home is perfectly positioned for families and commuters alike.

Early viewings are highly recommended.













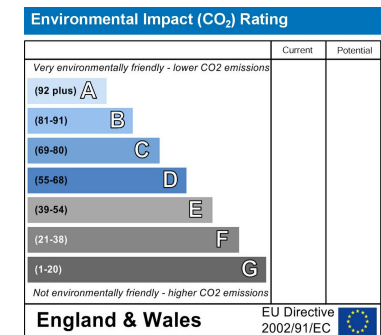
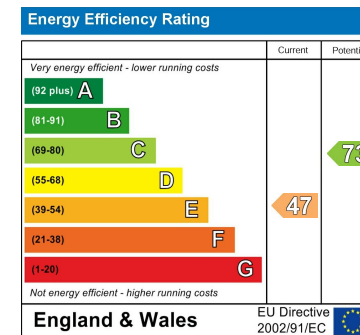
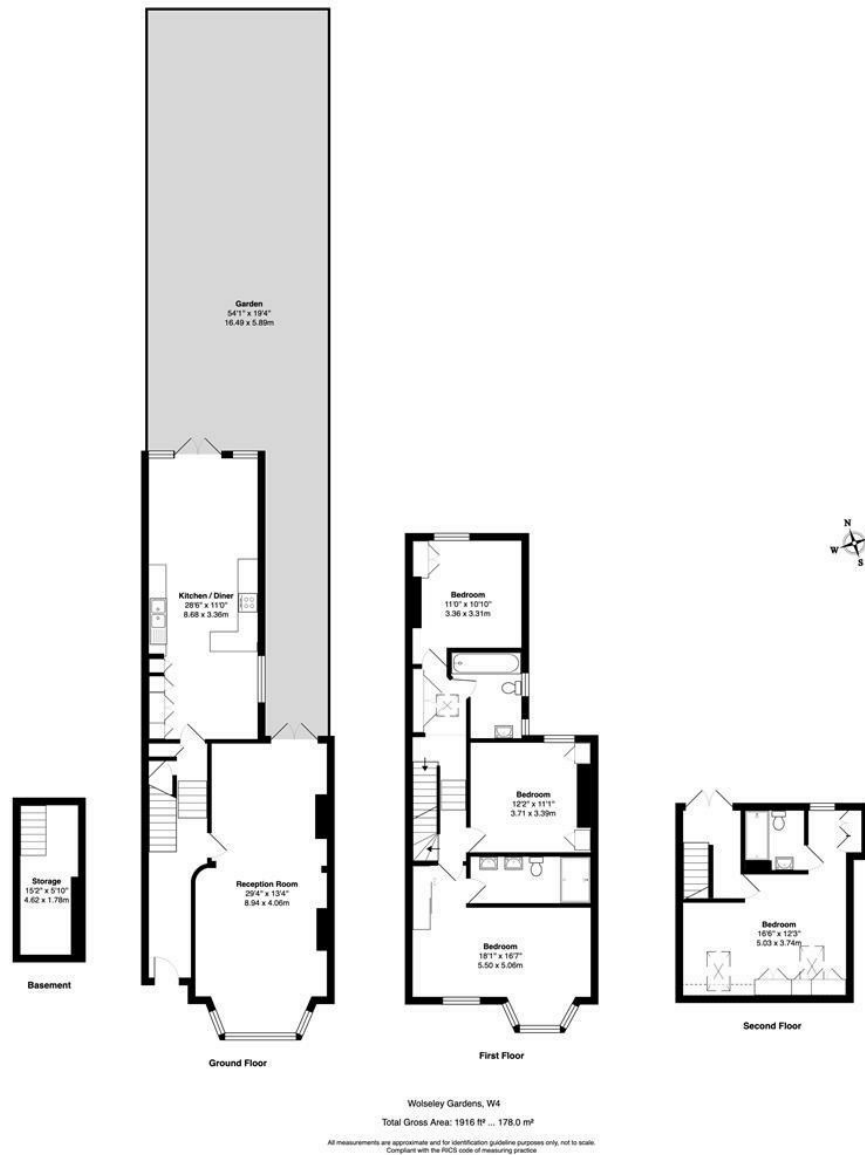

Viewing

Strictly by appointment with:
Coopers of London, 22 Cleveland Street,
Fitzrovia, London W1T 4JB
info@coopersonlondon.co.uk

0207 580 9658

These particulars, whilst believed to be accurate are set out as a general outline only for guidance and do not constitute any part of an offer or contract. Intending purchasers should not rely on them as statements or representation of fact, but must satisfy themselves by inspection or otherwise as to their accuracy. No person in this firm's employment has the authority to make or give any representation or warranty in respect of the property.