



Cambridge Square, W2 2PL
£1,400,000

coopers
OF LONDON EST. 1986

Cambridge Square, W2

- Spacious three bedroom apartment
- Two bathrooms
- Gated complex with gardens throughout
- 24 concierge
- Short walk to Hyde Park and Paddington
- Chain free

Bright and spacious apartment on the third floor of a portered gated complex in the Hyde Park Estate. This property comprises of 3 bedrooms, large reception room, open plan kitchen, two bathrooms (one en-suite).

The Quadrangle is only a short walk to Hyde Park and moments from Paddington station offering unsurpassed local and national travel. Located alongside popular Edgware road providing easy access to a vast array of dining and shopping opportunities.





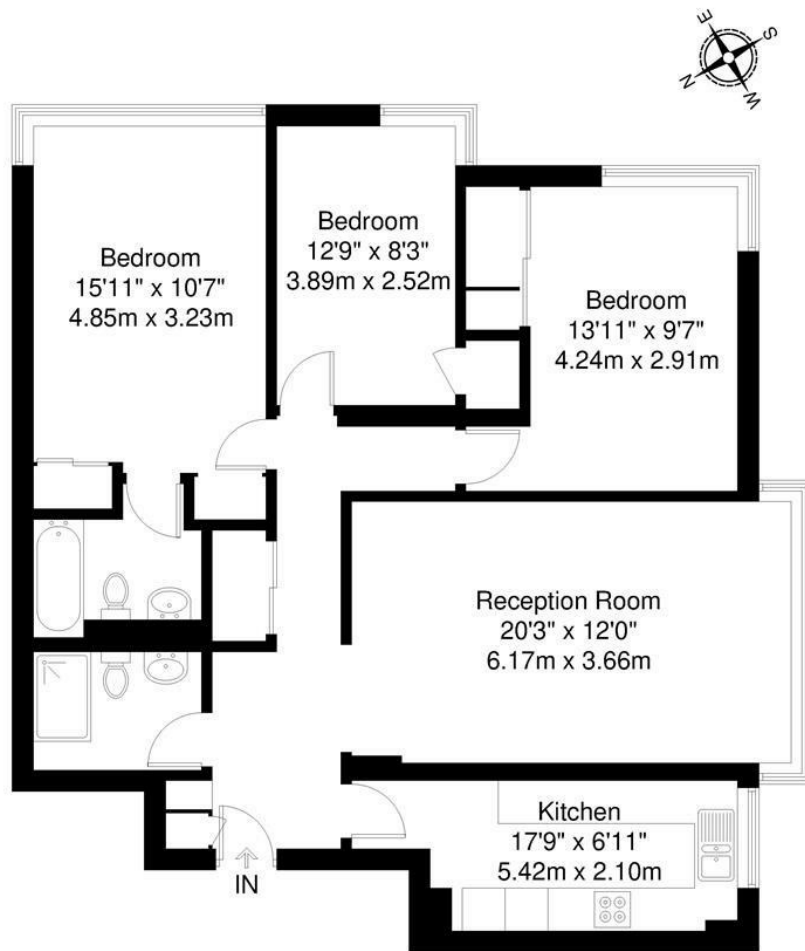

Third Floor

Quadrangle Tower, Cambridge Square, W2

Total Gross Internal Area = 101.7 sq m / 1095 sq ft

All Measurements are approximate and for identification guideline purposes only, not to scale.
Compliant with the RICS code of measuring practice

Energy Efficiency Rating		Current	Potential
Very energy efficient - lower running costs			
(92 plus) A			
(81-91) B			
(69-80) C			
(55-68) D			
(39-54) E			
(21-38) F			
(1-20) G			
Not energy efficient - higher running costs			
England & Wales	EU Directive 2002/91/EC		

Environmental Impact (CO ₂) Rating		Current	Potential
Very environmentally friendly - lower CO ₂ emissions			
(92 plus) A			
(81-91) B			
(69-80) C			
(55-68) D			
(39-54) E			
(21-38) F			
(1-20) G			
Not environmentally friendly - higher CO ₂ emissions			
England & Wales	EU Directive 2002/91/EC		

Viewing

Strictly by appointment with:
Coopers of London, 22 Cleveland Street,
Fitzrovia, London W1T 4JB
info@coopersonlondon.co.uk

0207 580 9658

These particulars, whilst believed to be accurate are set out as a general outline only for guidance and do not constitute any part of an offer or contract. Intending purchasers should not rely on them as statements or representation of fact, but must satisfy themselves by inspection or otherwise as to their accuracy. No person in this firm's employment has the authority to make or give any representation or warranty in respect of the property.