



Finchley Road, NW3 6DH
Asking Price £495,000

coopers
OF LONDON EST. 1986

Finchley Road, NW3

- Quiet, bright apartment
- Share of Freehold
- Newly laid wooden floor
- Close to tube station
- On-Street Parking
- Access to small communal garden
- Suitable for investor or end-user
- Two double bedrooms

Superb two bedroom flat on the second floor of an attractive building on Finchley Road.

Situated at the rear of the building, away from the road, the property is quiet and flooded with natural light. Well suited to an investor or end-user the flat features newly laid wooden floor throughout and access to small communal garden is included.

The property comprises: entrance hallway with storage cupboard, good-sized bathroom, two double bedrooms and open plan kitchen/reception.

The property is a short walk from Finchley Road tube station and on-street permit parking (Camden Council) is available.





Finchley Road, NW3 6DH

Approx. Gross Internal Area = 512 sq ft / 47.6 sq m

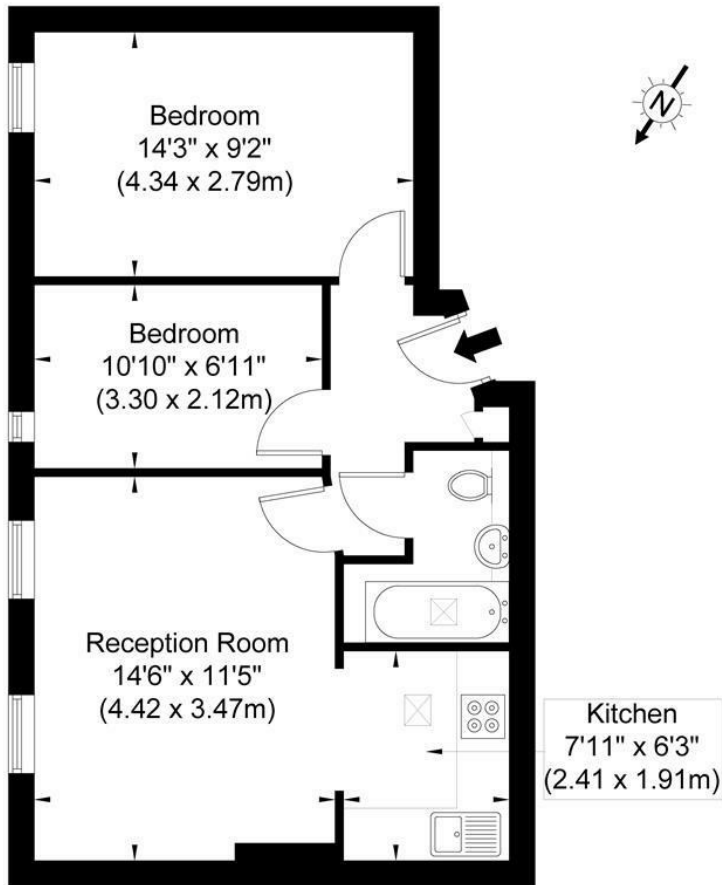

Ref

Copyright THEBLÉUPLAN

Disclaimer : Floor plan measurements are approximate and are for illustrative purposes only
While we do not doubt the floor plan accuracy and completeness, you or your advisors should
conduct a careful, independent investigation of the property in respect of monetary valuation

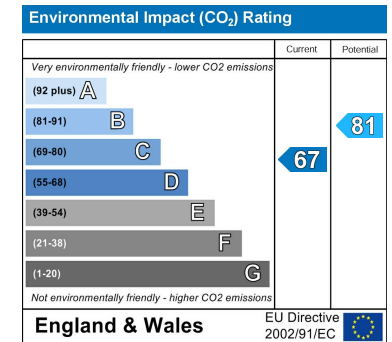
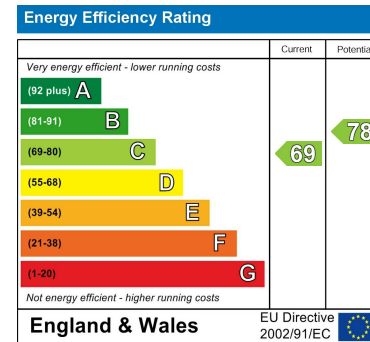

Viewing

Strictly by appointment with:
Coopers of London , 22 Cleveland Street,
Fitzrovia, London W1T 4JB
info@coopersonlondon.co.uk

0207 580 9658

These particulars, whilst believed to be accurate are set out as a general outline only for guidance and do not constitute any part of an offer or contract. Intending purchasers should not rely on them as statements or representation of fact, but must satisfy themselves by inspection or otherwise as to their accuracy. No person in this firms employment has the authority to make or give any representation or warranty in respect of the property.