



HARVEY ROBINSON

Offers In Excess Of
£400,000

Castle Gardens
Kimbolton, PE28 0JE

PROPERTY SUMMARY

Harvey Robinson Estate Agents in St Neots are delighted to be offering for sale this spacious 3/4 bedroom townhouse located in the desirable area of Kimbolton. The property is located within a cul-de-sac location and benefits from off street parking directly in front of the property on the stone laid driveway.

Internally the property is laid out over 3 floors and as such offers versatile and spacious accommodation.





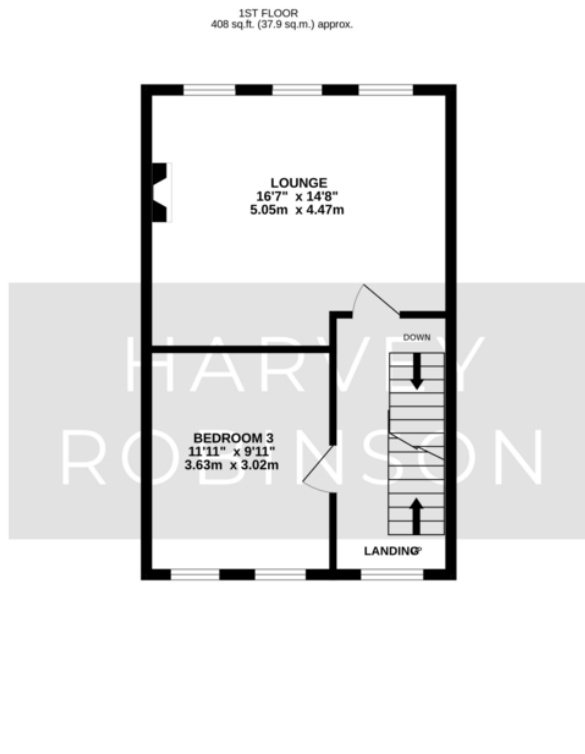
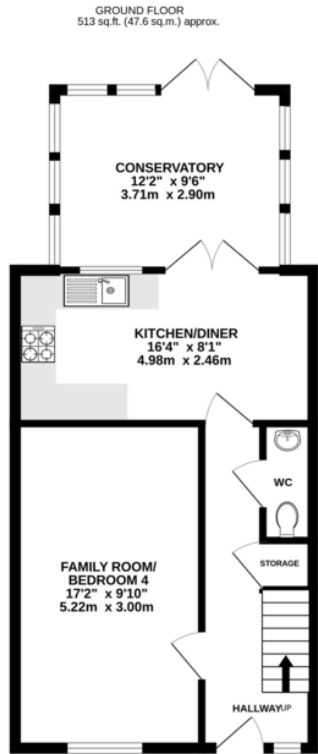

TOTAL FLOOR AREA : 1333 sq.ft. (123.8 sq.m.) approx.
Made with Metropix ©2024

FAQs

Postcode for SatNav: PE28 0JE

What3Words location: ///sofa.crumb.suffix

Council tax: D

Age of property: 1982

Primary catchment: Kimbolton Primary Academy

Secondary catchment: Kimbolton Private School/Hinchingbrooke

Water meter: Yes

Loft: boarded, light and further insulated

Energy Efficiency Rating

	Current	Potential
Very energy efficient - lower running costs		
(92+) A		
(81-91) B		82
(69-80) C		
(55-68) D	60	
(39-54) E		
(21-38) F		
(1-20) G		
Not energy efficient - higher running costs		
England, Scotland & Wales	EU Directive 2002/91/EC	

Agents Note: Whilst every care has been taken to prepare these particulars, they are for guidance purposes only. All measurements are approximate and are for general guidance purposes only and whilst every care has been taken to ensure their accuracy, they should not be relied upon and potential buyers/tenants are advised to recheck the measurements

HARVEY ROBINSON

OFFICE ADDRESS

22 Market Square, St Neots,
Cambridgeshire, PE19 2AF

CONTACT

01480 454040
stneots@harveyrobinson.co.uk
www.harveyrobinson.co.uk