



HARVEY ROBINSON

£415,000

St Peters Lane

Papworth Everard, CB23 3AP

Harvey Robinson estate agents are delighted to offer for sale this immaculately presented, four double bedroom townhouse, located in the popular village of Papworth Everard.

The property offers a generous amount of living accommodation throughout, with the spacious, open-plan lounge/kitchen/dining area on the ground floor providing the wow factor as you enter the property. The first floor comprises of two double bedrooms, and a family bathroom. The principal bedroom, with fitted wardrobes and an en-suite can be found on the second floor, along with the second bedroom and a further en-suite.

Outside, the property benefits from a rear garden which can be accessed from the French doors in the kitchen, and a single garage with power, lighting, a personnel door access from the garden, and a parking space in front. The property is in 'move in' condition, and would make the perfect home for anyone looking for a spacious, modern property in a popular location.





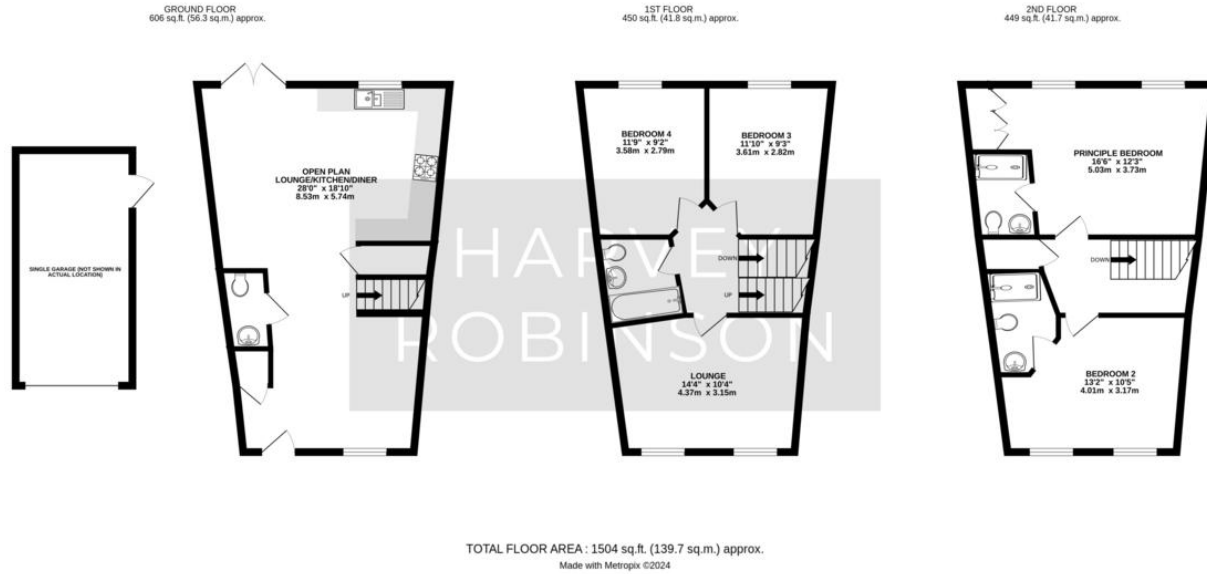

## FAQs

Tenure: Freehold

Estate Management Costs: £112 per 6 months

Built: 2014

Council Tax: Band D

Heating Type: Gas Central Heating

Loft: Partially Boarded

Water Meter: Yes

Primary School Catchment: Pendragon

Secondary School Catchment:

Swavesey Village College

What3Words Location:

///liner.contained.magically

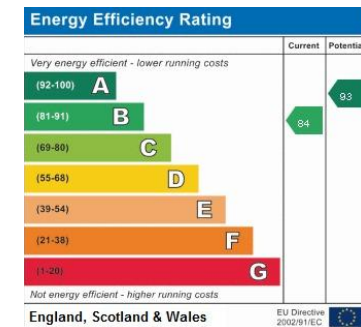

Agents Note: Whilst every care has been taken to prepare these particulars, they are for guidance purposes only. All measurements are approximate and are for general guidance purposes only and whilst every care has been taken to ensure their accuracy, they should not be relied upon and potential buyers/tenants are advised to recheck the measurements

HARVEY ROBINSON

### OFFICE ADDRESS

22 Market Square, St Neots,  
Cambridgeshire, PE19 2AF

### CONTACT

01480 454040  
stneots@harveyrobinson.co.uk  
www.harveyrobinson.co.uk