

Offers In Excess Of
£300,000

North Lodge Drive
Papworth Everard, CB23 3NY

PROPERTY SUMMARY

harveyrobinson estate agents St Neots are pleased to offer for sale this THREE DOUBLE BEDROOM SEMI-DETACHED Family Home, built by David Wilson this is the LARGER 'NORTON DESIGN' of which only a few were built. Located in the popular Village of Papworth Everard which has fantastic transport links via the A428, A14 and A1 providing access to Cambridge, Huntingdon, St Neots and St Ives. Papworth Everard is well serviced with a renowned Primary School filtering into fantastic Secondary Schools in nearby villages. A small parade of shops provides convenience shopping nearby, a post office and a local take-away. The property is located towards the end of the cul-de-sac and comprises of a Lounge/Diner, Kitchen, Cloakroom, Three Double Bedrooms with ENSUITE to MASTER and a Family Bathroom. Outside there is a Rear Garden as well as a GARAGE. NO ONWARD CHAIN. Please contact harveyrobinson estate agents St Neots to arrange a viewing.





2ND FLOOR
279 sq.ft. (26.0 sq.m.) approx.



GROUND FLOOR
402 sq.ft. (37.3 sq.m.) approx.

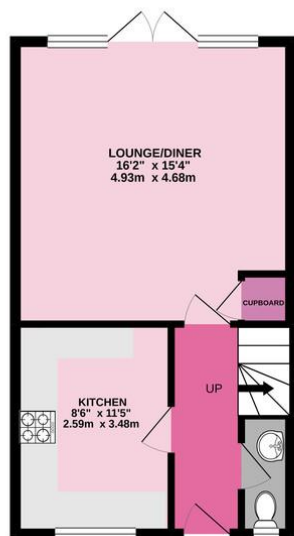

1ST FLOOR
402 sq.ft. (37.3 sq.m.) approx.

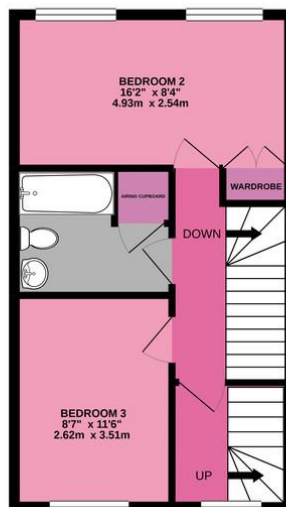

TOTAL FLOOR AREA : 1083 sq.ft. (100.6 sq.m.) approx.
Made with Metropix ©2021

FAQs

Built: 2008

Council Tax: Band D

Garden: South West Facing

Primary School Catchment: Pendragon

Secondary School Catchment: Swavesey

Water Meter: Yes

Loft: Not Boarded

Rent Potential: £1050 TO £1100pcm

Want to know how much your home is worth?
Please contact us to arrange your free Market Appraisal

For free whole of market mortgage advice please call the team to book your appointment.

Agents Note: Whilst every care has been taken to prepare these particulars, they are for guidance purposes only. All measurements are approximate and are for general guidance purposes only and whilst every care has been taken to ensure their accuracy, they should not be relied upon and potential buyers/tenants are advised to recheck the measurements



OFFICE ADDRESS

22 Market Square, St Neots,
Cambridgeshire, PE19 2AF

CONTACT

01480 454040

stneots@harveyrobinson.co.uk

www.harveyrobinson.co.uk