

A photograph of a two-story brick house with a brown tiled roof. The house features a blue front door with a white frame and a small white porch roof. To the left of the door is a white bay window. Several windows are visible on the upper floor. The house is set on a green lawn with a concrete path leading to the door. A small white gate is visible on the right side of the house. In the background, other houses and a blue sky with clouds are visible.

HARVEY ROBINSON

£465,000

Mullein Close

Eaton Ford, PE19 7GX

PROPERTY SUMMARY

Harvey Robinson estate agents in St Neots are pleased to present this stunning four-bedroom detached home situated at the end of a peaceful cul-de-sac in the sought-after Eaton Ford area. The property features a detached double garage with electric doors and off-road parking for four vehicles. Inside, you'll find an entrance hall, a convenient downstairs cloakroom, and a spacious lounge that opens into a versatile conservatory, currently used as a playroom. The owners have modernized the kitchen and knocked through the wall to the dining room, creating a bright and contemporary open-plan kitchen/diner. Upstairs, there are four bedrooms and a family bathroom. The west-facing rear garden is enclosed and enjoys ample sunlight, making it a perfect outdoor space. Immaculately maintained throughout, this property is highly recommended for viewings to truly appreciate its quality.





FAQs

Postcode for SatNav: PE19 7GX

What3Words location: ///ethic.glue.drawn

Property built: 1982

Council tax: D

How long have the owners lived here: Since 2015

Vendors onward movements: Upsizing

Rear boundary responsibility: Left

Garden aspect: West

Primary catchment: Crosshall

Secondary catchment: Longsands/Ernulf

Water meter: Yes- located on driveway

Boiler installed: 2015

Boiler serviced: 2024

Loft: Light, ladder, insulated

EPC to follow.

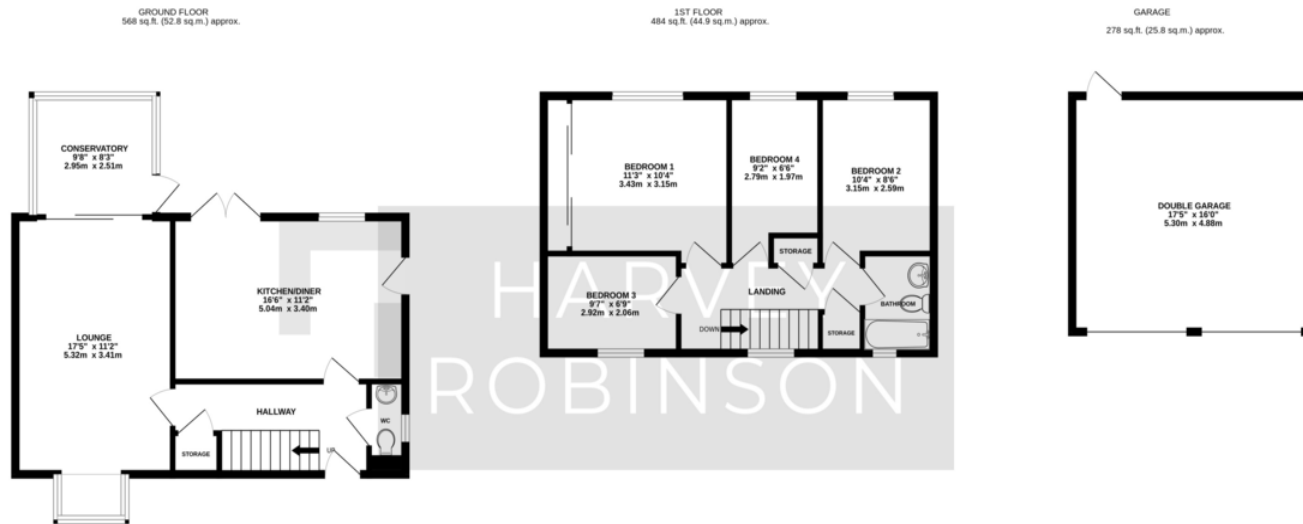

TOTAL FLOOR AREA: 1330 sq.ft. (123.6 sq.m.) approx.
Made with Metropix ©2025

Agents Note: Whilst every care has been taken to prepare these particulars, they are for guidance purposes only. All measurements are approximate and are for general guidance purposes only and whilst every care has been taken to ensure their accuracy, they should not be relied upon and potential buyers/tenants are advised to recheck the measurements

HARVEY ROBINSON

OFFICE ADDRESS

22 Market Square, St Neots,
Cambridgeshire, PE19 2AF

CONTACT

01480 454040
stneots@harveyrobinson.co.uk
www.harveyrobinson.co.uk