



HARVEY ROBINSON

Offers In Excess Of  
**£365,000**  
Ridgeway  
Perry, PE28 0BL

## PROPERTY SUMMARY

Harvey Robinson estate agents in St Neots are delighted to offer for-sale this extended two double bedroom detached bungalow located in the popular village of Perry, one of the highlights of this property are the stunning views over Grafham Water. The accommodation comprises an entrance hall, kitchen/diner, lounge, garden room, family bathroom, two bedrooms, one of which has a dressing room/walk in wardrobe and an en-suite shower room. Outside the property there are well maintained gardens, off road parking, and a large garage which provides additional parking or could be converted to create further living accommodation (subject to planning). Please contact our St Neots branch in order to arrange a viewing.





GROUND FLOOR  
1143 sq.ft. (106.1 sq.m.) approx.

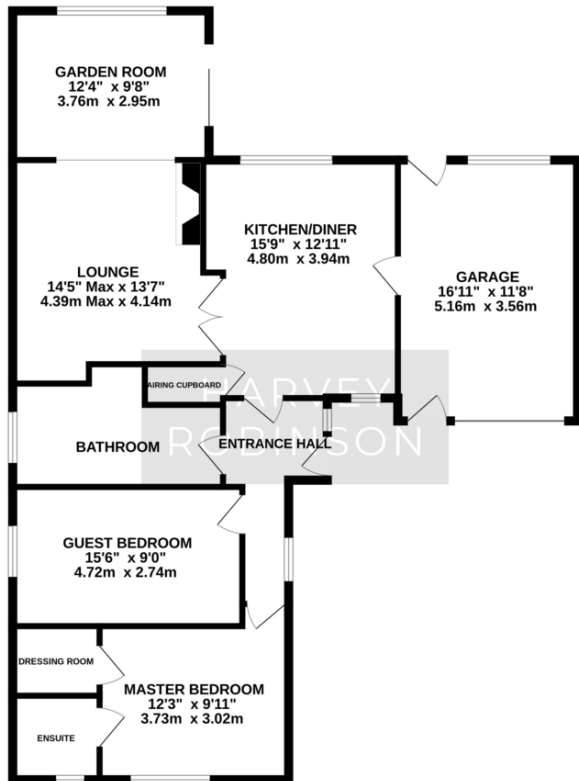

TOTAL FLOOR AREA: 1143 sq.ft. (106.1 sq.m.) approx.  
Made with Metroplan ©2024

## FAQs

Postcode for SatNav: PE28 0BL

What3Words Location: ///cocktail.troll.surreal

Council tax: C

How long have the owners lived here: 18 years

Water meter: No

Primary school catchment: Great Staughton

Secondary school catchment: Hinchingsbrooke

Vendors onward movements: Will be purchasing a property

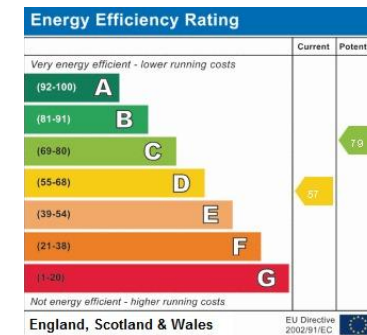

Agents Note: Whilst every care has been taken to prepare these particulars, they are for guidance purposes only. All measurements are approximate and are for general guidance purposes only and whilst every care has been taken to ensure their accuracy, they should not be relied upon and potential buyers/tenants are advised to recheck the measurements

HARVEY ROBINSON

### OFFICE ADDRESS

22 Market Square, St Neots,  
Cambridgeshire, PE19 2AF

### CONTACT

01480 454040  
stneots@harveyrobinson.co.uk  
www.harveyrobinson.co.uk