

A three-story brick house with a grey gabled roof and two dormer windows. The main facade is light-colored brick, with a prominent blue vertical section on the left side containing a balcony with a black metal railing, a large window, and a blue door. A paved driveway leads from the foreground towards the house. The property is surrounded by green grass and trees under a blue sky with scattered clouds.

HARVEY ROBINSON

£500,000

10 Daffodil Close

Eynesbury, PE19 2LJ

PROPERTY SUMMARY

Harvey Robinson estate agents in St Neots are proud to be marketing this premium five bedroom detached family home located on the well-regarded development of Knights Park, Eynesbury.

Accommodation is set over three floors, to the ground floor there is a spacious living/dining room, study, well presented kitchen/breakfast room and WC with access to the rear garden via the living room and kitchen. To the first floor is the master bedroom with wardrobe section and ensuite shower room, bedroom two which also benefits from an ensuite shower room, bedroom five and a family bathroom. To the top floor there are two further double bedrooms with a further shower room and stunning views over pocket park and the river. Externally there is a well-presented and established rear garden, single garage with an up and over door and access via the rear garden, off street parking for multiple vehicles and a lovely front garden with green and private tree views.

5 

4 

2 





FAQs

Type Here

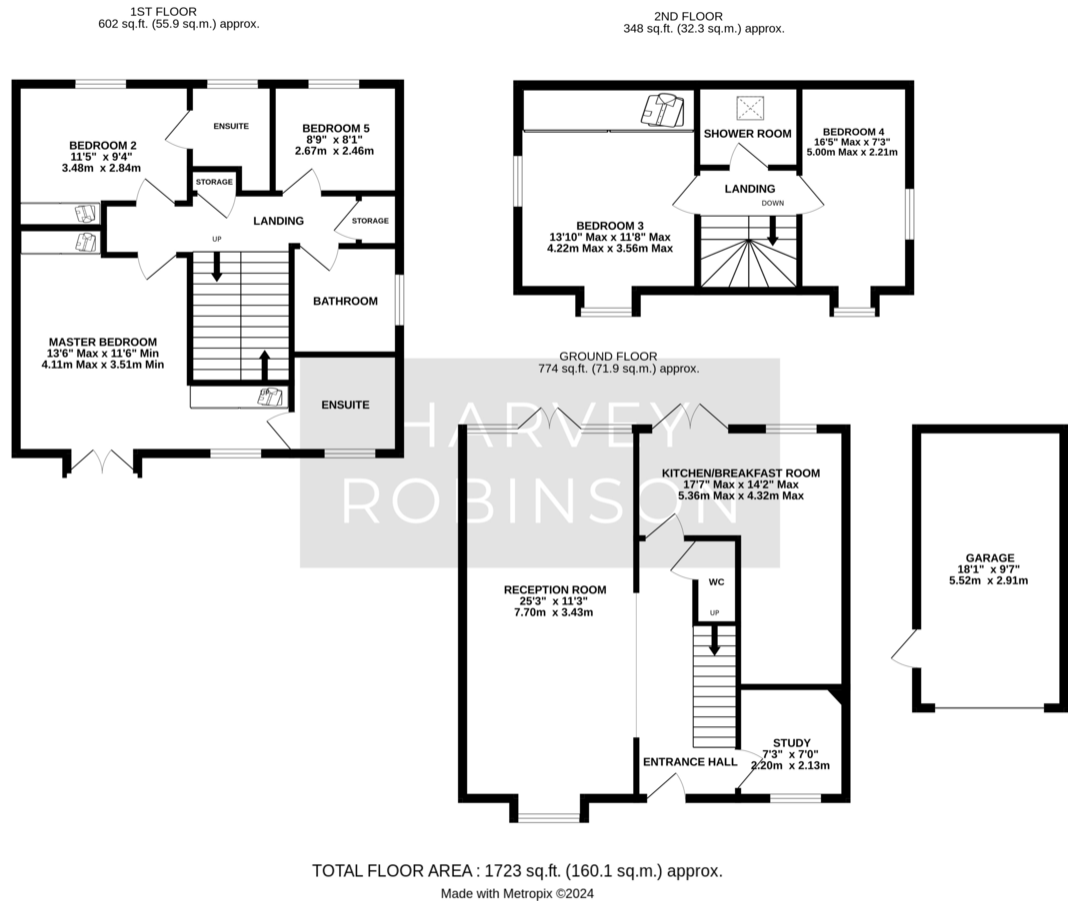

Energy Efficiency Rating			
Score	Energy rating	Current	Potential
92+	A		
81-91	B		87 B
69-80	C	79 C	
55-68	D		
39-54	E		
21-38	F		
1-20	G		

Agents Note: Whilst every care has been taken to prepare these particulars, they are for guidance purposes only. All measurements are approximate and are for general guidance purposes only and whilst every care has been taken to ensure their accuracy, they should not be relied upon and potential buyers/tenants are advised to recheck the measurements

HARVEY ROBINSON

OFFICE ADDRESS

22 Market Square, St Neots,
Cambridgeshire, PE19 2AF

CONTACT

01480 454040
stneots@harveyrobinson.co.uk
www.harveyrobinson.co.uk