



HARVEY ROBINSON

Offers In Excess Of
£180,000

30 North Lodge Drive
Papworth Everard, CB23 3NY

PROPERTY SUMMARY

Harvey Robinson estate agents in St Neots are delighted to be marketing this well presented two-bedroom second floor (Top Floor) apartment in Papworth Everard, this would be the perfect first-time or investment purchase. The property benefits from a spacious entrance hall, a large open-plan lounge/kitchen/diner, two double bedrooms, an en-suite shower room and a bathroom. Outside the property there is an allocated parking space and visitor parking. Please contact our St Neots branch to arrange an appointment to view.





FAQs

Type Here

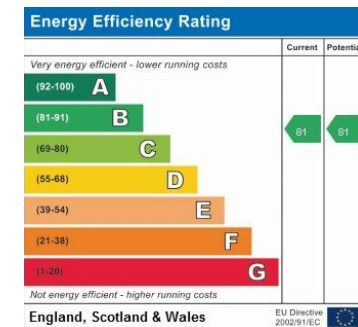
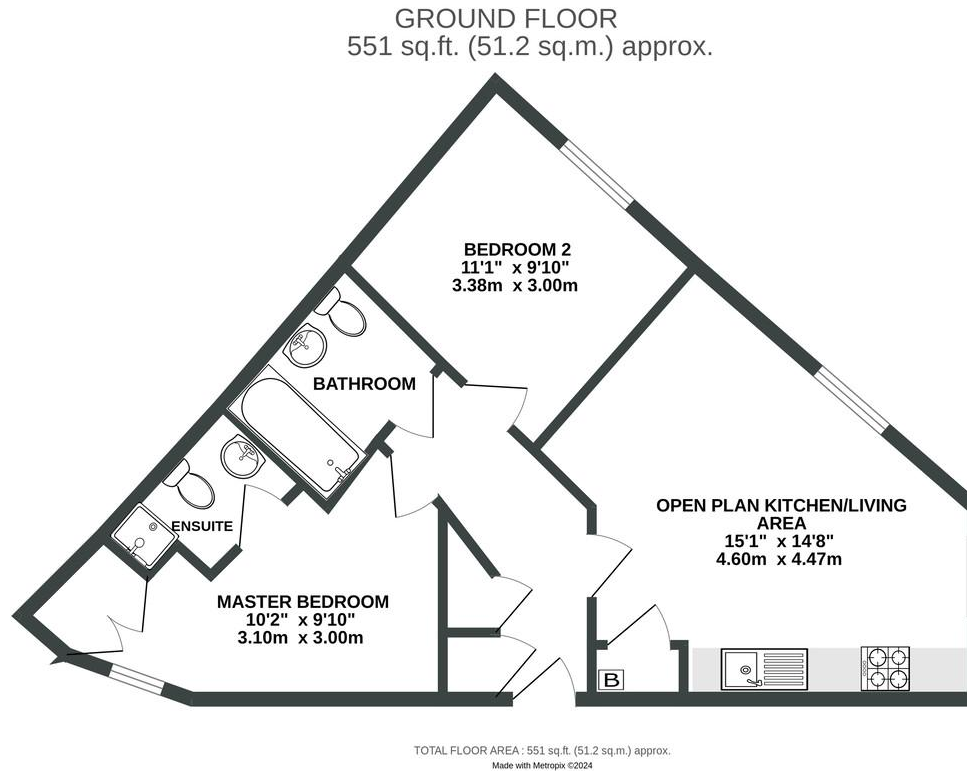

Agents Note: Whilst every care has been taken to prepare these particulars, they are for guidance purposes only. All measurements are approximate and are for general guidance purposes only and whilst every care has been taken to ensure their accuracy, they should not be relied upon and potential buyers/tenants are advised to recheck the measurements

HARVEY ROBINSON

OFFICE ADDRESS

22 Market Square, St Neots,
Cambridgeshire, PE19 2AF

CONTACT

01480 454040
stneots@harveyrobinson.co.uk
www.harveyrobinson.co.uk