

A photograph of a two-story brick house with a gabled roof and a paved driveway. The house has several white-framed windows and a white front door. A lawn is visible to the left of the driveway. The sky is blue with scattered white clouds. A dark grey banner with white text is in the top right corner, and another dark grey banner with white text is in the bottom left corner.

HARVEY ROBINSON

Offers In Excess Of
£600,000

17 Meadow Way
Great Paxton, PE19 6RR

PROPERTY SUMMARY

Harvey Robinson estate agents in St Neots are delighted to be marketing this extended and much improved five bedroom detached home located in the popular village of Great Paxton. The property was extended in 2020 to create an additional family room and master bedroom with a spacious en-suite. The accommodation now comprises of an entrance hall, cloakroom, lounge, dining room, 28ft kitchen/breakfast room, and an 18ft family room to the ground floor. To the first floor there are five bedrooms, a family bathroom, and en-suite. Outside the property has a large block paved driveway providing off-road parking for several vehicles and a private split level rear garden that has been recently landscaped. This property would make an ideal family home and viewings can be arranged by contacting our St Neots branch.





GROUND FLOOR
1004 sq.ft. (93.3 sq.m.) approx.

1ST FLOOR
792 sq.ft. (73.5 sq.m.) approx.

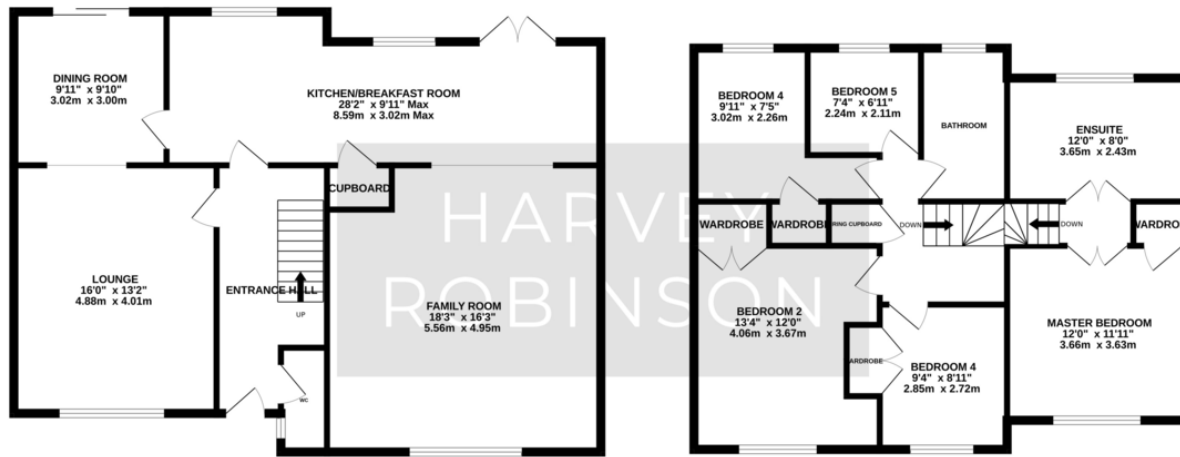

TOTAL FLOOR AREA : 1796 sq.ft. (166.8 sq.m.) approx.
Made with Metropix ©2024

FAQs

Postcode for SatNav: PE19 6RR

What3Words location:

///shortens.reminder.hound

Age of property: 1970's

Council tax: D

How long have the owners lived here: 9 years

Reason for moving: To be closer to children's school

Garden aspect: East

Rear boundary fence responsibility: Right and rear (with back to the property)

Primary catchment: Great Paxton

Secondary catchment: Hinchinglee

Water meter: No

Boiler installed: 2020

Loft: light, boarded and ladder

Agents Note: Whilst every care has been taken to prepare these particulars, they are for guidance purposes only. All measurements are approximate and are for general guidance purposes only and whilst every care has been taken to ensure their accuracy, they should not be relied upon and potential buyers/tenants are advised to recheck the measurements

HARVEY ROBINSON

OFFICE ADDRESS

22 Market Square, St Neots,
Cambridgeshire, PE19 2AF

CONTACT

01480 454040
stneots@harveyrobinson.co.uk
www.harveyrobinson.co.uk