



HARVEY ROBINSON

Offers In Excess Of
£315,000
8 St Johns Lane
Papworth Everard, CB23 3AT

PROPERTY SUMMARY

Harvey Robinson estate agents in St Neots are delighted to offer for sale this three bedroom semi detached home in the sought after village of Papworth Everard.

The ground floor accommodation consists of an entrance hall, downstairs cloakroom, a bright lounge and a kitchen/ diner with UPVC doors leading out into the garden. Upstairs you will find three bedrooms and a bathroom. Bedroom one boasts an en-suite shower room. To the rear of the property you will find an enclosed garden with a patio and lawn. A garage which includes power and off road parking can be found to the front.

Viewing is highly recommended, to arrange an appointment please contact our St Neots office on 01480 454040 opt 2.

3 

2 

1 





GROUND FLOOR
397 sq.ft. (36.9 sq.m.) approx.

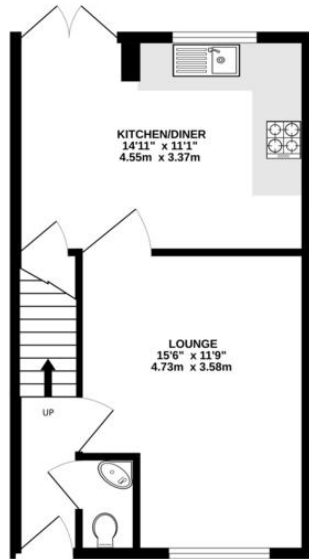

1ST FLOOR
399 sq.ft. (37.1 sq.m.) approx.

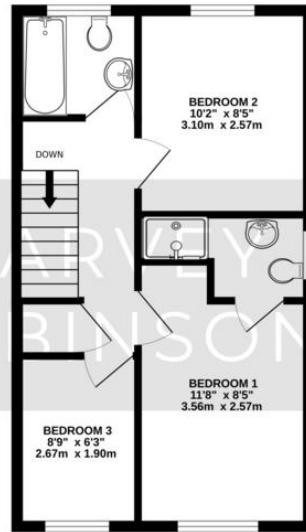

2ND FLOOR
143 sq.ft. (13.3 sq.m.) approx.

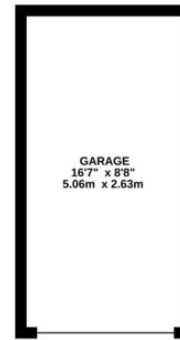

HARVEY
ROBINSON

TOTAL FLOOR AREA: 939 sq.ft. (87.3 sq.m.) approx.
Made with MetroPix ©2024

FAQs

Tenure: Freehold

Built: 2015

How Long Have the Owners Lived Here: Since New

Vendors Onward Movements: Upsizing Locally

Council Tax: Band C

Boiler: Installed 2019

Age of UPVC windows: 2019

Primary School Catchment: Pendragon

Secondary School Catchment: Swavesey

What3Words Location:

///demand.dictation.diets

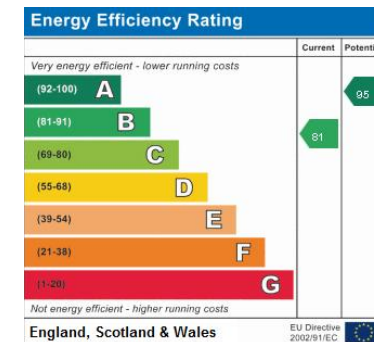

Agents Note: Whilst every care has been taken to prepare these particulars, they are for guidance purposes only. All measurements are approximate and are for general guidance purposes only and whilst every care has been taken to ensure their accuracy, they should not be relied upon and potential buyers/tenants are advised to recheck the measurements

HARVEY ROBINSON

OFFICE ADDRESS

22 Market Square, St Neots,
Cambridgeshire, PE19 2AF

CONTACT

01480 454040
stneots@harveyrobinson.co.uk
www.harveyrobinson.co.uk