



Tye Hill Close
Trewoon
St. Austell
PL25 5SG

Asking Price £525,000

- NO CHAIN
- BEAUTIFULLY PRESENTED BUNGALOW
- WELL STOCKED MATURE GARDENS
 - DOUBLE GARAGE
 - POTENTIAL FOR ANNEXE
 - SET IN QUIET LANE
- CLOSE TO VILLAGE CENTRE
- SPACIOUS ACCOMMODATION
 - MAIN ENSUITE BEDROOM
- SCAN QR CODE FOR MATERIAL INFORMATION



 **Millerson**
millerson.com

Tenure - Freehold

Council Tax Band - D

Floor Area - 1248.00 sq ft



3



2



1



C77

Property

This is a beautifully presented individual bungalow built in 2018 offering spacious accommodation which briefly comprises large reception hall, spacious sitting room, open plan Kitchen/diner, main bedroom with ensuite, two further double bedrooms, well appointed family bathroom, and utility room. The property has a large integral double garage and subject to the necessary permissions be incorporated to create a large independent annexe for dependant relative.

There is well established garden with summer house and lawn area and lovely decked area, ideal for outside entertainment.

Location

Trewoon is a popular village with a number of local facilities including village hall, hairdressers, fish and fish chip shop, village shop/post office and public house. St Austell main town is but a few miles away and offers an extensive range of shops, schools and local business and a main line railway station.

Large reception hall

With composite front door and inset leaded glazed panels, panelled radiator, access to fully boarded loft space with power and light and folding ladder, window to side, smoke detector, Upvc door leading to side garden.

Kitchen/Breakfast room

22'4" x 11'3" (6.83m x 3.43m)

A bright room with dual aspect front and rear, double radiator, extensive range of cream/white kitchen units with wood block effect worktops, high level wall units, space and plumbing for washing machine, breakfast bar, one and half bowl sink unit space for American style fridge/freezer, door through to:

Living room

22'6" x 12'5" (6.86m x 3.81m)

Another bright and spacious triple aspect room with impressive fire place housing wood burning stove, sliding patio doors to front patio, two double panelled radiators, wall light points.

Main Bedroom

12'7" x 12'5" (3.86m x 3.81m)

Double radiator, patio doors to side garden, window to rear, built in wardrobe, door to:

Ensuite Bathroom

12'7" x 4'1" (3.84m x 1.27m)

Window to rear, part tiled walls, low level WC, wash basin with mixer taps, panelled bath with shower screen, Triton shower above, towel rail, wall light points.

Utility Room

10'0" x 4'9" (3.05m x 1.45m)

Wall mounted Baxi Boiler, space and plumbing for washing machine, wall mounted units, extractor fan, sink unit, space for tumble dryer and large cupboard, (possible access into Garage).

Bedroom Two

14'4" x 9'6" (4.39m x 2.90m)

Large wardrobe with mirror doors, double panelled radiator, window to rear elevation.

Bedroom Three

10'0" x 9'6" (3.05m x 2.92m)

Window to side and panelled radiator.

Family Bathroom

10'2" x 8'2" (3.12m x 2.49m)

With partially tiled walls, claw foot semi roll topped bath with Victorian shower mixer, low level WC, pedestal wash basin, tiled floor, extractor fan, wall light points, shaver socket with shaver socket, large double shower unit with screen, TV bracket.

Garage

23'7" x 20'0" (7.19m x 6.10m)

Remote electric up and over door and further up and over door, power and light, window to side and pedestrian door to garden plumbing for central heating, drainage connected and access to loft space.



Outside

The property is approached via a small lane , gravelled driveway in front of double garage, outside water tap, courtesy lights. To the front is a well established landscaped garden with wood bark chippings, ornamental pond, various planted ferns and palms. Timber decking to front wrapping around the side with ideal barbecue area, ideal for alfresco dining leading around to rear garden with wide gravelled path leading around to the private side garden with large lawn area, lovely summer house, 3m x 2.5m, mature tress and discreetly located LPG tanks for central heating..

Services

Mains Drainage, Water, Electricity, LPG gas central heating. Council Tax band 'D'

Material Information

Verified Material Information

Council tax band: D

Council tax annual charge: £2342.54 a year (£195.21 a month)

Property construction: Standard form

Number and types of room: 3 bedrooms, 2 bathrooms, 1 reception

Electricity supply: Mains electricity

Solar Panels: No

Other electricity sources: No

Water supply: Mains water supply

Sewerage: Mains

Heating: Central heating

Heating features: None

Broadband: FTTC (Fibre to the Cabinet)

Mobile coverage: O2 - Excellent, Vodafone - Excellent, Three - Excellent, EE - Excellent

Parking: Off Street





Tye Hill Close, Trewoon, St. Austell, PL25 5SG

Building safety issues: No
Restrictions - Listed Building: No
Restrictions - Conservation Area: No
Restrictions - Tree Preservation Orders: None
Public right of way: No
Long-term flood risk: No
Coastal erosion risk: No
Planning permission issues: No
Accessibility and adaptations: None
Coal mining area: No
Non-coal mining area: Yes
Energy Performance rating: C
All information is provided without warranty. Contains
HM Land Registry data © Crown copyright and database
right 2021. This data is licensed under the Open
Government Licence v3.0.
The information contained is intended to help you decide
whether the property is suitable for you. You should
verify any answers which are important to you with your
property lawyer or surveyor or ask for quotes from the
appropriate trade experts: builder, plumber, electrician,
damp, and timber expert.



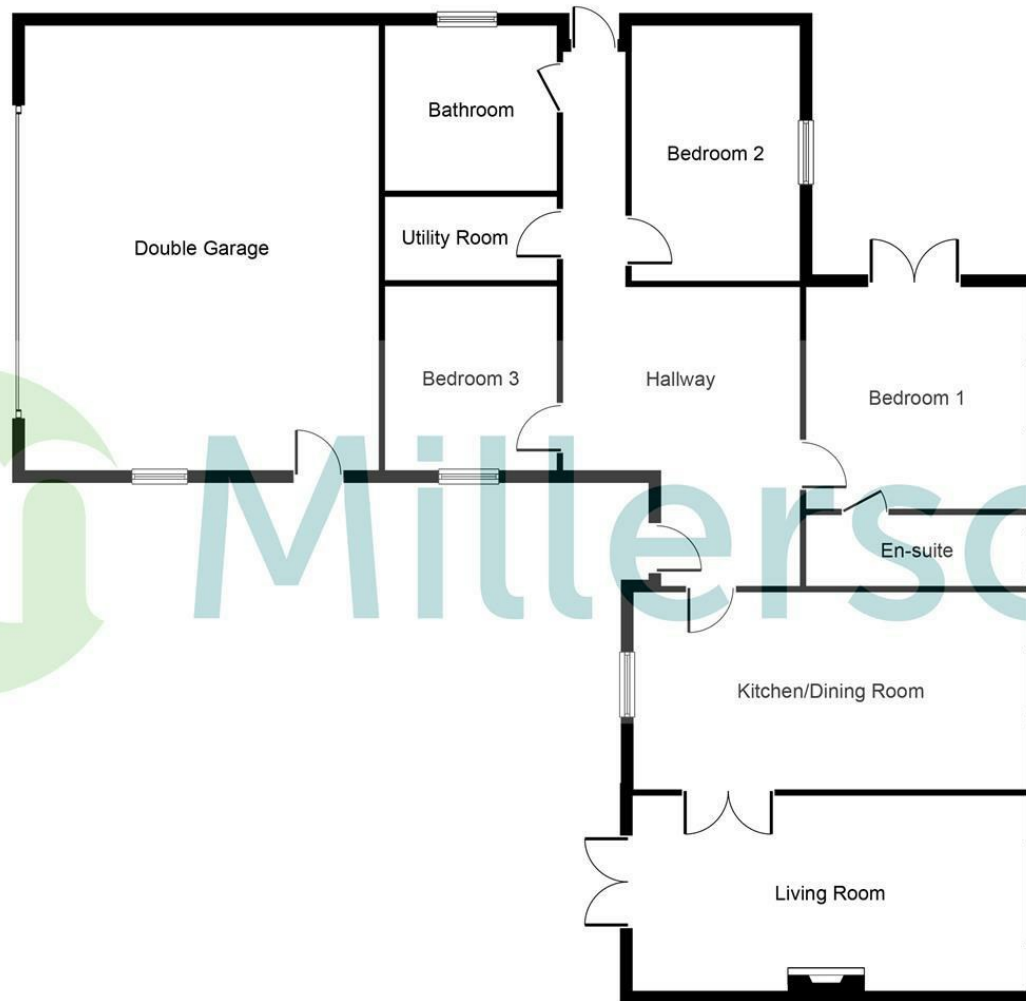

PLEASE NOTE, THIS FLOOR PLAN IS INTENDED FOR ILLUSTRATIVE PURPOSES ONLY. NO MEASUREMENT HAVE BEEN TAKEN AND IT IS NOT TO SCALE.
Copyright V360 Ltd 2023 | www.houseviz.com

Energy Efficiency Rating		
	Current	Potential
Very energy efficient - lower running costs		
(92 plus) A		88
(81-91) B	77	
(69-80) C		
(55-68) D		
(39-54) E		
(21-38) F		
(1-20) G		
Not energy efficient - higher running costs		
England & Wales <small>EU Directive 2002/91/EC</small>		

Buying To Rent Out?

Are You....

- A First Time Landlord Looking For Advice
- A Current Landlord Looking To Change Agents
- Looking For Lettings Legal Advice Or
- Wanting To Know The Yield On This Property

Please Speak to Our Lettings Area Manager

Lizzie Collins

01726 72236

ecollins@millerson.com

Contact Us

5-6 Market Street

St Austell

Cornwall

PL25 4BB

E: st.austell@millerson.com

T: 01726 72289

www.millerson.com

Scan QR For Material
Information



Scan
me!

 **Millerson**
millerson.com