



Hartley Brook Avenue, Sheffield, S5 0HL

Offers Over £120,000

2 1 1



Why You'll Love It

Stepping inside, you're welcomed by a bright lounge with a feature alcove and a large window that fills the room with natural light. The kitchen is generously sized with plenty of cabinet space, worktops, and room for a dining area. Upstairs, two good-sized bedrooms provide flexibility, whether as bedrooms, a home office, or hobby spaces. The family bathroom includes a bath with overhead shower, wash basin, and WC.

The rear garden is fully enclosed, offering a private outdoor retreat with space for both play and entertaining. To the front, the home benefits from a driveway for off-road parking.

Why We Love It

Hartley Brook Avenue sits in a convenient position with excellent access to local shops, schools, and green spaces. The Northern General Hospital is just a short drive away, and there are superb transport links into the city centre, Meadowhall, and the motorway network. With parks, playing fields, and local amenities all within easy reach, it's a location that balances practicality with a welcoming community feel.



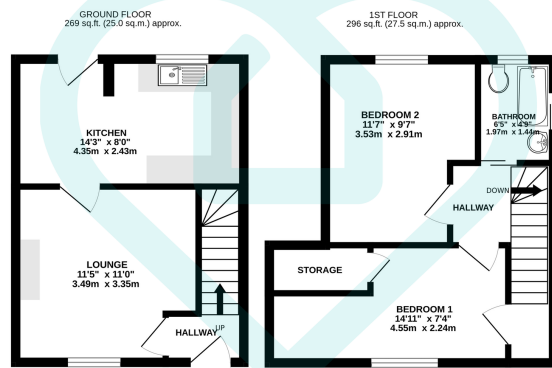

TOTAL FLOOR AREA : 565 sq.ft. (52.5 sq.m.) approx.

This floor plan is for illustrative purposes only. All measurements and layouts are approximations and do not necessarily capture the precise specifications of the property. No responsibility is taken for any error, omission, or misstatement. We always recommend viewing in person to confirm the exact floor plan of a property. Made with Metropix.



- Two Generous Bedrooms
- Bright And Spacious Lounge
- Fitted Kitchen With Dining Space
- Three-Piece Family Bathroom Suite
- Enclosed Rear Garden
- Driveway Parking To The Front
- Ideal For First-Time Buyers Or Investors
- Popular Location With Excellent Transport Links
- Amenities Close By
- Good Range of Schools Near By

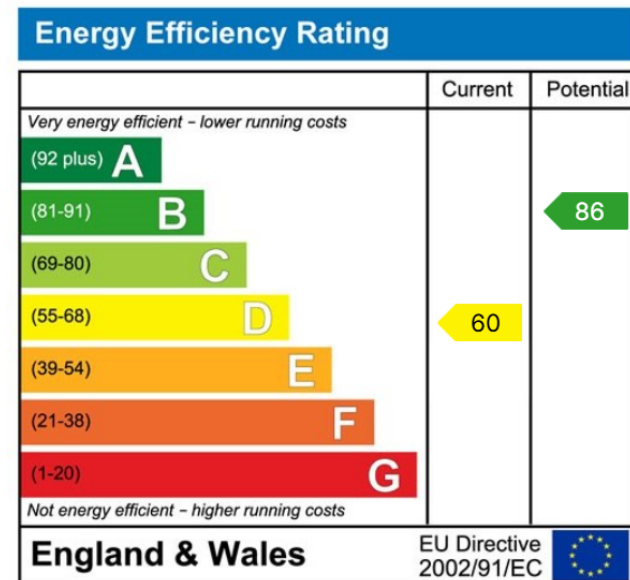

Sales | Lettings | New Homes

VAT Reg Number: 191 3588 84
Company Reg Number: 08610489
Company Reg Address: 67 Middlewood Road, Hillsborough, Sheffield, S6 4GX.

The MorfittSmith Building
67 Middlewood Road
Hillsborough
Sheffield
S6 4GX

Get in touch - arrange an appointment



0114 232 1764



sales@morfittsmith.co.uk
lettings@morfittsmith.co.uk
newhomes@morfittsmith.co.uk



www.morfittsmith.co.uk



@MorfittSmith



@MorfittSmith



MorfittSmith
Estate & Letting Agent