



Findon Street, Sheffield, S6 4QN

Guide Price £200,000

3 1 2



Why We Love It

Prime position close to Hillsborough Park, Malin Bridge, and the fantastic amenities of Hillsborough. With regular bus and tram links, excellent schools, and easy access to the Peak District, this is a location that perfectly blends convenience with lifestyle.

Why You'll Love It

The ground floor welcomes you with a bright living room featuring a bay window, neutral décor, and plenty of space for seating. To the rear, the dining area flows into a modern kitchen fitted with shaker-style units, tiled splashbacks, and integrated cooking space, creating a sociable setting for meals and entertaining.

Upstairs, the first floor hosts a generous primary bedroom with plenty of natural light, alongside a second bedroom ideal for children, guests, or a home office. The family bathroom includes a three-piece suite with a shower over bath.

The second floor attic room is a superb additional space, perfect as a third bedroom, hobby room, or study, complete with a skylight for extra light.

The property also benefits from a cellar, offering valuable storage or potential to be used as a workshop.

To the rear is a private yard, an easy-to-maintain outdoor area ideal for a morning coffee or evening relaxation.



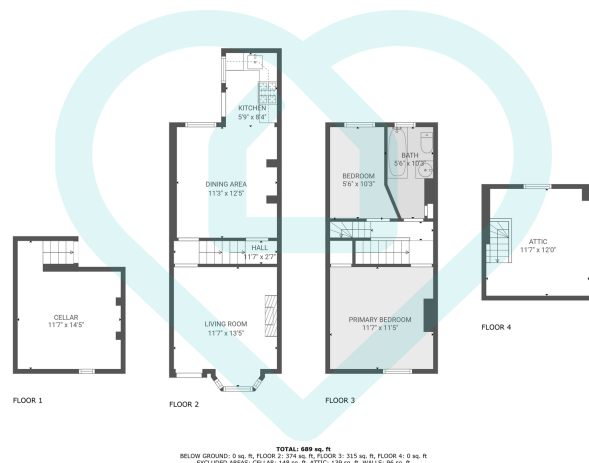

This floor plan is for illustrative purposes only. All measurements and layouts are approximations and do not necessarily capture the precise specifications of the property. No responsibility is taken for any error, omission, or misstatement. We always recommend viewing in person to confirm the exact floor plan of a property. Made with Metropix.



- Stone-Fronted Mid-Terrace Home
- Modern Kitchen & Dining Area
- Family Bathroom With Shower Over Bath
- Private Rear Yard
- Excellent Public Transport Links
- Spacious Living Room With Bay Window
- Two Bedrooms Plus Attic Room
- Useful Cellar For Storage Or Workshop
- Popular Location Close To Hillsborough Park
- Ideal For First-Time Buyers Or Investors

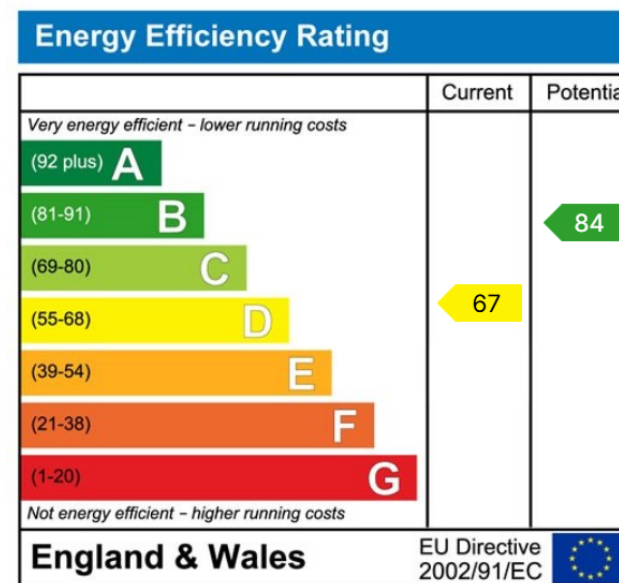

Sales | Lettings | New Homes

VAT Reg Number: 191 3588 84
Company Reg Number: 08610489
Company Reg Address: 67 Middlewood Road, Hillsborough, Sheffield, S6 4GX.

The MorfittSmith Building
67 Middlewood Road
Hillsborough
Sheffield
S6 4GX

Get in touch - arrange an appointment



0114 232 1764



sales@morfittsmith.co.uk
lettings@morfittsmith.co.uk
newhomes@morfittsmith.co.uk



www.morfittsmith.co.uk



@MorfittSmith



@MorfittSmith



MorfittSmith
Estate & Letting Agent