



424 Loxley Road,
Offers In Region Of £310,000

3 1 0



Why We Love It

Loxley Road places you in a highly desirable spot on the edge of Hillsborough, giving you the best of both worlds: the convenience of local shops, schools, and transport links, alongside access to stunning countryside walks and green spaces. The area has an appealing village feel, yet you're just a short journey from Sheffield City Centre and the Peak District.

Why You'll Love It

Step inside and you'll find a warm and inviting home with an excellent layout for family living. The lounge is bathed in natural light thanks to its bay window, offering a welcoming retreat with garden views. The kitchen diner is a real highlight, beautifully finished with modern cabinets, sleek worktops, and space for a family dining table, perfect for gatherings.

The adjoining utility room provides additional practicality, keeping household tasks neatly out of sight.

Upstairs, three well-presented bedrooms offer flexibility for families, guests, or home working, complemented by a smart bathroom. Outside, the home really shines, with a well-kept garden space featuring a seating area ideal for summer evenings. With its tasteful presentation and thoughtful design, this is a move-in-ready home that feels both stylish and homely.



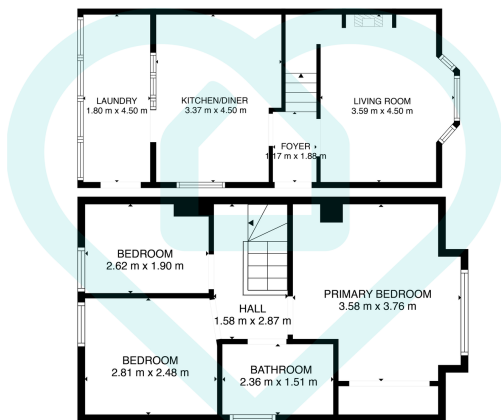

This floor plan is for illustrative purposes only. All measurements and layouts are approximations and do not necessarily capture the precise specifications of the property. No responsibility is taken for any error, omission, or misstatement. We always recommend viewing in person to confirm the exact floor plan of a property. Made with Metropix.



- Highly Sought-After Loxley Location
- Attractive Kitchen Diner
- Three Well-Proportioned Bedrooms
- Generous Outdoor Seating Area
- Close To Excellent Schools And Amenities
- Bay Window Lounge With Garden Views
- Handy Separate Utility Room
- Bright And Well-Presented Bathroom
- Low-Maintenance Garden Design
- Easy Access To City Centre & Peak District

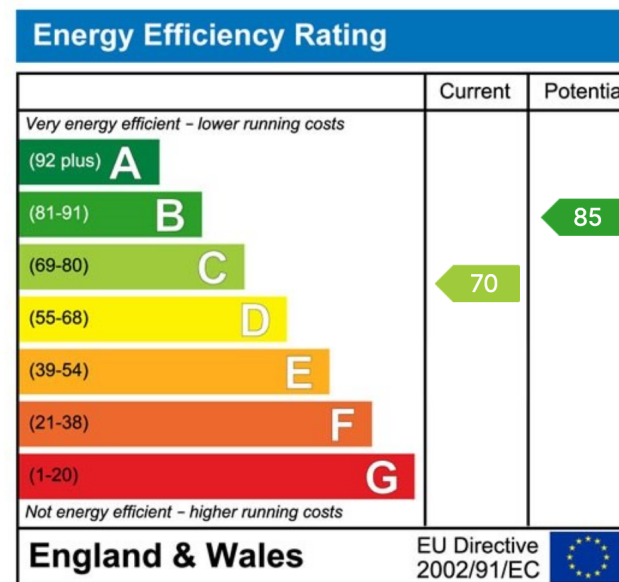

Sales | Lettings | New Homes

VAT Reg Number: 191 3588 84
Company Reg Number: 08610489
Company Reg Address: 67 Middlewood Road, Hillsborough, Sheffield, S6 4GX.

The MorfittSmith Building
67 Middlewood Road
Hillsborough
Sheffield
S6 4GX

Get in touch - arrange an appointment



0114 232 1764



sales@morfittsmith.co.uk
lettings@morfittsmith.co.uk
newhomes@morfittsmith.co.uk



www.morfittsmith.co.uk



@MorfittSmith



@MorfittSmith



MorfittSmith
Estate & Letting Agent