



Osborne Mews, Nether Edge, S11 9EG

£220,000

🛏 2 🚿 2 🛋 1



Nether Edge is one of Sheffield's most desirable and characterful districts, renowned for its leafy streets, period architecture, and strong sense of community. The area is home to a vibrant mix of independent shops, cafés, bakeries, and restaurants, particularly around Nether Edge crossroads and nearby Sharrow Vale Road, creating a village feel just minutes from the city centre. Regular farmers' markets and community events further add to its charm, making it a sought-after location for both families and professionals. Residents enjoy excellent local amenities, including well-regarded schools, parks such as Chelsea Park, and a range of recreational facilities. With its tree-lined avenues and welcoming atmosphere, Nether Edge offers the perfect blend of suburban tranquillity and urban convenience. Just a short drive from Nether Edge lies the stunning Peak District National Park, one of the UK's most treasured landscapes. Known for its rolling hills, dramatic gritstone edges, and picturesque villages, the Peak District offers endless opportunities for outdoor pursuits including walking, cycling, climbing, and scenic drives.

Tenure

Leasehold

Lease Start Date 1 Jul 2004

Lease End Date 1 Jan 2201

Lease Term 200 years from 1 January 2001

Lease Term Remaining 175 years



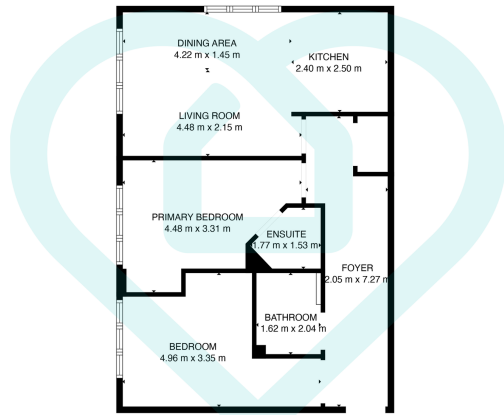

TOTAL: 65 m²
FLOOR 1: 65 m²
WALLS: 6 m²

This floor plan is for illustrative purposes only. All measurements and layouts are approximations and do not necessarily capture the precise specifications of the property. No responsibility is taken for any error, omission, or misstatement. We always recommend viewing in person to confirm the exact floor plan of a property. Made with Metropix.

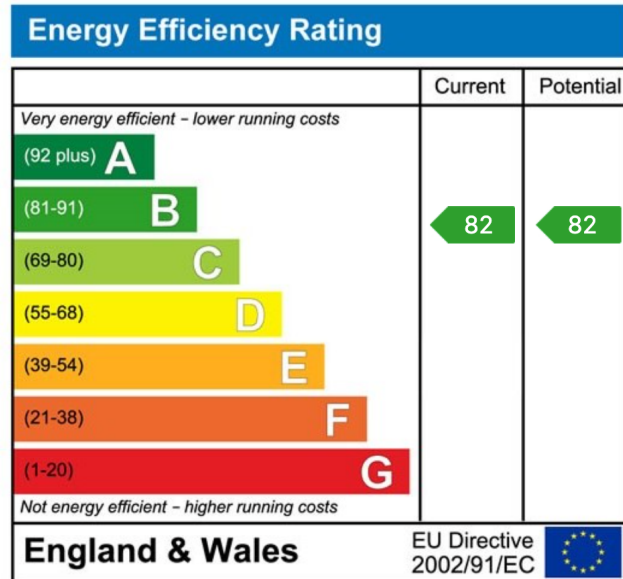

Sales | Lettings | New Homes

VAT Reg Number: 191 3588 84
 Company Reg Number: 08610489
 Company Reg Address: 67 Middlewood
 Road, Hillsborough, Sheffield, S6 4GX.

The MorfittSmith Building
 67 Middlewood Road
 Hillsborough
 Sheffield
 S6 4GX

Get in touch - arrange an appointment



0114 232 1764



sales@morfittsmith.co.uk
 lettings@morfittsmith.co.uk
 newhomes@morfittsmith.co.uk



www.morfittsmith.co.uk



@MorfittSmith



@MorfittSmith



MorfittSmith
 Estate & Letting Agent