





# Hawksley Avenue, Hillsborough, Sheffield, S6 2BD

Offers Over £170,000

3 1 2



## Why You'll Love It

Set on a sought-after street in the heart of Hillsborough, Hawksley Avenue is a traditional bay-fronted mid-terrace that blends original character with exciting potential. The home offers spacious accommodation across four levels and would be ideal for first-time buyers, renovators, or investors looking to put their stamp on a well-positioned Sheffield home.

To the front, a bright and welcoming living room benefits from high ceilings and a large bay window, filling the space with natural light. At the rear, the dining room provides a second reception area and gives access to both the cellar and the newly fitted off-shot kitchen – already updated and ready for use, saving you time and money on essential works.

On the first floor, you'll find a generous double bedroom with room for built-in storage, a single bedroom perfect for a nursery or home office, and a family bathroom with a full suite including a bathtub and overhead shower. The top floor boasts a spacious attic bedroom with a skylight, offering additional versatility as a master suite, guest room or creative space.

While the kitchen has been modernised, the rest of the property requires renovation, allowing you to reimagine and update the space exactly to your taste. With solid bones and a versatile layout, this home has the potential to become something truly special. Outside, the rear garden is a manageable and private outdoor space with plenty of scope for landscaping or entertaining. On-street permit parking is available to the front.





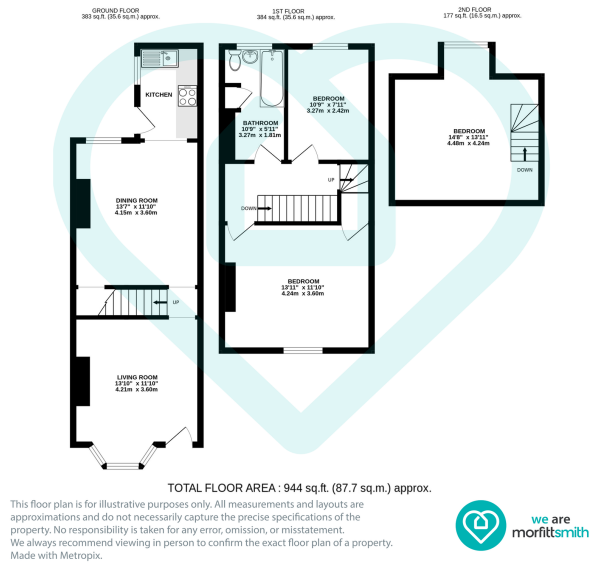

- No Chain
- Mid Terrace Home
- Some Work Is Required Throughout
- Overlooking Hillsborough Park
- Great For First Time Buyers and Investors
- Three Good Sized Bedrooms
- Private Rear Garden
- Popular Hillsborough Location
- Local Shops, Pubs and Cafes
- Permit Parking

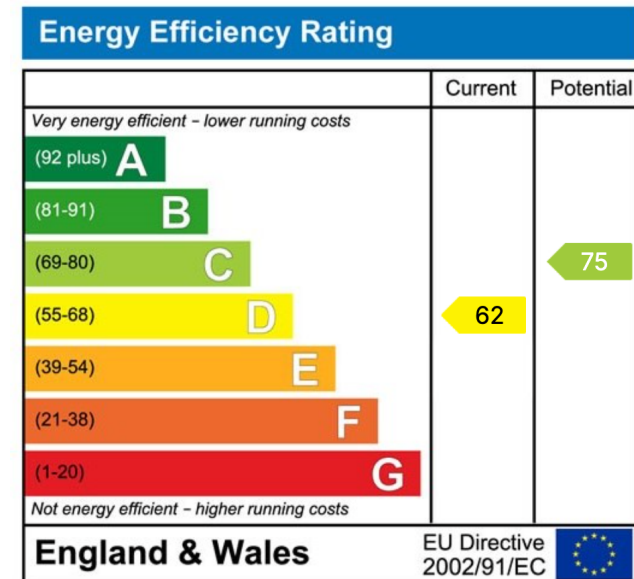

## Sales | Lettings | New Homes

VAT Reg Number: 191 3588 84  
Company Reg Number: 08610489  
Company Reg Address: 67 Middlewood Road, Hillsborough, Sheffield, S6 4GX.

The MorfittSmith Building  
67 Middlewood Road  
Hillsborough  
Sheffield  
S6 4GX

## Get in touch - arrange an appointment



0114 232 1764  
sales@morfittsmith.co.uk  
lettings@morfittsmith.co.uk  
newhomes@morfittsmith.co.uk  
www.morfittsmith.co.uk



@MorfittSmith  
@MorfittSmith  
MorfittSmith  
Estate & Letting Agent