

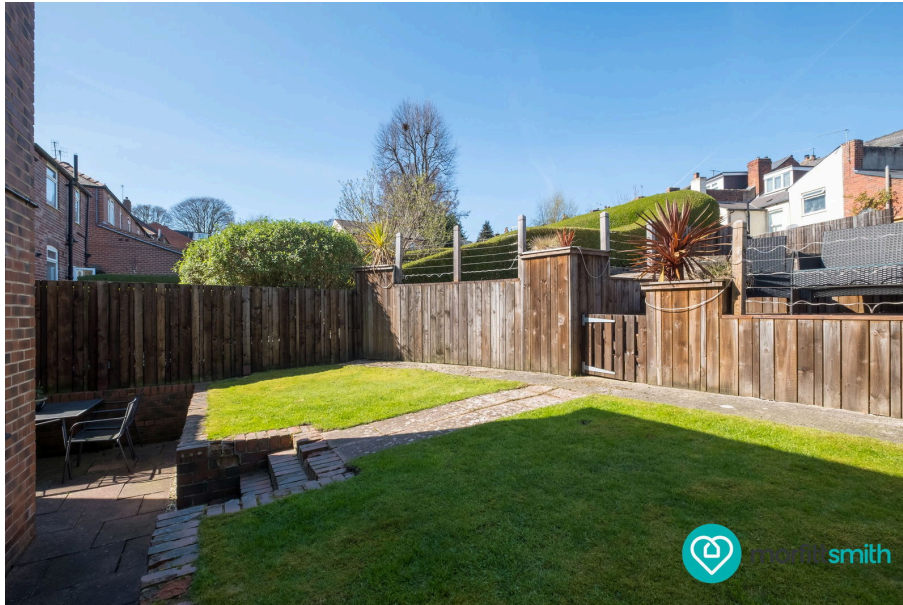

Mona Avenue, Crookes, Sheffield, S10 1NE

£360,000

4 1 2



Why You'll Love It

Nestled in the highly sought-after Crookes area of Sheffield, Mona Avenue is a wonderful example of a semi-detached home that blends space, style, and comfort. This four-bedroom property is perfect for those looking for a versatile family home with plenty of room to grow. Stepping through the front door, you're immediately welcomed into a light-filled hallway that sets the tone for the rest of the home. The spacious living room is a bright and inviting space, ideal for relaxing with family or entertaining guests. Large windows flood the room with natural light, highlighting the tasteful décor and creating a warm and welcoming atmosphere.

To the rear of the property, you'll find the kitchen and dining room extension. Designed for modern living, this space combines functionality with style, offering ample storage, sleek worktops, and space for dining. Whether you're hosting a dinner party or enjoying a quiet meal with family, this area is sure to become the heart of the home. Upstairs, the home continues to impress with four generously sized bedrooms. Each room is well-proportioned, providing comfortable accommodation for a growing family or flexible working-from-home arrangements. The family bathroom is tastefully designed and features all the essentials for convenience and comfort.

Outside, the rear garden offers a private and peaceful retreat, perfect for outdoor dining, gardening, or simply unwinding after a long day. The addition of a garage provides valuable storage space and secure parking.

*Agent Disclosure: The vendors' are know to a staff member at Morfitt Smith Estate Agents.

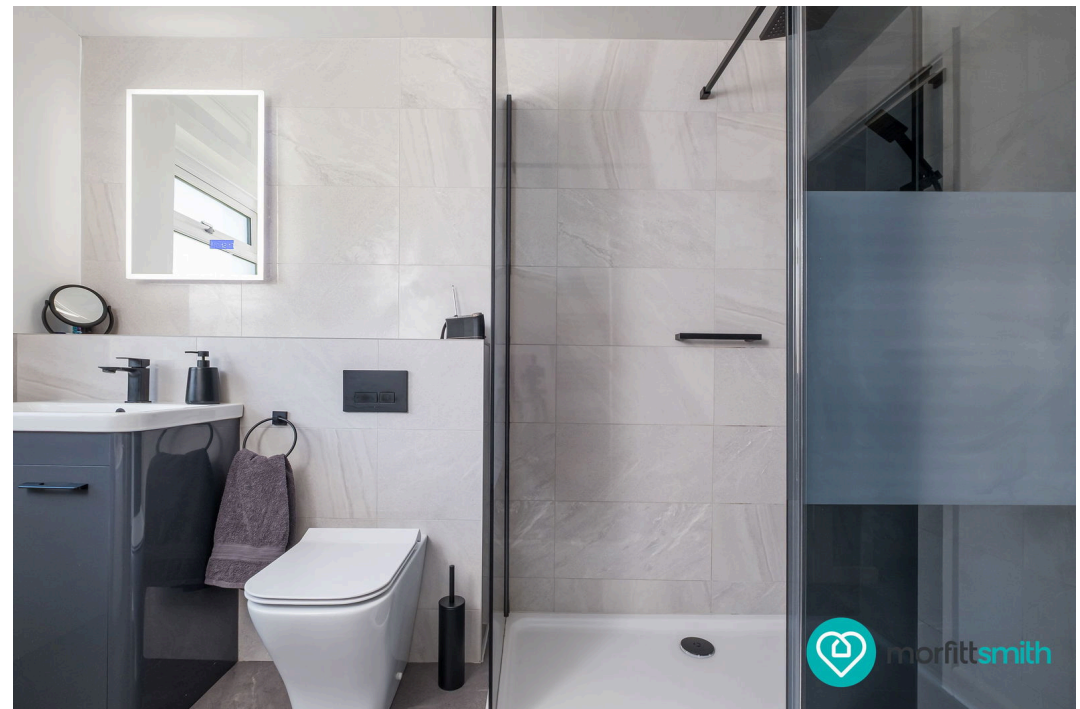

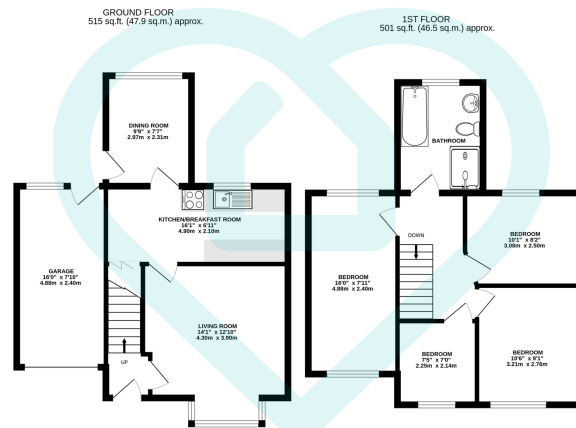

TOTAL FLOOR AREA: 1016 sq.ft. (94.4 sq.m.) approx.

This floor plan is for illustrative purposes only. All measurements and layouts are approximations and do not necessarily capture the precise specifications of the property. No responsibility is taken for any error, omission, or misstatement. We always recommend viewing in person to confirm the exact floor plan of a property. Made with Metropix.



- Semi Detached Home
- Four Good Sized Bedrooms
- Extended Home
- Well Presented Throughout
- Off Road Parking
- Rear Garden
- Garage
- Popular Crookes Location
- Close To Shops, Pubs and Cafe's
- Great Transport Links Into The City

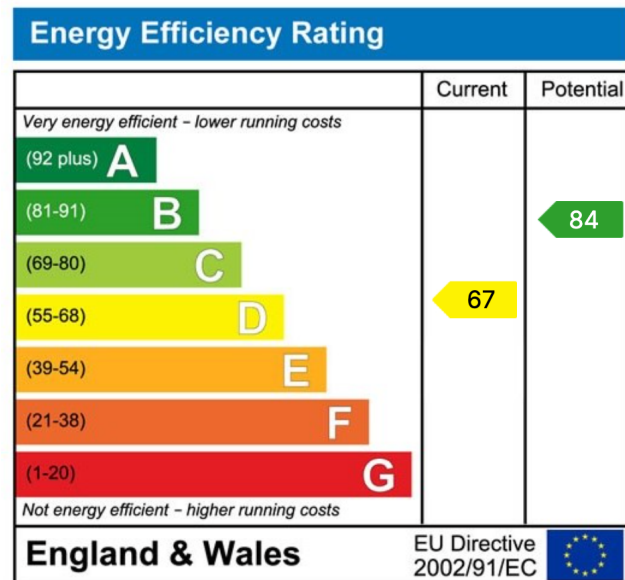

Sales | Lettings | New Homes

VAT Reg Number: 191 3588 84
 Company Reg Number: 08610489
 Company Reg Address: 67 Middlewood Road, Hillsborough, Sheffield, S6 4GX.

The MorfittSmith Building
 67 Middlewood Road
 Hillsborough
 Sheffield
 S6 4GX

Get in touch - arrange an appointment



0114 232 1764



sales@morfittsmith.co.uk
 lettings@morfittsmith.co.uk
 newhomes@morfittsmith.co.uk



www.morfittsmith.co.uk



@MorfittSmith



@MorfittSmith



MorfittSmith
 Estate & Letting Agent