



Brookview Court, Dronfield, S18 2HT

£165,000

1 1 1



Entrance Hall

Welcoming and well-proportioned, the entrance hall provides access to all accommodation, setting the tone for this inviting home.

Delightful Lounge

A bright and airy space, perfect for relaxation. With ample natural light and tasteful decor, this lounge offers a warm and comfortable environment for entertaining or unwinding after a busy day.

Dining Kitchen

A well-appointed kitchen with ample space for dining, featuring a range of fitted units, work surfaces, and modern appliances. The layout is designed for both practicality and style, making it an ideal space for preparing and enjoying meals.

Bedroom

A generously sized bedroom offering a peaceful retreat, complete with plenty of room for storage and furnishings to create a personalised sanctuary.

Shower Room/W.C.

A modern and stylish shower room comprising a walk-in shower, wash basin, and W.C., finished to a high standard with contemporary fittings.

Exterior & Gardens

The property benefits from beautifully maintained communal lawned gardens, providing a serene setting with sitting-out areas to enjoy the outdoors. Additionally, private parking spaces are available, ensuring convenient and secure parking for residents. The grounds command a pleasant aspect, offering a delightful blend of natural beauty and practical living.

With its enviable location, excellent transport connections, and superb accommodation, this charming property is a wonderful choice for those seeking a peaceful yet well-connected home in Dronfield. Early viewing is highly recommended. This is a retirement property for the over 55's situated on the grounds of the nursing home



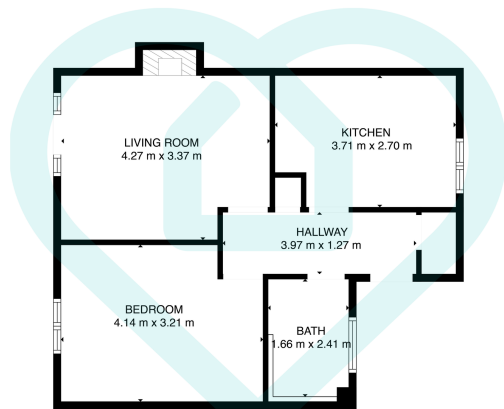

TOTAL: 49 m²
GROUND FLOOR: 49 m²
EXCLUDED AREAS: FIREPLACE: 1 m²

This floor plan is for illustrative purposes only. All measurements and layouts are approximations and do not necessarily capture the precise specifications of the property. No responsibility is taken for any error, omission, or misstatement. We always recommend viewing in person to confirm the exact floor plan of a property. Made with Metropix.



- This is a retirement property for the over 55's situated on the grounds of the nursing home.
- Bright and spacious lounge, ideal for relaxation and entertaining.
- Generously sized bedroom, providing a peaceful retreat.
- Well-maintained communal gardens, perfect for outdoor enjoyment.
- Close to local amenities, shops, restaurants, and leisure facilities.
- Excellent transport links, including easy access to the M1 motorway.
- Modern dining kitchen with fitted units and ample workspace.
- Stylish shower room/W.C., finished with contemporary fittings.
- Private parking spaces, ensuring convenience for residents.
- Early viewing recommended, as demand for this property is high.

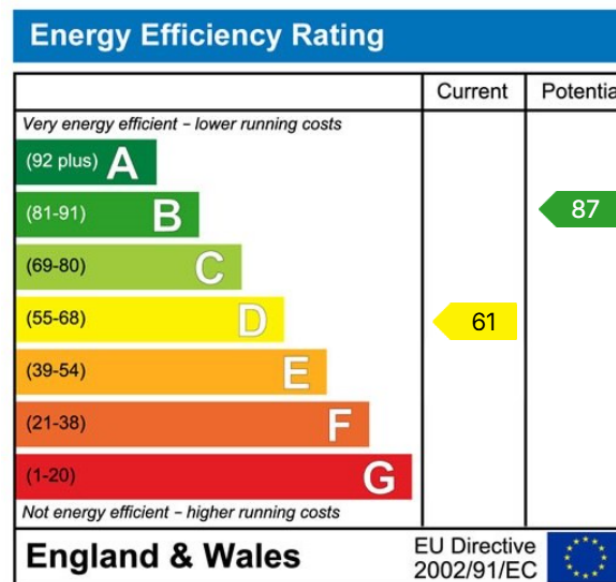

Sales | Lettings | New Homes

VAT Reg Number: 191 3588 84
Company Reg Number: 08610489
Company Reg Address: 67 Middlewood Road, Hillsborough, Sheffield, S6 4GX.

The MorfittSmith Building
67 Middlewood Road
Hillsborough
Sheffield
S6 4GX

Get in touch - arrange an appointment



0114 232 1764



sales@morfittsmith.co.uk
lettings@morfittsmith.co.uk
newhomes@morfittsmith.co.uk



www.morfittsmith.co.uk



@MorfittSmith



@MorfittSmith



MorfittSmith
Estate & Letting Agent