





## Brookview Court, Dronfield, S18 2HT

£165,000

🛏 1 🚿 1 🛋 1

- Prime location in the desirable district of Dronfield.
- Bright and spacious lounge, ideal for relaxation and entertaining.
- Generously sized bedroom, providing a peaceful retreat.
- Well-maintained communal gardens, perfect for outdoor enjoyment.
- Close to local amenities, shops, restaurants, and leisure facilities.
- Excellent transport links, including easy access to the M1 motorway.
- Modern dining kitchen with fitted units and ample workspace.
- Stylish shower room/W.C., finished with contemporary fittings.
- Private parking spaces, ensuring convenience for residents.
- Early viewing recommended, as demand for this property is high.



Nestled in the charming and highly sought-after district of Dronfield, this beautifully presented one-bedroom apartment offers a fantastic opportunity for those seeking comfort, convenience, and accessibility. Dronfield, a thriving town positioned between Sheffield and Chesterfield, is well known for its excellent amenities, strong sense of community, and superb transport links. With easy access to the M1 motorway, this location is perfect for commuters while also enjoying the tranquillity of its picturesque surroundings.







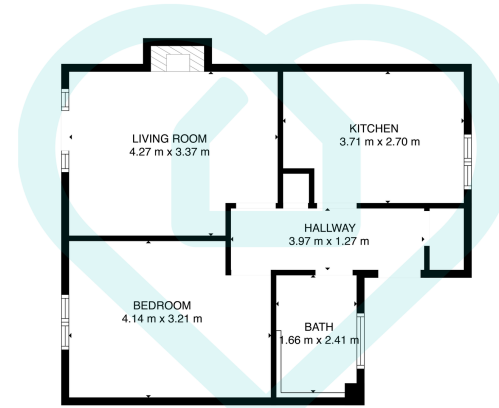

TOTAL: 49 m<sup>2</sup>  
GROUND FLOOR: 49 m<sup>2</sup>  
EXCLUDED AREAS: FIREPLACE: 1 m<sup>2</sup>

This floor plan is for illustrative purposes only. All measurements and layouts are approximations and do not necessarily capture the precise specifications of the property. No responsibility is taken for any error, omission, or misstatement. We always recommend viewing in person to confirm the exact floor plan of a property. Made with Metropix.



## Sales | Lettings | New Homes

VAT Reg Number: 191 3588 84  
Company Reg Number: 08610489  
Company Reg Address: 67 Middlewood  
Road, Hillsborough, Sheffield, S6 4GX.

The MorfittSmith Building  
67 Middlewood Road  
Hillsborough  
Sheffield  
S6 4GX

## Get in touch - arrange an appointment



0114 232 1764



[sales@morfittsmith.co.uk](mailto:sales@morfittsmith.co.uk)  
[lettings@morfittsmith.co.uk](mailto:lettings@morfittsmith.co.uk)  
[newhomes@morfittsmith.co.uk](mailto:newhomes@morfittsmith.co.uk)



[www.morfittsmith.co.uk](http://www.morfittsmith.co.uk)



@MorfittSmith



@MorfittSmith



MorfittSmith  
Estate & Letting Agent