



Cherry Wood Way, Waverley, S60 8BX

£320,000

🛏 4 🚿 2 🛋 1



Why We Love It

Waverley combines the best of community and convenience. Known for its welcoming atmosphere, this location offers excellent local amenities, access to reputable schools, and swift commuter links to nearby Rotherham and Sheffield. With lovely green spaces, local shops, and a vibrant neighborhood feel, it's an ideal spot for families and professionals alike.

Why You'll Love It

Designed to maximize space and light, this home's open-plan kitchen/lounge is perfect for family gatherings and cosy evenings alike, boasting generous WC and separate utility space, with doors leading directly into a beautifully kept garden – ideal for summer entertaining or relaxing with a book.

Upstairs, the first floor offers two spacious double bedrooms, including a main bedroom with built-in wardrobes and an elegant ensuite. The second floor provides two additional double bedrooms with handy built-in storage, ensuring plenty of room for everyone, while the family bathroom completes this versatile layout, making this home ready to enjoy from day one.



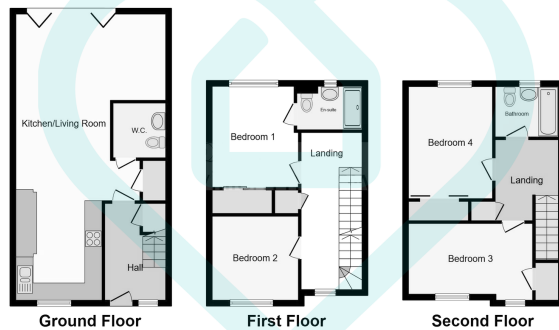

This floor plan is for illustrative purposes only. All measurements and layouts are approximations and do not necessarily capture the precise specifications of the property. No responsibility is taken for any error, omission, or misstatement. We always recommend viewing in person to confirm the exact floor plan of a property. Made with Metropix.



- Spacious Open-Plan Kitchen/ Lounge
- Doors to Rear Garden
- Generous Private Rear Garden
- Bright and Airy Entrance Hallway
- Ensuite to Main Bedroom
- Well-Appointed Family Bathroom
- Convenient Transport Links to Rotherham and Sheffield
- Desirable Waverley Location with Community Feel
- Excellent Local Schools Nearby
- Driveway with Off-Road Parking

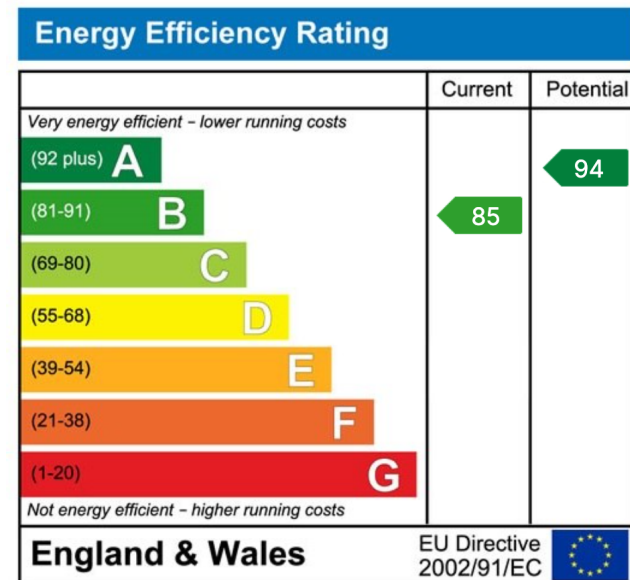

Sales | Lettings | New Homes

VAT Reg Number: 191 3588 84
Company Reg Number: 08610489
Company Reg Address: 67 Middlewood Road, Hillsborough, Sheffield, S6 4GX.

The MorfittSmith Building
67 Middlewood Road
Hillsborough
Sheffield
S6 4GX

Get in touch - arrange an appointment



0114 232 1764



sales@morfittsmith.co.uk
lettings@morfittsmith.co.uk
newhomes@morfittsmith.co.uk



www.morfittsmith.co.uk



@MorfittSmith



@MorfittSmith



MorfittSmith
Estate & Letting Agent