





Belvedere Parade, Bramley, Rotherham, S66 3RN

£180,000

 3  1  1

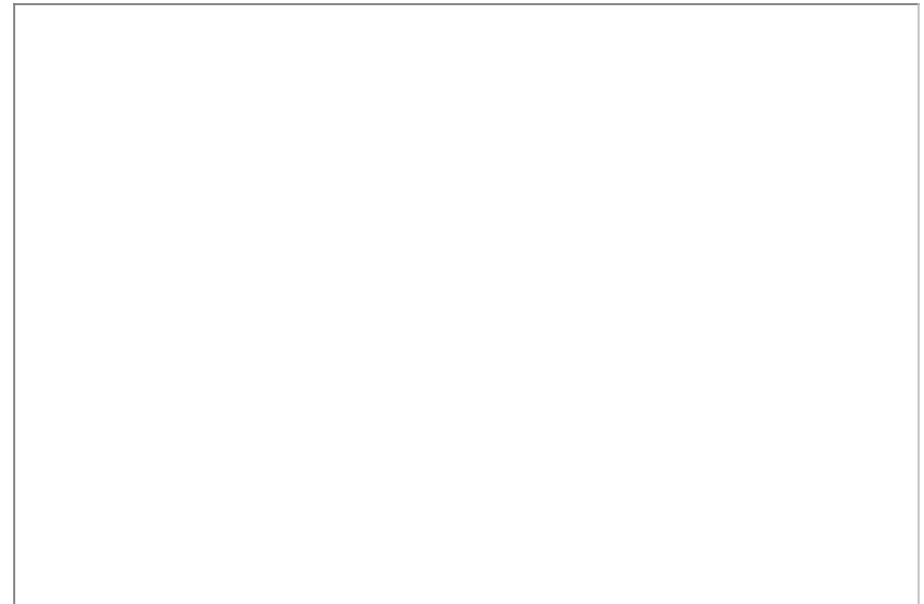
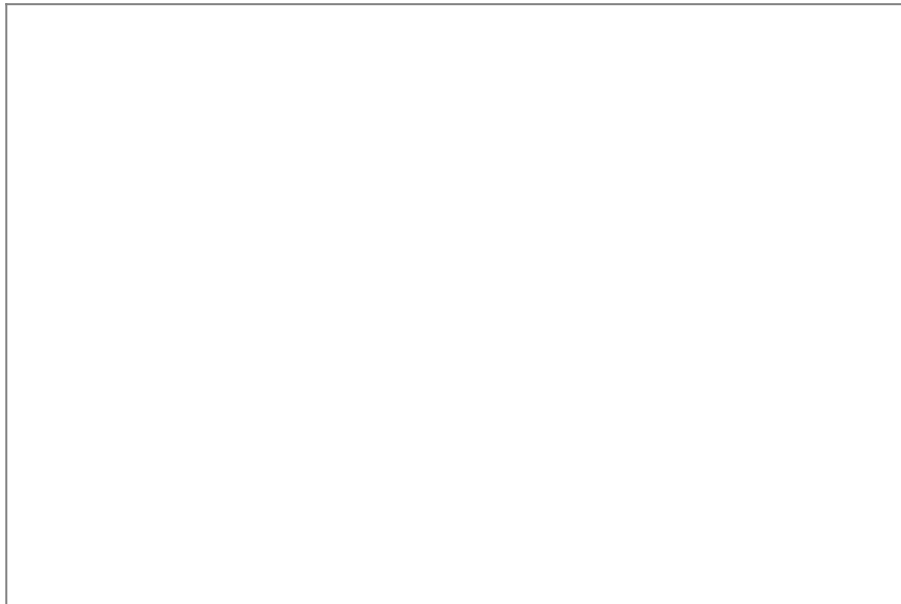

Welcome to this delightful three-bedroom family home, situated in the sought-after area of Bramley, Rotherham. This property boasts a well-designed layout perfect for modern living. Upon entering, you're greeted by a charming entrance porch leading into a spacious entrance lobby with stairs ascending to the first floor. The bright and inviting front-facing lounge offers a comfortable space to relax, while the well-appointed fitted dining kitchen provides ample room for both cooking and dining. From here, you'll have direct access to the conservatory, a lovely spot to enjoy the garden views.

Upstairs, the first-floor landing leads to three generously sized bedrooms, and a family bathroom with a WC. Outside, the property features attractive gardens to both the front and rear, ideal for outdoor entertaining or relaxation. A long driveway offers ample parking, leading to a detached garage for additional storage or parking needs.

Located in the desirable district of Bramley, this home benefits from excellent local amenities, including shops, cafes, and schools. Bramley offers a great balance of suburban living with easy access to nearby Rotherham and Sheffield, as well as convenient transport links, including the M18 and M1 motorways, making it perfect for commuters. With its community feel, green spaces, and proximity to major towns, Bramley is an ideal location for families and professionals alike.

Don't miss the opportunity to make this fantastic house your home in one of Rotherham's most sought-after areas!

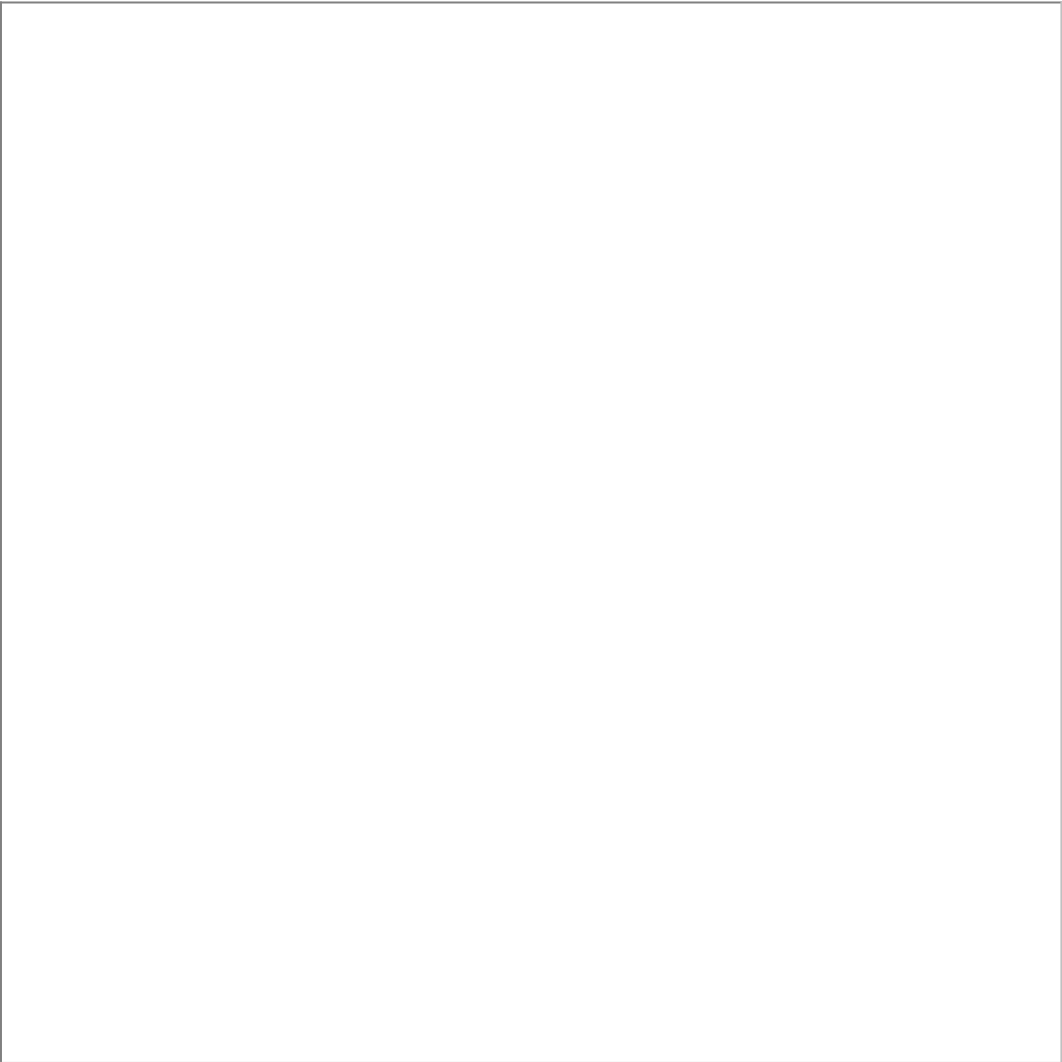

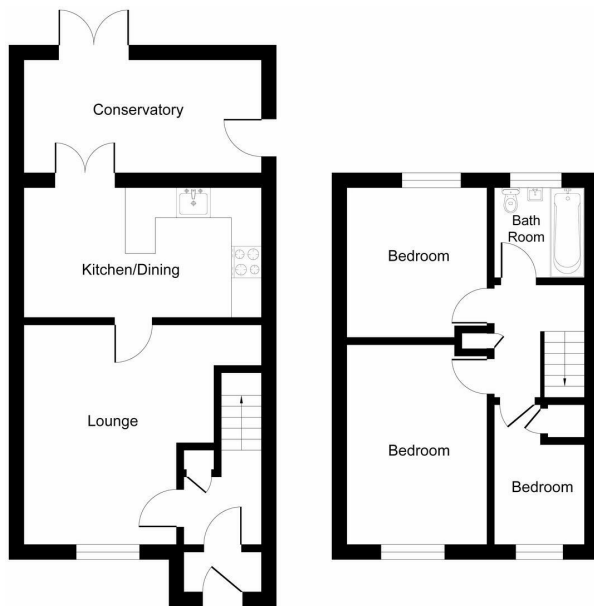

- An excellent three bedroom semi-detached property
- Gas central heating and double glazing
- Driveway and garage
- Ideal for the commuter for the motorway network
- Having an excellent upvc double glazed conservatory
- Three good sized bedrooms and a bathroom/w.c.
- Located in the popular district of Bramley
- The vendor has already secured an onwards purchase

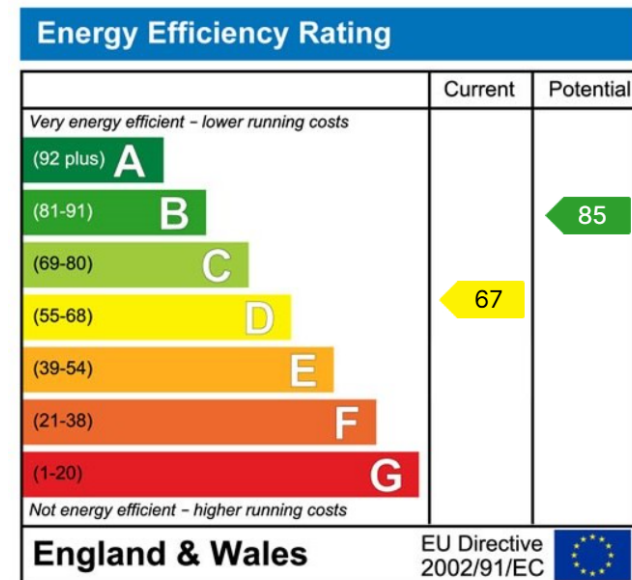
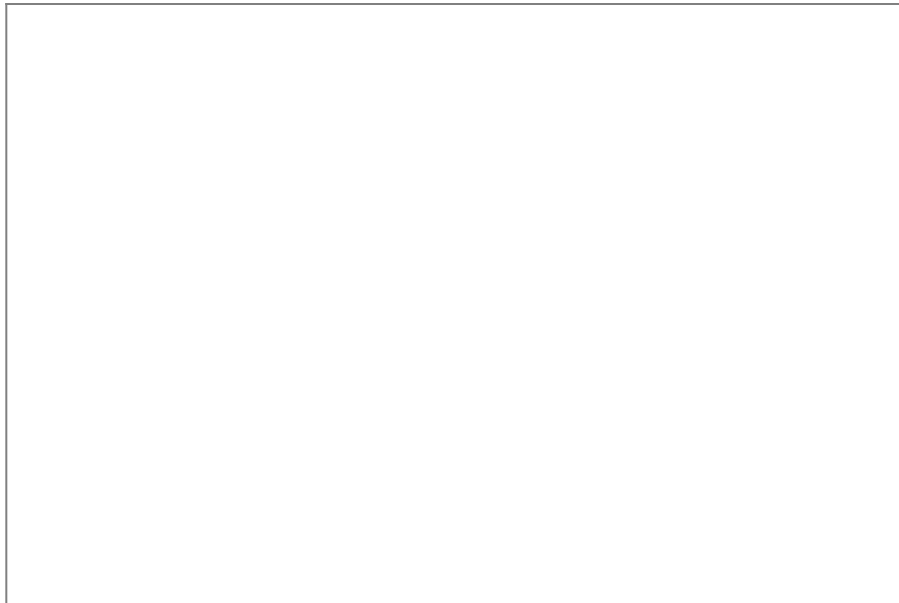

Sales | Lettings | New Homes

VAT Reg Number: 191 3588 84
 Company Reg Number: 08610489
 Company Reg Address: 67 Middlewood
 Road, Hillsborough, Sheffield, S6 4GX.

The MorfittSmith Building
 67 Middlewood Road
 Hillsborough
 Sheffield
 S6 4GX

Get in touch - arrange an appointment

 0114 232 1764
 sales@morfittsmith.co.uk
 lettings@morfittsmith.co.uk
 newhomes@morfittsmith.co.uk
 www.morfittsmith.co.uk

 @MorfittSmith
 @MorfittSmith
 MorfittSmith
 Estate & Letting Agent