



Wadsley Park Crescent, Wadsley, S6 4BX

Offers Over £400,000

🛏️ 4 🚿 2 🛋️ 2



Why We Love It

This well-appointed house is nestled in a quiet crescent of family homes within the leafy streets of Wadsley. Located just a short distance from Hillsborough and Middlewood, Wadsley Park Crescent is conveniently close to local shops, schools, parks, and other amenities, with excellent transport links nearby.

Why You'll Love It

More than just a great location, Wadsley Park Crescent is a solid family home with plenty to offer. The ground floor includes a separate porch and hallway, a downstairs WC, a bright living room with a bay window, and a dining room with garden views, leading to a stunning kitchen.

Upstairs, you'll find three spacious double bedrooms and a full family bathroom, with the master bedroom featuring a generously sized en-suite shower room. The converted attic offers a bright and expansive fourth double bedroom, providing plenty of additional living space.

The home is impeccably decorated throughout, creating a vibrant and welcoming atmosphere, perfect for both family life and entertaining.

The property offers privacy with tall hedges and rear access to a beautifully maintained garden, featuring a lower patio with ample seating space, deep flowerbeds, mature trees, and a raised lawn. The garden also includes a hidden gem which is a potential home office currently used as storage by the current owners. It could be perfect for working from home while enjoying the outdoors. The property also benefits from a driveway and an attached garage.



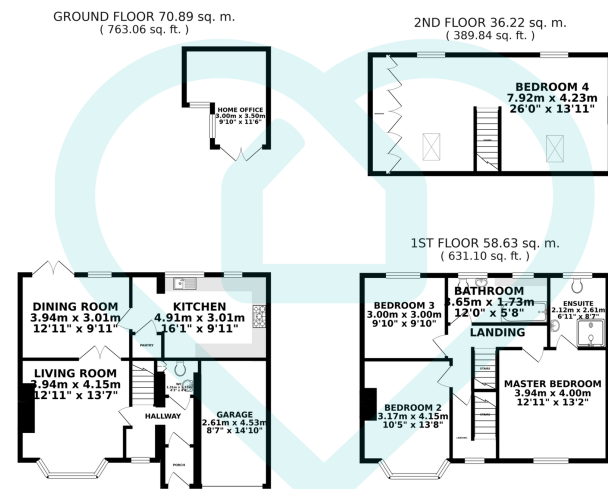

TOTAL FLOOR AREA: 165.74 sq. m. (1784.00 sq. ft.) approx.

Whilst every attempt has been made to ensure the accuracy of the floor plan contained here, measurements of doors, windows, rooms and any other items are approximate and no responsibility is taken for any error, omission or mis-statement. This plan is for illustrative purposes only and should be used as such by any prospective tenant/ purchaser.

Made with Metropix Estate & Letting Agent

- Quiet Crescent Location
- Tall Hedges for Privacy
- Proximity to Hillsborough and Middlewood
- Convenient Access to Local Shops, Schools, and Parks
- Driveway and Garage
- Bright Bay-Windowed Living Room
- Garden-View Dining Room
- Long Galley Kitchen
- Converted Attic Bedroom
- Beautifully Presented

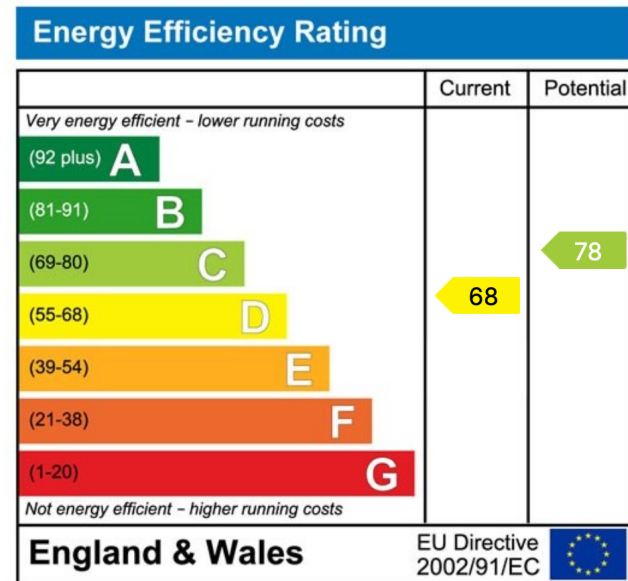

Sales | Lettings | New Homes

VAT Reg Number: 191 3588 84
 Company Reg Number: 08610489
 Company Reg Address: 67 Middlewood Road, Hillsborough, Sheffield, S6 4GX.

The MorfittSmith Building
 67 Middlewood Road
 Hillsborough
 Sheffield
 S6 4GX

Get in touch - arrange an appointment

0114 232 1764
 sales@morfittsmith.co.uk
 lettings@morfittsmith.co.uk
 newhomes@morfittsmith.co.uk
 www.morfittsmith.co.uk

@MorfittSmith
 @MorfittSmith
 MorfittSmith Estate & Letting Agent